



We exist to provide outstanding opportunities through recreation for children and adults with disabilities.

Date: July 19, 2017
To: Bus Dealers
From: Barb Bassett, Operations Coordinator
Re: Purchase of One (1) 2018 14 Passenger Paratransit Shuttle Bus

Please find the enclosed bid specifications for the purchase of one (1) 2018 14 Passenger Paratransit Shuttle Bus. The bid documents are also accessible at www.nwsra.org/bid.

To submit a bid, please have the proper officer from your company complete the enclosed "Bid Proposal Form" and "Bid Compliance Form." These forms should be signed in ink, placed in a sealed envelope marked "Vehicle Bid/Paratransit Shuttle Bus" and submitted no later than 10:00 a.m. on Friday, August 18, 2017. All bids received will remain sealed and opened at this time. You are welcome, but not required to attend the bid opening. The company receiving the bid will be contacted by phone following approval by the Northwest Special Recreation Board. The Northwest Special Recreation Association may reject any and all bids on any basis without disclosure of a reason. The failure to make such a disclosure shall not result in the occurrence of any right, claim or cause of action by any unsuccessful bidders against the Northwest Special Recreation Association.

An extension of the local park districts serving

Arlington Heights • Bartlett • Buffalo Grove • Elk Grove • Hanover Park • Hoffman Estates • Inverness • Mount Prospect
Palatine • Prospect Heights • River Trails • Rolling Meadows • Salt Creek • Schaumburg • South Barrington • Streamwood • Wheeling

3000 West Central Road, Suite 205 • Rolling Meadows, IL 60008 • VOICE 847/392-2848 • FAX 392-2870 • TTY 392-2855 • www.nwsra.org

RETURN WITH YOUR BID RESPONSE

NORTHWEST SPECIAL RECREATION ASSOCIATION

Vehicle Bid Proposal Form

The Undersigned Bus Dealer declares that he/she has carefully examined the attached vehicle specifications, and has made such investigations that are deemed necessary to determine the nature of the resources required to construct this vehicle. He/she agrees that should this proposal be accepted, he/she will execute and enter into a contract with the Board of Trustees of the Northwest Special Recreation Association to construct and deliver to the Northwest Special Recreation Association for the vehicle set forth in the specifications for a 14 passenger or 0 passenger and 6 wheelchair position shuttle bus. The Northwest Special Recreation Association may reject any and all bids on any basis without disclosure of a reason. The failure to make such a disclosure shall not result in the occurrence of any right, claim or cause of action by any unsuccessful bidders against the Northwest Special Recreation Association.

1. GVWR _____
2. Engine _____
3. Transmission _____
4. Tires: Size _____ Longevity _____
5. Dual Rear Tires _____
6. Air Conditioning: Front BTU's _____ Rear BTU's _____
7. Brakes: _____ Front Type _____ Rear Type _____ ABS _____
8. Fuel Tank Location: _____ Capacity _____
9. Rust Proofing _____
10. Battery System _____
11. Radio _____
12. Heating _____ BTU's _____
13. Floor Structure _____
14. Vehicle Body _____
15. Seating Capacity _____
16. Flip Seats/Fold Away Seats _____
17. Stanchions and Hand Rails _____
18. Wheelchair Lift _____
19. Roof Vents _____
20. Lift Doors _____
21. Passenger Interior Doors _____
22. Windows and Emergency Exits _____
23. Mirrors _____
24. Lighting _____
25. Drivers Console _____
26. Seat Material: Driver _____ Passenger _____
27. Reversing Proximity Sensor _____

Warranty on Chassis: Whom: _____

How Long: _____ Years _____ Miles

Warranty of Exterior Body: Whom: _____

How Long: _____ Years _____ Miles

Warranty on Interior Modifications: Whom: _____

How Long: _____ Years _____ Miles

Warranty on Engine/Drive Train: Whom: _____

How Long: _____ Years _____ Miles

Warranty on Rust Proofing: Whom: _____

How Long: _____ Years _____ Miles

Warranty on Wheelchair Lift: Whom: _____

How Long: _____ Years _____ Miles

Deliver to Northwest Special Recreation Association by December 15, 2017.

Name on Title: Northwest Special Recreation Association

Cost of Vehicle \$ _____

Additional Charges: \$ _____
(i.e., delivery, license, etc.)

Total Cost: \$ _____

Price includes all applicable rebates and may require assignment by purchaser.

Company Name Address

Authorized by (Please Print) Date Phone

Authorized Signature

Please mail to: Barb Bassett
Operations Coordinator
3000 W. Central Road, Suite 205
Rolling Meadows, IL 60008

**NORTHWEST SPECIAL RECREATION ASSOCIATION
3000 W. Central Road, Suite 205, Rolling Meadows, IL 60008
847/392-2848 * 392-2855 TTY * 392-2870 Fax**

SPECIFICATION FOR:

**2018 Paratransit Shuttle Bus
Fourteen Passengers or Zero Passengers and Six Wheelchair Positions**

Scope

It is the intention of this specification to describe a vehicle of substantial and durable construction in all respects.

General

This specification is written around specific needs of this agency. With the intent to standardize certain components, therefore, in numerous places we have named specific brands of components. This has been done to establish a certain standard of quality. Other brands will be considered providing the vendor provides documentation clearly describing any variations to the bid specifications. Such request must meet or exceed the specifications called for in this bid document. The determination of NWSRA regarding any such request as far as accepting or denying said request, will be final.

Materials

All materials used in conversion of the bus shall conform in all respects to American Society of Testing Materials, Society of Automotive Engineers or similar association standards.

Capacity

Vehicle must be able to accommodate the following loads.

1. With no wheelchairs on board, 14 seated passengers plus the driver.
2. Up to 6 wheelchairs and 0 seated passengers plus the driver.

Note: Unit must not require a CDL license to operate.

It is the intent of the NWSRA to purchase one unit that meets the following specifications and requirements.

Deviations from specifications must contain a detailed description addressing variances and documentation to support reason why alternate should be considered as equal.

RETURN WITH YOUR BID RESPONSE

Bid Compliance Form

**SPECIFICATION FOR
Fourteen Passengers or Zero Passengers and Six Wheelchair Positions
Gas Powered Shuttle Bus**

1. Scope and Classification

It is the intent of this specification to describe the requirements for the purchase of one (1) fourteen passengers or zero passengers and six wheelchair bus with six forward facing double foldaway seats and two forward facing single flip seats. **The vehicle is not to exceed CDL requirements.**

2. Requirements

THE COMPLIANCE SPACE MUST BE COMPLETED THROUGHTLY AND ACCURATELY. IF VENDOR CHECKS "NO" TO MEETING ANY OF THE SPECIFICATIONS, THEY MUST INCLUDE A WRITTEN EXPLANATION AND ATTACH IT TO THE BID.

3. Dimensions:

Bid Compliance: Yes ___ No ___

Overall exterior length:	24' minimum
Overall Exterior width (ex. mirrors):	96" maximum
Overall height:	114" minimum
Interior Height:	78" minimum
Interior width	92" minimum
Aisle width:	18" minimum
Ground to first step:	12.5" maximum
Step Width	34" minimum
Step Riser	8" minimum
Step Tread	12" minimum

4. Chassis

Bid Compliance: Yes ___ No ___

1. Chassis with a 176-inch minimum wheelbase and a 4.56 to 1 rear axle ratio.
2. E450 Super Duty Chassis
3. Axle ratings: Front 4,600# minimum - Rear 9,450# minimum
4. G.V.W.R. - 14,500# minimum
5. Two (2) heavy-duty drive shaft guards.
6. Mud flaps front and rear.
7. Heavy duty front and rear shock absorbers.
8. Galvanized steel wheel wells.
9. Front chrome bumper, rear bumper powder coated steel with wrap around corners and chrome grille.

10. Exterior rub rails.
11. Dual electric horns.
12. Front and rear stabilizer bars.
13. Headlights with audible alert.
14. Front End alignment after body is assembled.
15. 55 gallon minimum fuel tank.

5. Engine **Bid Compliance: Yes** ___ **No** ___

1. Gas powered 6.8L V-10
2. 225 amp alternator minimum
3. Dual heavy-duty batteries.
4. High/Fast idle control with Interlock and complete display.
5. Engine alarm/shutdown.

6. Transmission **Bid Compliance: Yes** ___ **No** ___

1. 5-Speed electronic, automatic torque shift transmission with overdrive.

7. Brakes **Bid Compliance: Yes** ___ **No** ___

1. Power Disc Front and Rear with 4 wheel ABS.

8. Wheel/Tires **Bid Compliance: Yes** ___ **No** ___

1. Six truck type steel belted, black sidewall all season radial tires.
2. Dual rear wheels.

9. Steering **Bid Compliance: Yes** ___ **No** ___

1. Power steering with tilt steering wheel and cruise control.

10. Instruments **Bid Compliance: Yes** ___ **No** ___

1. Console cannot be mounted in overhead panels above windshield or driver's door.
2. Electronic speedometer, fuel gauge, oil pressure gauge, voltmeter, trip odometer, coolant temperature, high beam indicator, directional signals, and twelve volt power point on dash.

11. Heater/Air Conditioning **Bid Compliance: Yes** ___ **No** ___

1. Air conditioning: Dash and rear carrier with a minimum of 70,000 BTU with a dual compressor system.
2. Two heaters that are a minimum of 35,000 BTU each that includes a shut off valve. Mounted in rear of vehicle and control heaters on separate switches.

12. Interior Features

Bid Compliance: Yes___ **No**___

1. Interior width of 92" and 78" interior height.
2. Aisle width 18"
3. Straight sidewalls for maximum passenger seating comfort.
4. 1 1/2" grab rail parallel to entrance steps on both sides. Walker Style.
5. Stanchion and modesty panel driver's side.
6. 5/8" pressure treated MarineTech plywood flooring
7. Grey Koroseal floor under seating area with ribbed center aisle and steps. Steps to have step treads with yellow or white nosing and galvanized stainless steel stepwell.
8. Yellow or White Standee Line and Standee signage.
9. Track seating.
10. Stainless steel stanchion curb side
11. Modesty panel curb side.
12. Interior mirror – 6"x16"
13. Main electrical switch panel with auto reset circuit breakers.
14. Color-coded wiring harness in split loom.
15. Step well entry door light and driver's dome light.
16. Minimum two LED interior isle lights 14"x3".
17. Interior lights to be door activated.
18. AM/FM/CD player - dash mounted.
19. Minimum four speakers.
20. Braun wheelchair lift that meets all ADA and FMVSS requirements to be installed in the rear of the bus. Lift shall be mounted on the right side rear of the vehicle.
21. Lift shall be equipped with a transmission/parking brake interlock that prohibits vehicle from moving if lift doors are open.
Double lift doors. Each door panel shall have a window.
Lift doors shall meet the minimum requirements of ADA regarding clear opening height and width as it applies to buses in excess of 22 feet.
22. Wheelchair QRT Deluxe retractable securements for "L" tracks shall be provided. Tie downs for Six (6) wheelchairs shall be provided for a total of 24 tie downs (Q-Straint Q-8100-A1-L). These securement systems must meet all ADA requirements.
23. "L" Track floor mounting.
24. Interior of the bus shall include a flat floor.
25. Front overhead storage compartment with 2 thumb latches that do not require a key to open.
26. Six (6) Q-Straint mesh storage pouches. One (1) pouch for each set of four (4) tie downs.
Total of six (6).

13. Seating

Bid Compliance: Yes___ **No**___

1. Track Seating
2. OEM driver's seat shall be covered in level #5 upholstery.
3. Two (2) Freedman passenger seating - 17" Mid-High Single Flip seats – Level #5 fabric.
4. Six (6) Freedman passenger seating - 34" Double Forward Facing Foldaway seats – Level #5 fabric.
5. The seats shall be covered in level #5 upholstery. Color to be determined by NWSRA.
6. Fourteen (14) - 74" manual - non-retractable standard size seat belts shall be provided.

14. Exterior Body

Bid Compliance: Yes___ **No**___

1. Body must meet all FMVSS requirements. Documentation must be included with bid.
2. Aerodynamic fiberglass front cap.
3. 5 piece ABS rear cap
4. Steel cage construction.
5. Fiberglass composite roof. Roof shall be seamless and one piece.
6. Single piece vacuum-laminated structural panel assembly including steel frame, dense foam insulation, Galvanneal steel exterior and grey vinyl-coated Lauan interior panels.
7. Fully Galvanized steel all structure frame and floor frame.
8. Galvanized steel stepwell.
9. Double T slider windows, rear glass window and side upper double T slider egress windows. All windows with climate control tint.
10. Full view curb window.
11. Exhaust routed to rear behind rear wheels on the street side.
12. Side mounted exterior flat mirrors with convex mirror.
13. Insulation in sidewalls, rear wall and roof.
14. Galvanized steel wheel wells. Stainless steel wheel inserts and covers.
15. Chrome Grille
16. Exterior lights to be sealed and to include front marker lights, rear marker lights, rear brake, front turn signal, rear turn signal, rear license plate light, back-up lights and rear center brake light.
17. Drip rail over side windows and doors.
18. Metal belly pan.
12. Electric 30" passenger door with external key switch.
13. Rubber splash flares on rear wheel wells.
14. Head Lamps to be Halogen Aero headlamps
15. LED exterior lighting package

15. Color & Graphics Package

Bid Compliance: Yes___ **No**___

1. Exterior color white.
2. Graphics and Lettering per NWSRA specifications.

16. Accessories

Bid Compliance: Yes___ **No**___

1. Signal vinyl sun visors,
2. Driver's side air bag
3. Tilt steering wheel
4. 25 unit minimum unit first aid kit
5. 10 lb. fire extinguisher
6. Triangular reflector kit
7. Reverse alarm
8. Intermittent windshield wipers
9. Fresnal lens, 11"x14"
10. Reversing Proximity Sensor

17. Rustproofing **Bid Compliance: Yes** ___ **No** ___

1. Vehicle shall be protected against rust by undercoating.
2. Undercoating warranty.

18. New Equipment **Bid Compliance: Yes** ___ **No** ___

1. The equipment shall be the current, new and unused model built by the manufacturer. The equipment must be delivered completely assembled and ready for operation at the time of delivery.
2. The vehicle shall be delivered with current State of Illinois inspection sticker.
3. The vendor must deliver vehicle at no charge.
4. The vehicle shall be delivered with temporary license plates with the vendor ordering municipal license plates to be delivered within an appropriate time frame.

19. Parts and Service **Bid Compliance: Yes** ___ **No** ___

1. The vendor must have authorized parts and service facility with a sufficient stock of spare parts and trained technicians to service the equipment bid. The vendor must pick-up and deliver the vehicle at no charge.

20. Manuals **Bid Compliance: Yes** ___ **No** ___

1. The successful vendor shall, upon delivery, furnish one (1) complete set of service and parts manuals, which may be written on CD-ROM that covers the equipment specified. Five hundred (\$500) dollars of the final payment will be withheld until all of the above are delivered.

21. Training **Bid Compliance: Yes** ___ **No** ___

1. The successful vendor shall upon delivery of the equipment, provide training to operators and service technicians covering the operation and daily maintenance of the equipment.

22. Warranty **Bid Compliance: Yes** ___ **No** ___

1. The bidder shall attach to this bid a detailed warranty statement that covers the chassis, exterior body, interior, engine and drive train, other vehicle features and rust proofing.
2. The vendor must pick up and deliver vehicle for service at no charge.

23. Alternatives and approved equal **Bid Compliance: Yes** ___ **No** ___

1. If the vendor is bidding alternatives, a sheet is to be submitted for each alternative with detailed information on the alternative.
2. The mention of a particular manufacturer's brand name or number in the specifications does not imply that this particular product is the only one that will be considered for purchase. This reference is intended solely to designate the type or quality of merchandise that will be accepted unless otherwise noted.

3. The Northwest Special Recreation Association may reject any and all bids on any basis without disclosure of a reason. The failure to make such a disclosure shall not result in the occurrence of any right, claim or cause of action by any unsuccessful bidders against the Northwest Special Recreation Association.

24. Miscellaneous

Bid Compliance: Yes___ No___

1. Vehicle shall meet or exceed all State and federal regulations in effect at time of manufacturing including ADA (Americans with Disabilities Act) requirements as they pertain to the type of vehicle being requested.
2. Bidder shall submit proposed floor plan with bid.
3. Bidder shall submit product catalogues on the vehicle being proposed as well as on the lift, air conditioning system and other pertinent equipment.
4. Bidder shall be a licensed and bonded dealer in the state of Illinois. Submit copy of license with bid.

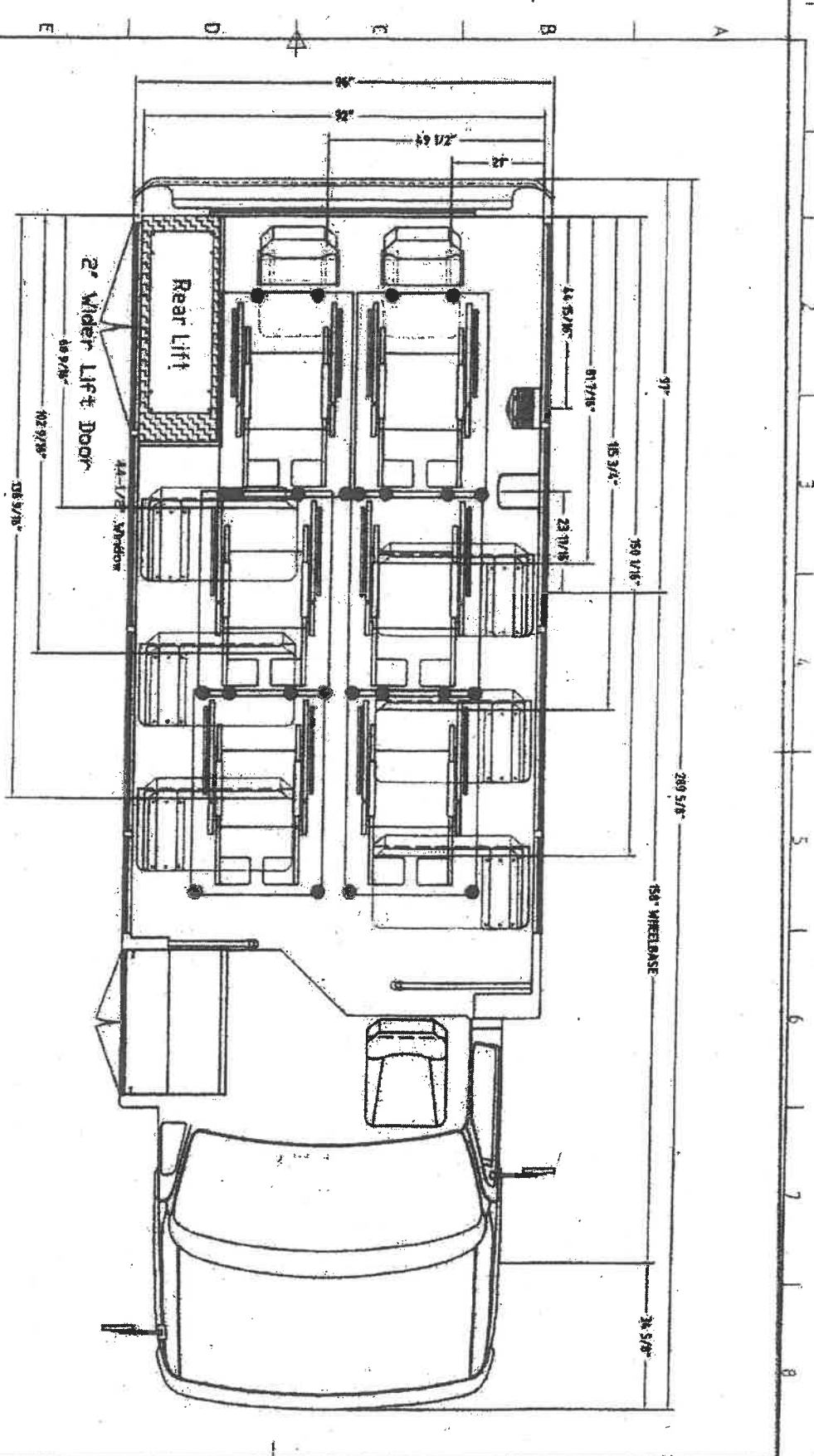

Driveline		Synchro Flat Floor				Seating		Freedom	
W/CUT	W/C/Pos	Ear Door	Factory	Hand. Top	S-Track	DBI	Single	Accessory	Wheel Base
REAR	6	30"	6 BY	Z S	0	0	0	0	158"
UNIT:									
Drawing ID No.									