

Title	Rec Plex - 420 W. Dempster - Mt Prospect - Kids Klub	10/14/2022
	by Ben Kutscheid in Member District ADA Project Request	id. 32865681
	1000 W. Central Road Mount Prospect, Illinois 60056 IL United States 847.255.5380 ext 108 bkutscheid@mppd.org	

Original Submission 10/14/2022

Name	Ben Kutscheid
Job Title	Park Planner
E-mail Address	bkutscheid@mppd.org
Phone Number	8472555380
Park District	Mt. Prospect
Project Location	Rec Plex - 420 W. Dempster - Mt Prospect - Kids Klub
Project Status	Alteration
Project Type	Routes and Surfaces
Routes and Surfaces- select a Project Category below:	Walking Surfaces
Benefits of the Project	Provide a firm, stable and slip resistant flooring in the Kids Klub at the Rec Plex. This will provide for ease of access throughout the Kids Klub wing of the Rec Plex
Items that will become ADA Compliant	Flooring in the Kids Klub and all areas it provides access too.

The project is designed or constructed, or applies human resources, to comply with:

**The 2010 Standards for Accessible Design
The Illinois Accessibility Code**

Upload Project Related Files, Photos, Videos or Audio

[MPPD_-_Rec_Plex_Kids_Club_1.pdf](#)

[MPPD_-_Rec_Plex_Kids_Club_2.pdf](#)

[MPPD_-_Rec_Plex_Kids_Club_3.pdf](#)

[MPPD_-_Rec_Plex_Kids_Club_4.pdf](#)

[MPPD_-_Rec_Plex_Kids_Club_5.pdf](#)

Budget Table for ADA Related Expenses

[Budget Table.xlsx](#)

ADA Dollars
Requested

17757.48

Notes related to
requested amount

Previously approved November of 2019 - Updated materials and cost for resubmittal



November 1, 2022

Ms. Tracey Crawford, CTRS, CPRP, Executive Director
Northwest Special Recreation Association
3000 Central Rd. - Suite 205
Rolling Meadows, IL 60008

Re: NWSRA Authorization of use of Accessibility Fund
RecPlex Kids Klub

Dear Tracey,

The Mount Prospect Park District Rec Plex Kids Klub (420 Dempster, Mt. Prospect, IL 60056) is a Recreation Center on the Southwest side of the Park District. The Park District intends to replace and upgrade the flooring in the Kids Klub. We recommend the following funds be authorized for use for the Mt. Prospect Park District for Accessibility improvements. The funds will be paid to a contractor through the Park District.

The Park District is proposing to install the Mohawk Industries – Premium Wood - Luxury Vinyl Tile 2.5mm thick. The Vinyl Tile meets ADA code for slip resistance complying with ASTM F1700 Class III type A and is firm and stable and slip resistant surface.

The total floor area for replacement is 2820 sf.

Request reimbursement for 5' width for main pathway through the Kids Klub. This main Pathway measures 218 lineal feet or 1090 sf. This pathway also includes clear floor space at doorways and drinking fountain. The pathway shall meet the current ADA Standards (2010) and Accessibility as determined in Chapter 4 Accessible Routes 402 accessible Routes 403 Walking Surfaces including 403.5.3 Passing Space.

The Park District request authorization of the use of the Accessibility Fund for 1090sf of flooring or 39% of \$45,532.01 for a requested **\$17,757.48**

The Mt. Prospect Park District request **\$17,757.48** for authorization of use of Accessibility Fund for accessibility improvements made as part of the RecPlex Kids Klub Flooring Enhancement. The total projected project cost including ADA and non ADA items is \$45,532.01.

Ben Kutscheid, ASLA, PLA, CPSI
Planner / Landscape Architect

Cc: Jessica Vasalos. Northwest Special Recreation Association
Jim Jarog, Mt. Prospect Park District
Nick Troy, Mt. Prospect Park District
Kristina Weinans, Mt. Prospect Park District

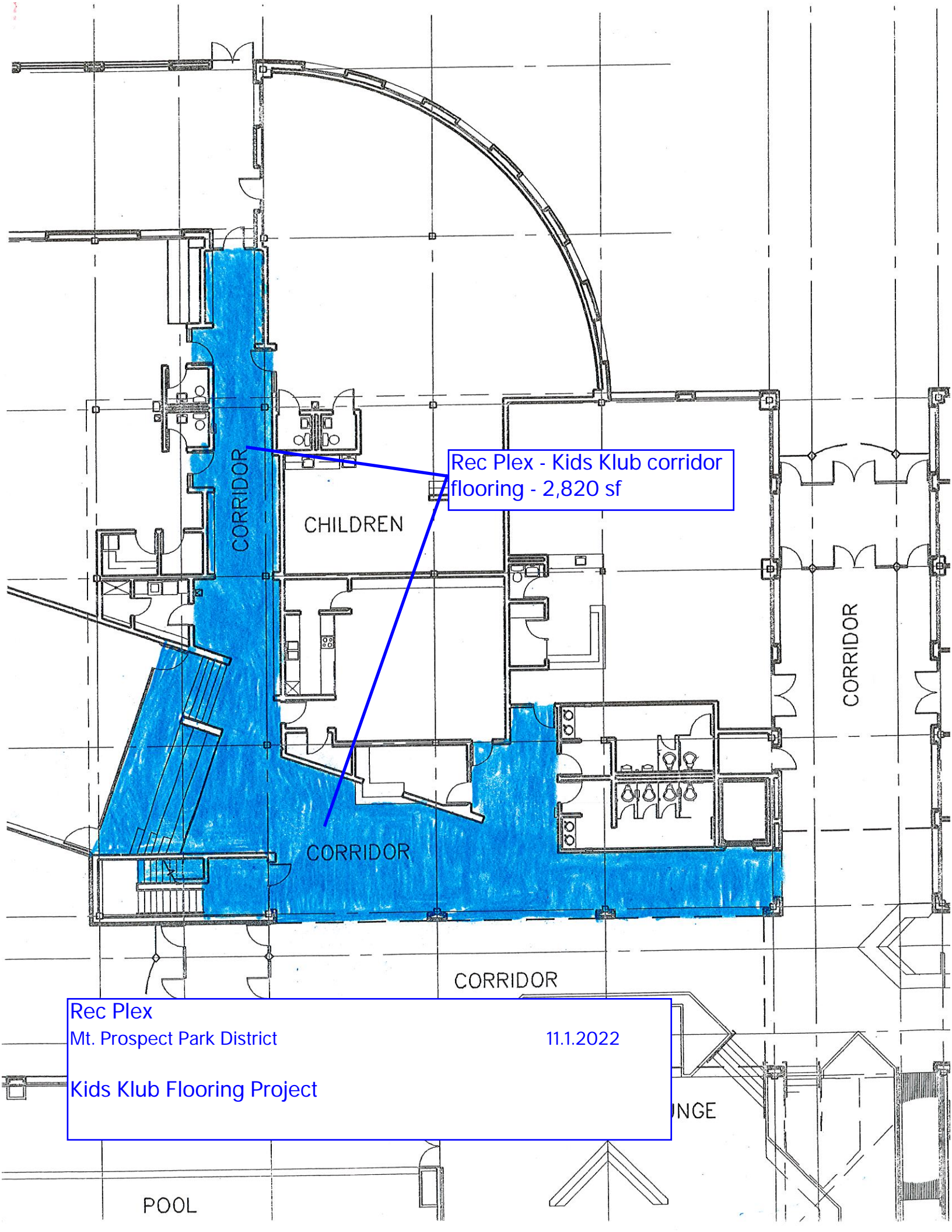

Rec Plex - Kids Klub corridor flooring - 2,820 sf

CORRIDOR

CHILDREN

CORRIDOR

CORRIDOR

CORRIDOR

INGE

POOL

Rec Plex
Mt. Prospect Park District
Kids Klub Flooring Project
11.1.2022

Premium Wood

Collection	Living Local
Style Name	Premium Wood
Style Number	C0194
Product Type	LVT
Size	7.72 in x 51.97 in

Feature	Description
Overall Thickness	2.5 mm
Wear Layer	20 mil (0.5 mm)
Finish	M-Force Ultra
Surface Profile	Overall Emboss
Squareness	ASTM F 2421 - Passes - ± 0.10 " max
Flexibility	ASTM F137 - Passes - 1" mandrel
Square Foot per Carton	36.22
Pounds per Carton	30.42
Classification	ASTM F1700 - Class III, Type B - Embosse



Recommended Installation Methods

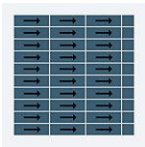

Monolithic

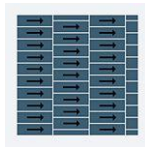

Monolithic Stepping

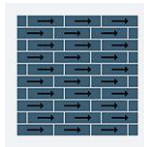

Half Lap



Random

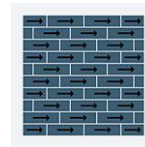

Brick Ashlar



Herringbone

Colorways



Studio

Color code: 095
Style number: C0194



Shadow

Color code: 096
Style number: C0194



Western Woods

Color code: 123
Style number: C0194



Fawn

Color code: 210
Style number: C0194



Scone

Color code: 235
Style number: C0194



Almond

Color code: 330
Style number: C0194



Cedar

Color code: 332
Style number: C0194

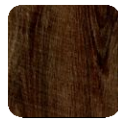

Brick

Color code: 358
Style number: C0194



Bisque Ware

Color code: 560
Style number: C0194



Tan Tone

Color code: 812
Style number: C0194



Sandy

Color code: 829
Style number: C0194



Beagle

Color code: 838
Style number: C0194



Cocoa

Color code: 889
Style number: C0194



Silver

Color code: 918
Style number: C0194



Bay Leaf

Color code: 939
Style number: C0194



Gorgeous Gray

Color code: 949
Style number: C0194



Two Tone

Color code: 958
Style number: C0194



Lead

Color code: 989
Style number: C0194

Performance

Feature	Description
Static Load	ASTM F970 - Passes, modified at 1000 psi
Dimensional Stability	ASTM F2199 - Passes - 0.020"/linear foot max
Residual Indentation	ASTM F1914 - Passes - Average less than 8% maximum single reading 10%
Resistance to Chemicals	ASTM F925 - Passes - No more than a slight change
Resistance to Heat	ASTM F1514 - Passes - ΔE <8
Resistance to Light	ASTM F1515 - Passes - ΔE <8
Critical Radiant Flux	ASTM E648 - Class 1 (>0.45 W/cm ²)
Smoke Density	ASTM E662 Part A - Less than 450

Sustainability

Feature	Description
Floor Score	Floor Score Certified
Certification Detail	Utilizes 100% closed-loop pre-consumer recycled content allocation
Country of Origin	USA
Environmental Product Declaration	EPD Vinyl Tile
Beyond Carbon Neutral	This product is 100% carbon neutral plus an additional 5% offset
Carbon Handprint	-0.03 kg CO ₂ e/ft ²
Embodied Carbon	0.6 kg CO ₂ e/ft ²

Warranties

Limited 20 Year M-Force Ultra Commercial Warranty

