

Title	<b>Devonshire Park</b>	06/24/2022
	by <b>Ben Kutscheid</b> in <b>Member District ADA Project Request</b>	id. 27480215
	1000 W. Central Road Mount Prospect, Illinois 60056 United States 847.255.5380 ext 108 bkutscheid@mppd.org	

## Original Submission 06/24/2022

Name	<b>Ben Kutscheid</b>
Job Title	<b>Planner / Landscape Architect</b>
E-mail Address	<b>bkutscheid@mppd.org</b>
Phone Number	<b>847.255.5380 ext 108</b>
Park District	<b>Mt. Prospect</b>
Project Location	<b>Devonshire Park</b>
Project Status	<b>New Alteration</b>
Project Type	<b>Recreation Facilities and Amenities Routes and Surfaces</b>
Recreation Facilities and Amenities- select a Project Category below:	<b>Playgrounds- Play Components Benches- Picnic Tables</b>
Routes and Surfaces- select a Project Category below:	<b>Accessible Routes- Means of Egress Play Surfaces Walking Surfaces</b>
Benefits of the Project	<b>Providing Accessible opportunities for play for the neighborhood and school</b>
Items that will become ADA Compliant	<b>Play equipment, Benches, Picnic Tables, PIP surfacing and walkways</b>

The project is designed or constructed, or applies human resources, to comply with:

**The 2010 Standards for Accessible Design  
ASTM F 1951 Standard for Accessible Playground Surfaces**

---

Upload Project Related Files, Photos, Videos or Audio

[Dev\\_3.pdf](#)

[Dev\\_4.pdf](#)

[Dev\\_5.pdf](#)

[Dev\\_6.pdf](#)

[Dev\\_1.pdf](#)

[Dev\\_1\\_Copy\(1\).pdf](#)

---

Budget Table for ADA Related Expenses

[Budget Table.xlsx](#)

---

ADA Dollars Requested	<b>219027.72</b>
-----------------------	------------------

---

Notes related to requested amount	<b>Per tele meeting with Tracey and Andrea on 6/16</b>
-----------------------------------	--

---



July 1, 2022

Ms. Tracey Crawford, CTRS, CPRP, Executive Director  
Northwest Special Recreation Association  
3000 Central Rd. - Suite 205  
Rolling Meadows, IL 60008

Re: NWSRA Authorization of use of Accessibility Fund  
Devonshire Park Redevelopment

Dear Tracey,

Devonshire Park Playground (1401 Pennsylvania Avenue, Des Plaines) is a neighborhood School/Park located on the Southeast side of the Park District. We recommend the following funds be authorized for use by the Mt. Prospect Park District for Accessibility improvements. The funds will be used for playground and general park construction.

The first items are related to the play area replacement. The play area meets and exceeds current ADA Standards (2010). The play equipment was approved at the NWSRA May board meeting at an accessibility of 80%. The Playground Accessibility is as determined in Chapter 2 Scoping Requirements 240 Play Areas and Chapter 10 Recreation Facilities 1008 Play Areas.

- 1) Request authorization for 50% of the cost for play area removal. The cost to remove the play area is \$3,200. We request authorization for the Park District to use ADA funds in the amount of **\$1,600.**
- 2) Request reimbursement for 80% of the cost of labor to install the new play equipment. The cost of the labor is \$34,441.40. We request authorization for the Park District to use ADA funds in the amount of **\$27,553.12.**
- 3) Request authorization for the cost of 5,444sf resilient surface. The Park District is proposing to install a resilient surface that is all "Poured in Place Rubber". The surface shall meet the current ADA Standards (2010) and Accessibility as determined in Chapter 2 Scoping Requirements 206.2.2 Accessible Route within a Play Area Chapter 3 Building Blocks 305.2 Floor and Ground Surfaces. We request authorization for the Park District to use ADA funds in the amount of **\$160,171.20**
- 4) Request authorization for 5' and 3' concrete pathway width and table clear floor space which is about 90% of 2066 sf concrete pad, new concrete walk and picnic table pad in the center of the play area. The cost for the concrete walk and the concrete pad is \$22,726. The concrete pad shall meet the current ADA Standards (2010) and Accessibility as determined in Chapter 2 Scoping Requirements 206.2.2 Accessible Route within a site Chapter 4 Accessible Routes 403 Walking Surfaces and Chapter 9 Built in Elements 902.2 Dining Surfaces Clear Floor Space. We request authorization for the Park District to use ADA funds in the amount of **\$20,453.40**
- 5) Request reimbursement for 50% of cost of 2 ADA picnic tables and 2 ADA Benches. The cost of one installed picnic table is \$6,700 the cost 2 ADA benches is \$5,000. The ADA Picnic Tables shall meet the current ADA Standards (2010) and Accessibility as determined in Chapter 2 Scoping Requirements 226 Dining Surfaces and in







© 2021 Keystone Ridge Designs, Inc.  
All Rights Reserved.

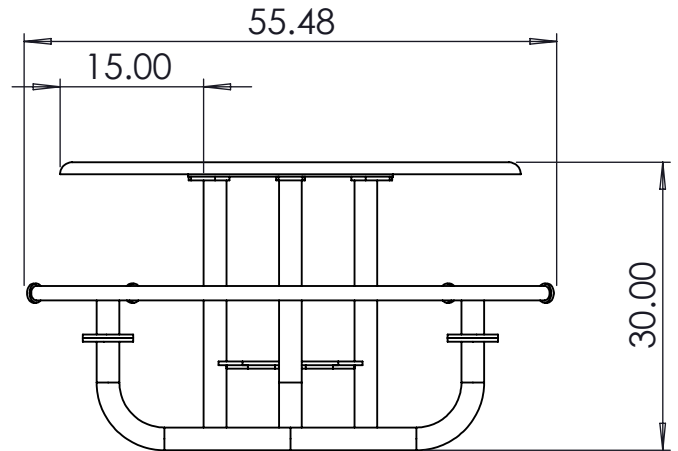
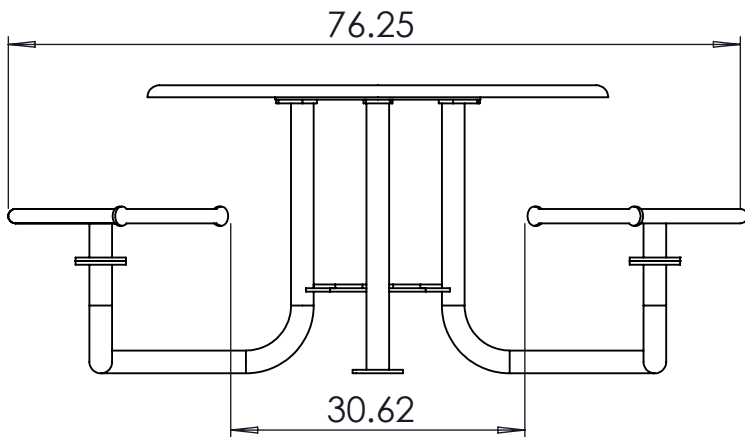
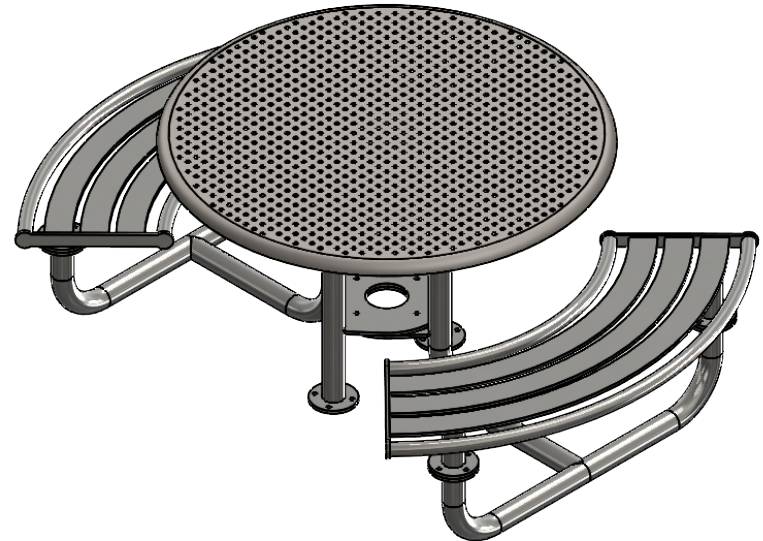
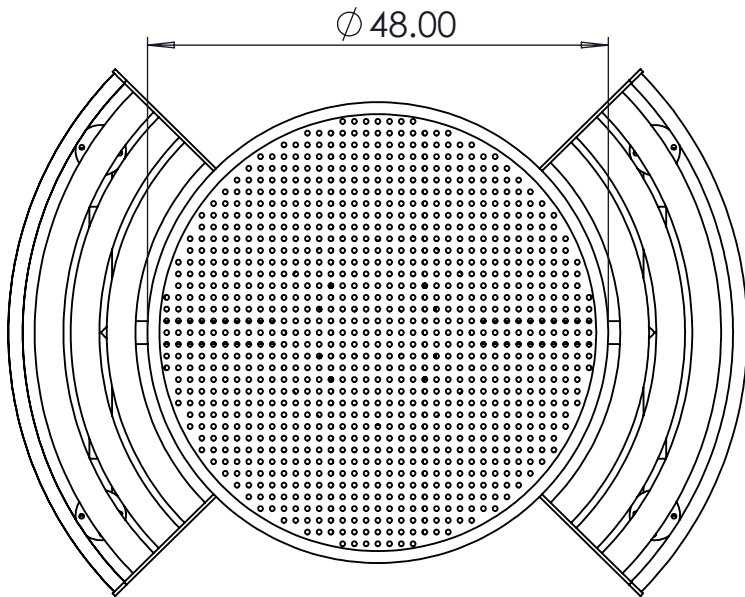

KEYSTONE RIDGE DESIGNS, INC®  
 670 MERCER ROAD  
 BUTLER, PA 16001  
 PHONE: 1-800-284-8208  
 FAX: (724) 284-1253  
 www.keystoneridgedesigns.com

UNLESS OTHERWISE SPECIFIED:

DIMENSIONS ARE IN INCHES  
 TOLERANCES:  
 FRACTIONAL ± 1/16  
 ANGULAR/BEND ± 1°  
 TWO PLACE DECIMAL ± .030  
 THREE PLACE DECIMAL ± .020

MATERIAL

FINISH

DO NOT SCALE DRAWING

DRAWN	NAME	DATE
CHECKED	CJC	5/23/2022

**EXCLUSIVE BY DESIGN™**

**PROPRIETARY AND CONFIDENTIAL**  
 THE INFORMATION CONTAINED IN THIS  
 DRAWING IS THE SOLE PROPERTY OF  
 KEYSTONE RIDGE DESIGNS. ANY  
 REPRODUCTION IN PART OR AS A  
 WHOLE WITHOUT THE WRITTEN  
 PERMISSION OF KEYSTONE RIDGE  
 DESIGNS IS STRICTLY PROHIBITED.

TITLE:  
**PENN TABLE SET 48" RND  
 PERFERATED ADA**

SIZE <b>A</b>	DWG. NO. PNCU6-1-48"ADA	REV -
------------------	----------------------------	----------

SCALE: 1:20	WEIGHT:	SHEET 1 OF 1
-------------	---------	--------------

