

**ROLLING MEADOWS
PARK DISTRICT**

EXECUTIVE DIRECTOR
Amy Charlesworth

ATTORNEY
Bruno Tabis

**BOARD OF
COMMISSIONERS**

Linda Blane
Don Bohac
Bill Cooley
William Palla
Mary Simonis
Tom Trapani
Patti Weicker

ADMINISTRATIVE OFFICE

Park Central
3000 Central Road
Suite 100
Rolling Meadows, IL 60008
Phone: (847) 818-3220
FAX: (847) 818-3224

COMMUNITY CENTER

3777 Pheasant Drive
Rolling Meadows, IL 60008
Phone: (847) 818-3200
FAX: (847) 818-3207

MAINTENANCE FACILITY

3900 Berdnick
Rolling Meadows, IL 60008
Phone: (847) 963-0550
FAX: (847) 963-0549

PLUM GROVE PARK

4001 Park Drive
Palatine, IL 60067
Phone: (847) 397-4800
FAX: (847) 397-9873

NELSON SPORTS COMPLEX

3900 Owl Drive
Rolling Meadows, IL 60008
Phone: (847) 818-3210
FAX: (847) 818-3375

WEST MEADOWS ICE ARENA

3939 Winnetka Avenue
Rolling Meadows, IL 60008
Phone: (847) 398-2700
FAX: (847) 870-5334

November 10, 2009

Mrs. Susie K. Julison
Executive Director
Northwest Special Recreation
3000 Central Road
Rolling Meadows, IL. 60008

Re: Improvements Proposed to be Financed Using the Special Recreation Levy.

Dear Susie,

The Rolling Meadows Park District hereby notifies and requests approval of the NWSRA Board of Directors for the proposed expenditure of funds from the Districts Special Recreation levy to pay for the cost of the following improvements.

1. South Salk playground project

The renovation of South Salk Park playground was completed during the summer of 2009. The project included:

- Design, engineering and construction observation to insure ADA compliant layout and installation of play equipment and pathways,
- Demolition of existing non-compliant pathways,
- Installation of accessible paths, purchase and installation of play equipment, picnic tables, and drinking fountain.

The total cost for this project was \$264,463. Costs to meet ADA compliance totaled \$171,871.

The benefits of this project to the NWSRA are that an ADA compliant accessible playground is within walking distance to the NSWRA Day Camp program that is held at Conyers Learning Academy.

2. ADA Accessibility Assessment of Facilities and Property.

The Park Board engaged the services of Recreation Accessibility Consultants to complete an audit of the 6 facilities and 11 parks of the District. The cost for this audit is \$26,900.

The Rolling Meadows Park District respectfully requests that you review this request and present it with your approving recommendation to the NWSRA Board of Directors.

Sincerely,

Amy Charlesworth
Director

Cc: RM Board of Park Commissioners

An Illinois Distinguished Agency

27 East Palatine Road
 Prospect Heights, Illinois 60070
 800-677-6608
 Tel 847-419-7744
 Fax 847-419-7747



204 Leeds Drive
 Valparaiso, Indiana 46383
 888-648-1433
 Tel 219-477-1842
 Fax 219-477-1851

www.parkcreation.com

Qty Part Number Part Description

1) School Age Equipment

1	200006993	POLE SLIDE 1625 MM/64" KB		
1	200007039	BRIDGE CLATTER 2440 MM/8' W/GUARD RAILS		
1	200007097	PANEL ADJUSTABLE COUNTER KB		
1	200007099	PANEL SEAT KB		
2	200013800	KB 138" POST PLUS GLV. W/ALUM.CAP		
4	200013812	KB 148" POST PLUS GLV. W/ALUM.CAP		
2	200013893	DECK SQUARE KB		
1	200058823	TALK TUBE KB		
1	200085834	ROCK CHALLENGE WALL 1220MM KB		
6	200104307	LABEL AGE APP. (5 TO 12 YRS.)		
1	200107428	PANEL KB STEEL TAP-A-TUNE ABOVE DECK		
2	200109865	KBP SAFETY RAIL DKMT		
2	200111492	LABEL, IDENTIFICATION STAMPED W/RIVETS		
1	200114727	KBP SAFETY RAIL W/WHEEL MOUNT DKMT(2001		
1	200200187	KB DK/DK PLATE 8"/205MM (FACES)		
1	200200267	CLIMBER CURLY 1422MM/56" KB (2004)		
1	200200305	PANEL ARCH FUN W/WORDS DKMT. KB		
1	200200336	RAIL BANNISTER 1220MM/48" KB (2004)		
1	200200424	KB POST MOUNT PLASTIC STEERING WHEEL		
1	200200467	KB ACCORDION CLIMBER 1422MM(56") GROUND		
1	200200486	BONGO PANEL LFT.MT. KB		
1	200200533	OCTOPUS ROPE CLMBR W/SFTY LP(TAN/GRN)		
1	200200614	SKYBUILDER TALL F/KB W/QUANTUM		
1	200245788	ASSY RAIL MT.ALUM.STEER.WHL. RED		
		Accessible School Age Total	89%	

2) Independent Equipment

1	200201870	SOLO SPINNER		
		Accessible Independent Equipment Total	100%	

Salk Park Playground Area (Little Tikes Commercial)

ADA Guidelines

Total Elevated Playstructure Components-17

No Ramp Required

	Provided	Required
Playstructure Equipment Accessible Via Ramps	N/A	
Playstructure Equipment Accessible Via Transfer	14	9
Ground Level Events	8	8
Ground Level Types	5	3

*does not include swings from Landscape Structures

South Saik Park Playground Accessible Improvements			
	Total Cost	ADA Cost	Description
1 Playground	\$73,557	\$67,415	Main playground equipment
2 Individual Events	\$27,570	\$2,646	Climbing Rock, Swings and saddle spinner
Durabuilt	\$2,520	\$0	Site fencing
3 Materials, Equipment and installation	\$76,793	\$62,943	Concrete curbing, playground installation, drinking fountain, woodfiber etc.
4 Materials & grading walkways	\$18,533	\$18,533	Accessible walkways
5 Engineering	\$26,722	\$20,334	Design, engineering and oversight
6 Misc. worksite expenses	\$38,768	\$0	Worksite supplies and payroll expense
Project Total	\$264,463	\$171,871	Total ADA Costs

Amy Charlesworth

From: Kevin Driscoll [kevind@nutoys4fun.com]
Sent: Monday, November 09, 2009 3:52 PM
To: Amy Charlesworth
Subject: RE: Rolling Meadows Park District

Hi Amy,

The Rock is not ADA accessible and the swings are a accessible event via ground level. Feel free to let me know if we can be helpful. Thanks, Kevin

Kevin Driscoll
NuToys Leisure Products
(708)579-9055 PH.
(708)579-0109 Fax.
(708)606-9055 Cell.
kevind@nutoys4fun.com

From: Amy Charlesworth [mailto:ACharlesworth@rmparks.org]
Sent: Tuesday, November 03, 2009 4:35 PM
To: Kevin Driscoll
Subject: Rolling Meadows Park District

Hi Kevin, could you provide me with a letter stating what the ADA accessibility for the climbing rock is. Swings too.
Thanks. Amy

Amy Charlesworth
Executive Director
Rolling Meadows Park District
Office: 847-818-3220 ext 111
ACharlesworth@rmparks.org

 please don't print this e-mail unless you really need to

RIVER TRAILS

PARK DISTRICT



ADMINISTRATIVE OFFICE
401 East Camp McDonald Road, Prospect Heights, Illinois 60070
Phone: (847) 788-0551 Fax: (847) 788-1248
E-Mail: admin@rtpd.org

MARVIN S. WEISS COMMUNITY CENTER
1500 East Euclid Avenue, Mount Prospect, Illinois 60056
Phone: (847) 255-1200 Fax: (847) 255-1285
E-Mail: info@rtpd.org

September 21, 2009

Ms. Susie Julison
Executive Director
NWSRA
3000 Central Road – Suite 205
Rolling Meadows, IL 60008

Re: Improvements Proposed to be Financed Using Special Recreation Levy

Dear Ms. Julison,

We request approval from the NWSRA Board of Directors for the proposed expenditure of funds from the River Trails Park District's Special Recreation Levy to pay for the cost of the following ADA improvements:

1) Willow Trails Park, Burning Bush Trails Park, and Rob Roy Golf Course Asphalt repairs and sealcoating of all parking lots and accessible paths; and Burning Bush Trails Park roller courts:

Out of the total bill of \$32,521.50, we are requesting \$3,965.10.

- 10% of the cost of sealcoating and repairs to paths and parking lots:
 - Repairs, sealcoating, striping, and handicap markings to Willow Trails Park, Burning Bush Trails Park, Rob Roy Golf Course: 10% of \$23,701 = \$2,370.10
- 15% of the cost of resurfacing:
 - Burning Bush Trails Park enclosed basketball and roller courts: 15% of \$8,500.00 = \$1,275.00
- 100% of the cost of additional handicap parking spaces striped: \$320.00

Totally \$3,965.10

2) The River Trails Park District has contracted with recreation accessibility consultants to conduct an Access Audit not to exceed \$11,000.

We respectfully request that you review these two proposals and present it for recommendation to the NWSRA Board of Directors.

Thank you very much for your consideration.

Sincerely,

A handwritten signature in cursive script that reads "Debbie Carlson Kudla".

Debbie Carlson Kudla



October 23, 2009

Susie K. Julison
Executive Director
Northwest Special Recreation Association
3000 Central Road- Suite 205
Rolling Meadows, IL 60008

Elk Grove Park District
Board of Commissioners

Tom Cooke

Ronald A. Foster

Ronald J. Nunes

Bill O'Malley

Ralph Souder

Mike Brottman,
Executive Director

RE: 2009 Elk Grove Park District Projects to be Financed Using Special Recreation Levy

Dear Ms. Julison,

The Elk Grove Park District hereby notifies and requests approval of the NWSRA Board of Directors for the expenditure of funds from the District's special recreation levy, to pay the cost of the following improvements.

Park	Total Project Budget	Total Accessible Budget	Actual Project Total	Actual Accessible Total
Bartrum-Renovation	\$215,000	43,000	\$194,989.00	\$43,000.00
Olmstead-Renovation	15,000	15,000	\$14,025.00	\$14,025.00
Osborn Renovation	162,430	5,000	\$88,454.00	\$5,000.00
Site Furniture	24,000	6,000	\$27,074.00	\$6,000.00
Fairchild walk improvements	21,000	4,000	\$17,650.00	\$4,000.00
Marshall walk improvements	3,900	3,000	\$2,840.00	\$2,840.00
Lions walk improvements	17,000	3,140	\$12,500.00	\$3,140.00
Burbank walk improvements	6,600	3,650	\$3,500.00	\$3,500.00
Handrails @ Johnson, Clark, HC	10,994	10,994	\$10,994.00	\$10,994.00
Adaptive play equip(swings)	1,433	1,433	\$1,433.00	\$1,433.00
A Hatt. Center improvements	32,000	8000	12,631.00	\$12,631.00

The estimated costs of improvements are **\$106,563.00**. The improvements are expected to be substantially completed by December 1, 2009 Anticipated benefits of the project to NWSRA are as follows:

Bartrum Park \$43,000. This park renovation included playground equipment that has either a transfer platform or ramp to access the structures. The center of the play area includes a picnic shelter for shade and accessible seating from an accessible path. Ramps into the engineered wood fiber play surface provide access to the adaptive swing and play equipment. A new 5' wide concrete path through out the park with seating areas replaces the old 4' concrete walk that was in poor condition. A new softball spectator area includes

Elk Grove Park District
499 Biesterfeld Road
Elk Grove Village, IL
60007

Phone: 847-437-9494
Fax: 847-228-3508
www.elkgroveparks.org



Elk Grove Park District
Board of Commissioners

Tom Cooke

Ronald A. Foster

Ronald J. Nunes

Bill O'Malley

Ralph Souder

Mike Brottman,
Executive Director

accessible seating in the bleacher area, an accessible walk from the public sidewalk and better visibility of the field.

Olmstead Park Nature Shack \$14,025. The Nature Shack is a re-purposed ice skating warming shed that is our new outdoor education center. The existing restrooms were too small and needed to be made accessible. Staff developed a single ADA accessible restroom and upgraded all the fixtures. Signage was upgraded and installed as well. Accessible walkways and paths now lead from the public sidewalk into the building.

Osborn Park \$5,000 As part of the renovations of the park tennis and basketball courts a new accessible path was built. Accessible seating areas and appropriate site furniture were installed. A new picnic shelter, between the playground and ball field has 2 new accessible tables.

Site Furniture \$6,000 New accessible furniture was placed along accessible routes to playgrounds and ball fields. The furniture is new to these areas and includes benches and picnic tables for all. Newberry, Johnson, Audubon, Hanson, Mead, Olmstead and Fairchild parks received new furniture.

Fairchild Park \$ 7,900 A new concrete walk replaced the old broken asphalt walk and connected the accessible bleacher area with the playground and tennis courts. The walk also connects the portable toilet and tennis courts. New accessible benches were installed.

Marshall Park \$2,840 A new accessible concrete walk connects the parking and playground to the spectator area of the soccer field. Accessible spectator space is now available.

Lions Park \$3,140 Accessible path from parking to bleacher areas and accessible picnic tables along the path are available.

Burbank, Lindbergh, Huntington Chase, Johnson Parks \$3,500. The majority of the funds were used to provide an accessible path from the public sidewalk to the toilet and enclosure at Burbank Park. Accessible toilets were contracted for the additional parks during the soccer seasons.

Handrails along sidewalks, Huntington Chase, Johnson and Clark Parks \$10,994 Concrete walks were steeper than 5% slope and required handrails to meet requirements. These walks were designated as accessible routes to portable toilets, and bleacher areas near sports fields.

Adaptive play equipment \$1,433. Adaptive swings with straps for use by schools at recess and general play for Bartrum (as per public meeting) and Hattendorf preschool.

Elk Grove Park District
499 Biesterfield Road
Elk Grove Village, IL
60007

Phone: 847-437-9494
Fax: 847-228-3508
www.elkgroveparks.org



Al Hattendorf Center \$12, 631 Improvements in concrete walks for building access, new doors with security and hardware and appropriate signage for accessibility to the preschool and adult centers within the building.

Elk Grove Park District
Board of Commissioners

The Elk Grove Park District respectfully requests that you review this request and present it with your approving recommendation to the NWSRA Board of Directors. If you have any questions or require additional information, please do not hesitate to contact me.

Tom Cooke

Yours truly,

Ronald A. Foster

Ronald J. Nunes

Valerie Gerdes Lemme
Planner II

Bill O'Malley

Ralph Souder

Cc: Board of Park Commissioners

Mike Brottman,
Executive Director

Elk Grove Park District
499 Biesterfeld Road
Elk Grove Village, IL
60007

Phone: 847-437-9494
Fax: 847-228-3508
www.elkgroveparks.org



Established in 1964

Board of Commissioners

MARIANNE CORDELL

STEPHEN M. ECKELBERRY

THEODORE J. LEWIS **October 19, 2009**

JAMES A. MANSFIELD

LORI A. PALMER

SUSAN M. STOCKS

KENNETH N. WOODS

Susie K. Julison

Executive Director

Northwest Special Recreation Association

3000 Central Road – Suite 205

Rolling Meadows, IL 60008

Executive Director

RITA K. FLETCHER

Re: Improvements proposed to be financed using special recreation levy

Dear Ms. Julison:

The Bartlett Park District hereby notifies and requests approval of the NWSRA Board of Directors for the proposed expenditure of funds from the District's special recreation levy to pay the cost of the following improvements:

Riley's Run Park project is the development of an accessible eight-acre park site with playground, tennis court, basketball court, picnic shelter, fitness equipment, dog park, parking lot and pathways.

The total cost of the improvements to the park is \$562,215. **Of this, \$96,519.00 (17% of the total project) is requested to be funded from the special recreation levy.** Please refer to the attached plan and cost summary for details. The improvements are expected to be substantially complete by October, 2009. Anticipated benefits of the project to NWSRA are as follows:

Access to the park is found via the accessible sidewalk and Village multi-use path or from the two accessible stalls in the parking lot. The path, sidewalk and the parking lot lead directly to the park's accessible asphalt pathway that connects to the ADA compliant elements of the park; picnic shelter, drinking fountain, tennis and basketball courts, fitness equipment, benches, and multiple elements in the playground. The play area surface includes a poured synthetic rubber safety surface for easy access to the play structure and accessible swing seat.

The District respectfully requests that you review this request and present it with your approving recommendation to the NWSRA Board of Directors. If you have any questions or require additional information, please do not hesitate to contact me.

Very truly yours,
BARTLETT PARK DISTRICT

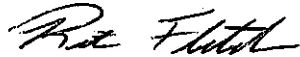
A handwritten signature in black ink, appearing to read "Rita Fletcher". The signature is written in a cursive style with a large initial "R".

Rita K. Fletcher
Executive Director

**RILEY'S RUN PARK DEVELOPMENT
SRA REIMBURSEMENT SUBMITTAL**

10/19/09

<u>DESCRIPTION OF SRA RELATED ITEMS</u>	<u>COST</u>	<u>SRA PORTION</u>	<u>SUBMITTED</u>
Drinking fountain, water service	\$55,300.00	25.00%	\$13,825.00
Playground surfacing, engineered wood fiber	\$9,500.00	50.00%	\$4,750.00
Playground surfacing, synthetic rubber	\$21,560.00	100.00%	\$21,560.00
Playground and fitness equipment	\$78,610.00	25.00%	\$19,653.00
Picnic shelter	\$33,825.00	25.00%	\$8,456.00
ADA picnic tables	\$4,500.00	50.00%	\$2,225.00
Concrete paving	\$26,834.00	30.00%	\$8,050.00
Asphalt paving-8' path	\$37,908.00	37.50%	\$14,216.00
Parking lot	\$37,835.00	10.00%	\$3,784.00
Total SRA request for reimbursement			\$96,519.00

Total Riley's Run project costs were \$562,215

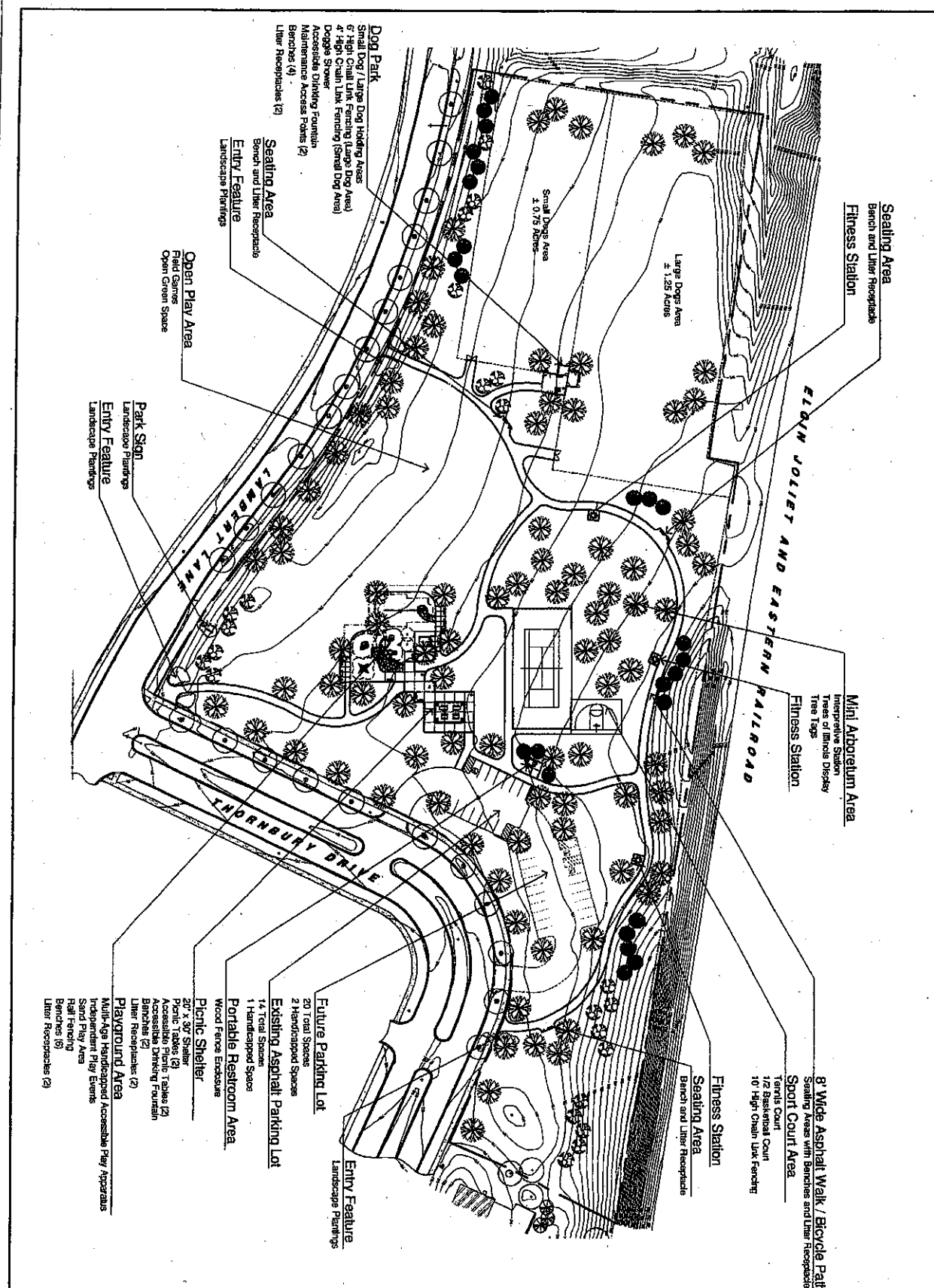

Sheet #

Sheet Title
Preliminary Design Plan

Issues & Revisions	
#	Description
1	04/18/07 Client Review
2	04/17/07 Client Review
3	04/07/07 Client Review

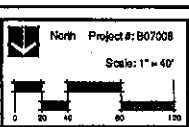

Project & Client Name
**Castle Creek Park
 Park Development
 Bartlett Park District**

BDG
 Brusseau Design Group, LLC
 Landscape Architecture • Urban Design • Site and Interior Planning • Design

2015 Piquette Avenue, Naperville, Illinois 60563
 (708) 250-6170 (708) 250-7773 Fax



Established in 1964

Board of Commissioners

MARIANNE CORDELL

STEPHEN M. ECKELBERRY

THEODORE J. LEWIS

JAMES A. MANSFIELD

LORI A. PALMER

SUSAN M. STOCKS

KENNETH N. WOODS

October 19, 2009

Susie K. Julison
Executive Director
Northwest Special Recreation Association
3000 Central Road – Suite 205
Rolling Meadows, IL 60008

Executive Director

RITA K. FLETCHER

Re: Improvements proposed to be financed using special recreation levy

Dear Ms. Julison:

The Bartlett Park District hereby notifies and requests approval of the NWSRA Board of Directors for the proposed expenditure of funds from the District's special recreation levy to pay the cost of the following improvements:

Bartlett Reserve Park project is the development of a one-half acre park site with an accessible playground and picnic area.

The estimated total cost of the improvements is \$80,537.00. **Of this, \$16,107.00 (20% of the total project) is requested to be funded from the special recreation levy.** The improvements are expected to be substantially complete by November 30, 2009. Anticipated benefits of the project to NWSRA are as follows:

The accessible walkway leads from the public sidewalk directly to the park's ADA compliant playground and picnic area. The play area has multiple accessible elements and the picnic area is shaded and has an accessible picnic table.

The District respectfully requests that you review this request and present it with your approving recommendation to the NWSRA Board of Directors. If you have any questions or require additional information, please do not hesitate to contact me.

Very truly yours,

Rita K. Fletcher
Executive Director
BARTLETT PARK DISTRICT



October 13, 2009

Susie K. Julison
 Executive Director
 Northwest Special Recreation Association
 3000 Central Rd- Suite 205
 Rolling Meadows, IL 60008

Re: Arlington Heights Park District Improvements to be Financed using Special Recreation Levy

Dear Ms. Julison,

The Arlington Heights Park District notifies and requests approval of the NWSRA Board of Directors for the expenditure of funds from the District's special recreation levy, for the following park improvements with ADA accessible features within each project:

Capital Project	Project Total	ADA Total	Total Requested
Heritage Park Pathway & Bleacher Pad Improvements	\$257,663.54	\$162,328.03	\$158,134.50
Berbercker Park- ADA Playground & Pathway	\$151,824.15	\$63,766.14	\$52,957.30
Patriots Park- Playground Improvements	\$167,870.28	\$83,935.14	\$57,661.09
Lake Arlington- ADA Bridge Replacement	\$40,474.51	\$33,593.84	\$16,958.33
North School Park- Playground Improvements	\$61,759.31	\$45,084.30	\$30,837.35
Nickol Knoll Golf Club- ADA Pathway	\$90,994.65	\$51,000.32	\$51,000.32
Nickol Knoll Golf Club- ADA Sidewalk	\$6,276.00	\$6,276.00	\$6,276.00
Arlington Lakes Golf Club- ADA Pathway	\$110,082.92	\$78,158.87	\$13,698.13
Pioneer Park Sidewalk- Ball Diamond #1	\$31,540.08	\$31,540.08	\$5,885.01
Carefree Park- New ADA Sidewalk	\$14,932.31	\$14,932.31	\$14,932.31
TOTAL	\$933,417.75	\$570,615.03	\$408,340.34

Capital Projects	% ADA	% Requested
Heritage Park Pathway & Bleacher Pad Improvements	63%	61%
Berbercker Park- ADA Playground & Pathway	42%	35%
Patriots Park- Playground Improvements	50%	34%
Lake Arlington- ADA Bridge Replacement	83%	42%
North School Park- Playground Improvements	73%	50%
Nickol Knoll Golf Club- ADA Pathway	56%	56%
Nickol Knoll Golf Club- ADA Sidewalk	100%	100%
Arlington Lakes Golf Club- ADA Pathway	71%	12%
Pioneer Park Sidewalk- Ball Diamond #1	100%	19%
Carefree Park- New ADA Sidewalk	100%	100%
TOTAL	62%	45%

Heritage Park Pathway & Bleacher Pad Improvements

This project consisted of removal and replacement of the asphalt pathway with a new 8' wide concrete pathway and the installation of new 5' wide sidewalks and bleacher pads for all of the ball fields. These improvements were completed in the summer of 2008. The benefits of this project to NWSRA are as follows: (1) provides an accessible path to the ball fields, (2) provides smooth surface condition for easier use, (3) provides an accessible path to the bleacher pads, and (4) provides an accessible path around the park. The site was not previously accessible, and the primary purpose of installation of 5' of the width can be attributed to accessibility with secondary purposes including equipment accommodation and extracurricular activities (i.e. biking) via additional width not included in the amount estimated/requested. We estimate that 63% of the improvements can be attributed to accessibility, and we are requesting 61%. This includes a percentage of the material cost, demolition, excavation, installation, and restoration of the pathway and the bleacher pads. Please reference Appendix A for additional information.

Berbecker Park- ADA Playground & Pathway

The project consisted of the removal and replacement of the existing playground with new accessible equipment, surfacing and entry walk. These improvements were completed in the summer of 2008. The benefits of this project to NWSRA are as follows: (1) provides a 5' accessible path up to and into the playground, (2) provides accessible play activities, (3) enables children to interact and play, (4) and enables children to learn social skills. The site was not previously accessible, and the primary purpose of installation of the equipment, materials, and costs associated with the accessible features utilized can be attributed to accessibility. We estimate that 42% of the playground improvements can be attributed to accessibility, and we are requesting 35%. This includes a percentage of the equipment cost, demolition, excavation, installation, and restoration of the playground, cost for the safety surfacing, and cost of the concrete work for the playground. Please see Appendix B for additional information.

Patriots Park- Playground Improvements

The project consisted of the removal and replacement of the existing playground with new accessible equipment, surfacing and entry walk. These improvements were completed in the summer of 2008. The benefits to NWSRA are as follows: (1) provides a 5' wide accessible path up to and into the playground, (2) provides accessible play activities, (3) enables children to interact and play, and (4) enables children to learn social skills. The site was not previously accessible, and the primary purpose of installation of the equipment, materials, and costs associated with the accessible features utilized can be attributed to accessibility. We estimate that 50% of the improvements can be attributed to accessibility, and we are requesting 34%. This includes a percentage of the equipment cost, demolition, excavation, installation, and restoration of the playground, cost for the safety surfacing, and cost of the concrete work for the playground. Please see appendix C for additional information.

Lake Arlington- ADA Bridge Replacement

The project consisted of the removal and replacement of the current two bridges with new pedestrian bridges. These improvements were completed in the summer of 2009. The benefits to NWSRA are as follows: (1) provides a 6' accessible path connecting the sidewalks, (2) provides a smooth surface condition for easier use, and (3) provides a continuance of the accessible path throughout the park. The site was not previously accessible, and the primary purpose of installation can be attributed to accessibility. We estimate that 83% of the bridge replacement can be attributed to accessibility, and we are requesting 42%. This includes a percentage of the equipment cost, removal, disposal, and installation of the two bridges. Please see appendix D for additional information.

North School Park- Playground Improvements

The project consisted of the removal and replacement of the existing playground with new accessible equipment, surfacing and entry walk. These improvements were completed in the summer of 2008. The benefits to NWSRA are as follows: (1) provides a 5' wide accessible path up to and into the playground, (2) provides accessible play activities, (3) enables children to interact and play, and (4) enables children to learn social skills. The site was not previously accessible, and the primary purpose of installation of the equipment, materials, and costs associated with the accessible features utilized can be attributed to accessibility. We estimate that 73% of the improvements can be attributed to accessibility, and we are requesting 50%. This includes a percentage of the equipment cost, demolition, excavation, installation, and restoration of the playground, cost for the safety surfacing, and cost of the concrete work for the playground. Please see appendix E for additional information.

Nickol Knoll Golf Club- ADA Pathway

The project consisted of the removal and replacement of the existing asphalt pathway with a new 9' path. This improvement was completed in the fall of 2008. The benefits of this project to NWSRA are as follows: (1) provides an accessible path along north side of the gold course, (2) provides smooth surface condition for easier use, and (3) provides an accessible path to the northern golf holes. The site was not previously accessible, and the primary purpose of installation of 5' of the width can be attributed to accessibility with secondary purposes including equipment accommodation and extracurricular activities (i.e. biking) via additional width not included in the amount estimated/requested. We estimate that 56% of the improvements can be attributed to accessibility, and we are requesting 56%. This includes a percentage of the material cost, demolition, excavation, installation, and restoration of the pathway. Please see appendix F for additional information.

Nickol Knoll Golf Club- ADA Sidewalk

The project consisted of the installation of a new 5' sidewalk along the entrance. These improvements were completed in the fall of 2008. The benefits of this project to NWSRA are as follows: (1) provides an accessible walk up to and into the golf course and (2) provides smooth surface condition for easier use. The site was not previously accessible, and the primary purpose of installation can be attributed to accessibility. We estimate that 100% of the improvements can be attributed to accessibility, and we are requesting 100%. This includes the material cost, demolition, excavation, installation, and restoration of the sidewalk. Please see appendix F for additional information.

Arlington Lakes Golf Club- ADA Pathway

This project consisted of removal and replacement of the asphalt pathway with a new 7' wide concrete pathway. These improvements were completed in the fall of 2008. The benefits of this project to NWSRA are as follows: (1) provides an accessible path from the parking lot to the golf course, (2) provides smooth surface condition for easier use, and (3) provides an accessible path to the southwest golf holes. The site was not previously accessible, and the primary purpose of installation of 5' of the width can be attributed to accessibility with secondary purposes including equipment accommodation and extracurricular activities (i.e. biking) via additional width not included in the amount estimated/requested. We estimate that 71% of the improvements can be attributed to accessibility, and we are requesting 12%. This includes a percentage of the material cost, demolition, excavation, installation, and restoration of the pathway. Please reference Appendix G for additional information.

Pioneer Park Sidewalk- Ball Diamond #1

This project consisted of the installation of a new 5' wide sidewalk and bleacher pads. These improvements were completed in the fall of 2008. The benefits of this project to NWSRA are as follows: (1) provides an accessible path to ball diamond number one, (2) provides smooth surface condition for easier use, and (3) provides an accessible path to the bleacher pads. The site was not previously accessible, and the primary purpose of installation can be attributed to accessibility. We estimate that 100% of the sidewalk and bleacher pads can be attributed to accessibility, and we are requesting 19%. This includes the material cost, demolition, excavation, installation, and restoration of the pathway and bleacher pads. Please note that the capital project total also accounted for ball field fencing. Please refer to Appendix H for additional information.

Carefree Park- New ADA Sidewalk

This project consisted of the installation of a new 5' wide concrete sidewalk. This improvement was completed in the summer of 2008 upon receipt of a registered complaint by a resident. The benefits of this project to NWSRA are as follows: (1) provides an accessible path to the tennis courts, (2) provides smooth surface condition for easier use, and (3) provides an accessible path into the park from the street and existing sidewalk. The site was not previously accessible, and the primary purpose of installation can be attributed to accessibility. We estimate that 100% of the improvements can be attributed to accessibility, and we are requesting 100%. This includes the material cost, demolition, excavation, installation, and restoration of the sidewalk. Please reference Appendix I for additional information.

The Arlington Heights Park District respectfully asks that you review this request and present it with your approving recommendation to the NWSRA Board of Directors. If you have any questions or require additional information, please do not hesitate to contact me at (847) 506-7145

Sincerely,

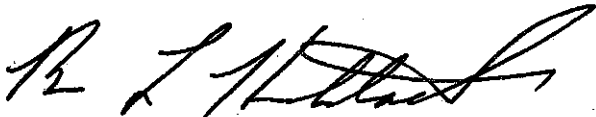

Brian Huckstadt
Director of Parks & Planning
Arlington Heights Park District

Appendix A
Heritage Park – 8' wide pathway & 5' wide walk to new ADA bleacher pads



*Not to scale

Appendix B.1

Becker Park- ADA Playground & 5' wide sidewalk

BERBECKER PARK

BERBECKER PARK PLAYGROUND RENOVATION

(A) OLDER KIDS AREA

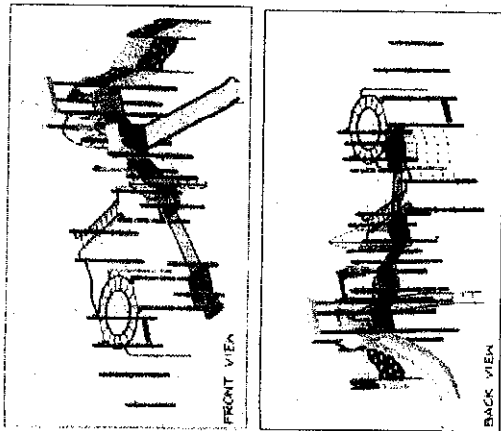

(B) YOUNGER KIDS' AREA

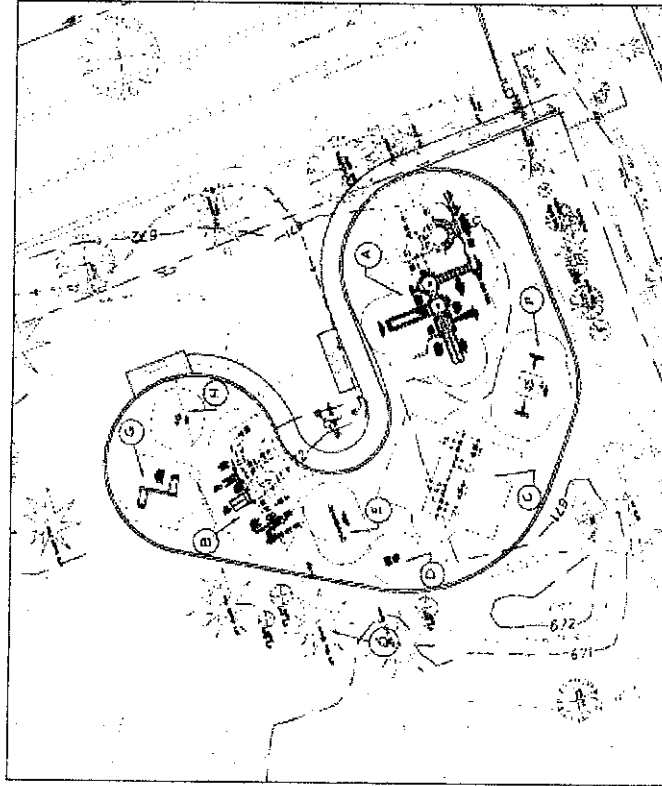
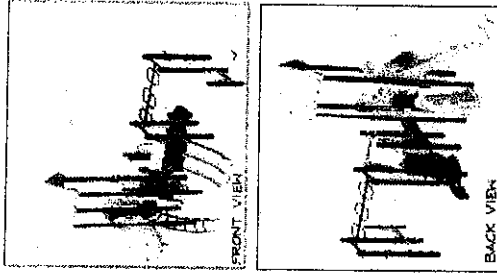

(C) SWINGS

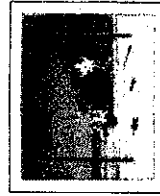

(D) SPINNER



(E) SEESAW



(F) TIRE SWING



- PLAYGROUND KEY
- (A) OLDER KIDS AREA
 - (B) YOUNGER KIDS' AREA
 - (C) 2X SINGLE POST
2-BELT SWING
 - (D) STAND-UP SPINNER
 - (E) SEESAW 4-SEATS
 - (F) TINDER TIRE SWING
 - (G) TODDLER SWING
2 W/ BUCKET
 - (H) HORSE

(G) TODDLER SWINGS

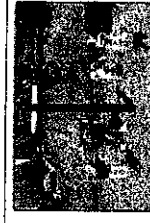

(H) HORSE

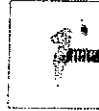

*Not to Scale

Appendix B.2

Berbecker Park- ADA Playground & 5' wide sidewalk



SEPTEMBER 9, 2008

Box 2121
LaGrange, IL 60525
708-579-9055
708-579-0109 (fax)
1-800-526-6197

BERBECKER PARK
ARLINGTON HEIGHTS, IL
OPTION 2

OLDER KIDS AREA

ADA GUIDE LINES
TOTAL ELEVATED PLAYSTRUCTURE COMPONENTS - 8
NO RAMP REQUIRED

	PROVIDED	REQUIRED
PLAYSTRUCTURE COMPONENTS ACCESSIBLE VIA RAMP	N/A	N/A
PLAYSTRUCTURE COMPONENTS ACCESSIBLE VIA TRANSFER	8	4
GROUND LEVEL EVENTS	9	3
GROUND LEVEL TYPES	6	3

INDEPENDENT GROUND LEVEL EVENTS INCLUDED WITH OLDER AREA COUNT:

- 4 SINGLE POSTS SEATS
- 1 ARCH TIRE SWING
- 1 SADDLE SPINNER

YOUNGER KIDS AREA

ADA GUIDE LINES
TOTAL ELEVATED PLAYSTRUCTURE COMPONENTS - 5
NO RAMP REQUIRED

	PROVIDED	REQUIRED
PLAYSTRUCTURE COMPONENTS ACCESSIBLE VIA RAMP	N/A	N/A
PLAYSTRUCTURE COMPONENTS ACCESSIBLE VIA TRANSFER	5	3
GROUND LEVEL EVENTS	7	2
GROUND LEVEL TYPES	6	2

INDEPENDENT GROUND LEVEL EVENTS INCLUDED WITH YOUNGER AREA COUNT:

- 2 TODDLER SWING SEATS
- 1 HORSE SPRING RIDER
- 1 SEE SAW 4-SEAT

Appendix B.3

Berbercker Park- ADA Playground & 5' wide sidewalk

MARCH 25, 2009

BERBECKER PARK
ARLINGTON HEIGHTS, IL
OPTION 2

ALUMINUM PLAYBOOSTER W/TENDERDECKS

QTY	NO.	DESCRIPTION	UNIT PRICE	PRICE					
OLDER KIDS AREA									
2	111404B	140 ALUM. POST D.B.	215	\$430.00	2	111404E	118 ALUM. POST D.B.	195	\$1,170.00
2	111404C	132 ALUM. POST D.B.	210	\$420.00	1	111404J	78 ALUM. POST D.B.	195	\$195.00
9	111404E	118 ALUM. POST D.B.	195	\$1,755.00	4	111403A	182 ALUM. POST FOR ROOF	350	\$1,040.00
1	111404F	108 ALUM. POST D.B.		\$190.00	1	152811E	CURVED TRANSFER MOC LEFT		\$1,111.00
2	111404H	92 ALUM. POST D.B.	175	\$360.00	2	111228A	SQUARE TENDERDECK	810	\$1,220.00
4	111403A	182 ALUM. POST FOR ROOF	280	\$1,040.00	1	118110A	SQUARE POLY ROOF CUST LOGO		\$760.00
4	111228A	SQUARE TENDERDECK	810	\$2,440.00	1	152554A	STORE FRONT PANEL		\$365.00
1	112471A	TRANSFER STEP		\$320.00	1	123501E	DOUBLE POLY SLIDE 32 DECK		\$1,180.00
1	12818A	SQUARE PEAK TILE ROOF CUST LOGO		\$65.00	1	130795Z	DOUBLE SWIRL POLY SLIDE 78 DECK		\$1,145.00
1	16244A	PIPE BARRIER		\$65.00	1	122514E	LOOP P. FENCE 58 DECK		\$215.00
1	132033B	ROLLER SLIDE 56 DECK		\$65.00	1	132202P	S. WIND. CLIMBER 1.50ES		\$615.00
1	130330A	DOUBLE SWOOSH POLY SLIDE 72 DECK		\$615.00	1	21802A	HAND HOLD EGG LIFT		\$120.00
1	152444A	PEEK & CREEP W/SUICIDBALLS		\$1,400.00	1	119605Z	2 SHIELD BEAM COIF HORIZONTAL 5'x4'		\$620.00
1	150373B	CASCADE CLIMBER 72 DECK DB		\$1,330.00	1	141898B	PULL/HANDLOOP ASSEMBLY 32 DECK		\$525.00
1	144432A	CORX SCREW W/FERM 32 DECK		\$1,825.00	1	162807B	DECK LINK W/BARRIERS (2 STEPS)		\$1,200.00
1	22800A	RST NET CLIMBER		\$450.00	1	20710A	DISC CLIMBER 8'D.B.		\$175.00
1	142812A	SKY PALE CLIMBER 72 DECK D.B.		\$1,735.00	TOTAL			\$60,040.00	
1	11357A	CHINNING BAR		\$325.00					
1	120301A	GRAB BAR		\$110.00					
2	111276A	HANDLOOP ASSEMBLY	135	\$270.00					
1	11357B	TURNING BAR		\$305.00					
1	142831A	2 CIRCULAR HORIZONTAL LADDER		\$2,060.00					
1	141898B	PULL/HANDLOOP ASSEMBLY 32 DECK		\$525.00					
1	141987B	ACCESS/LANDING ASSEMBLY 18 DECK		\$855.00					
1	118430A	O'VERHEAD PARALLEL BARRIERS LAD		\$735.00					
1	152008A	DECK LINK W/HANDRAILS (1 STEP)		\$790.00					
1	152008B	DECK LINK W/HANDRAILS (2 STEPS)		\$915.00					

ALSO:

1	100019B	HORSE (PERMALENE) D.B.		\$720.00
1	148837A	SEESAW 4 SEAT 3'D.B.		\$2,035.00
1	156077A	STAND-UP SPINNER DB ONLY		\$1,035.00
1	120801A	ARCH TIRE SWING DB ONLY		\$2,435.00
1	122837A	SGL POST SWING UNCOATED		\$970.00
1	122838A	SGL POST (ADDTL. 2 PLY) UNCOATED		\$765.00
1	117882B	TODDLER SWING		\$1,080.00

*Red = above ground component accessible to the transfer point
*Yellow = ground level ADA components

A. andix C.1
Patriots Park- ADA Playground & 5' wide sidewalk

PATRIOTS PARK

A COMPOSITE PIECE- AGES 5-12

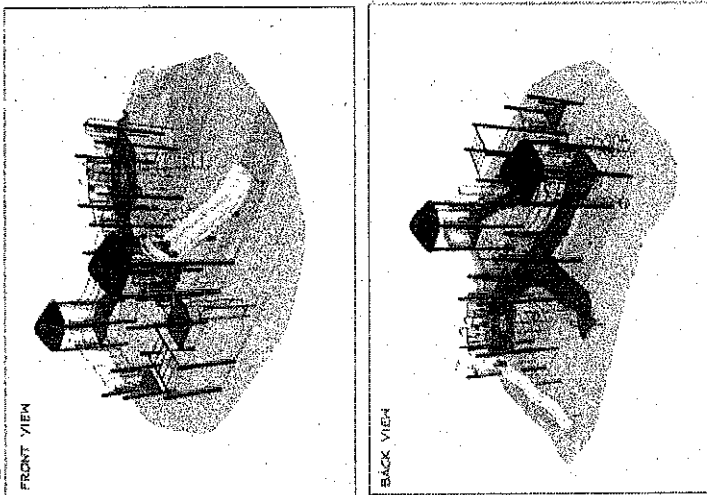

B COMPOSITE PIECE- AGES 2-5

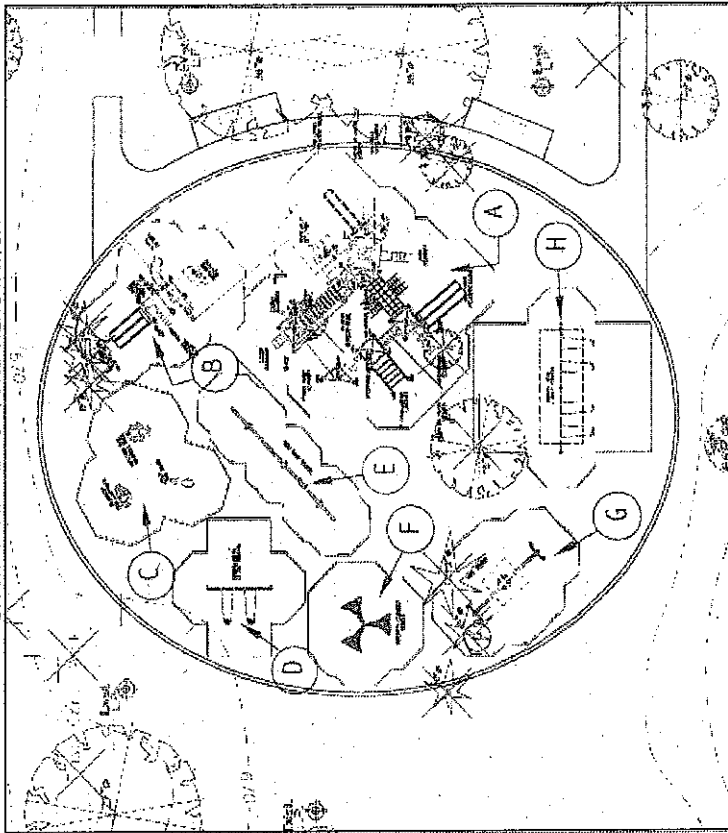
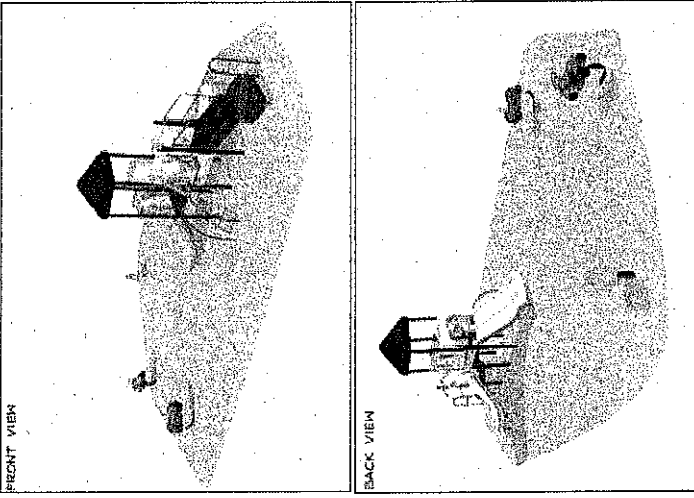

PLAYGROUND KEY:

- (A) COMPOSITE PIECE- AGES 5-12
- (B) COMPOSITE PIECE- AGES 2-5
- (C) BUMBLE BEE
LANT BUG
SNAIL
- (D) SWING WITH 2 TOT SEATS
- (E) SEE SAW SNAKE
- (F) INFINITY CLIMBER TRIPLE
- (G) TIRE SWING
- (H) SWING WITH 4 BELT SEATS

*Not to Scale

Appendix C.2

Patriots Park- ADA Playground Improvements

Patriots Park Accessibility Analysis

Qty. Part Number Part Description

1) School Age Equipment

1	200009983	POLE SLIDE 1625 MM/44" KB	\$535.00
1	200007001	CLIMBER LOOP 1220 MM/48" KB	\$622.00
1	200007059	BRIDGE CLATTER 3440 MM/8' W/GUARD RAILS	\$2,319.00
1	200007704	HOWR BAG F/CLAMP ELIMINATION (MM)	\$28.00
4	200113798	KB 138" GALV POST WITH PLASTIC CAP	\$818.00
10	200138113	KB 4185/184" GALV POST WITH PLASTIC CAP	\$2,710.00
2	200139593	DECK SQUARE KB	\$1,262.00
1	200139888	DECK 1/2 SQUARE KB	\$788.00
1	200162289	TRANSFER STATION 1220 FIBR	\$1,773.00
1	200109866	KB SAFETY RAIL DKMT	\$328.00
1	200125540	STEPS DECK/DECK 610 MM WISFTY RAILS FIK	\$988.00
1	200200265	CLIMBER CURLY 1220MM/48" KB (2004)	\$609.00
1	200200819	CLIMBER FAN KB 1630MM FLG DK EDGE	\$1,097.00
1	200200838	KB SAFETY RAIL F/HALF SQ DK W/WHL DKMT	\$735.00
1	200201043	SLIDE WAVE FIKB 1830 MM/72"	\$1,154.00
1	200201078	LARGE SQ DK WIRUNG CLIMB 72"	\$2,683.00
2	200246768	ASSY RAIL MT ALUM STEER WHL RED	\$328.00

ADA Guidelines

Total Elevated Playstructure Components-18

No Ramp Required

Patriots Park Playground Area (Little Tikes Commercial)

Total Elevated Playstructure Components-18

No Ramp Required

Playstructure Equipment Accessible Via Ramps	N/A
Playstructure Equipment Accessible Via Transfer	
Ground Level Events	12
Ground Level Types	13
	7

Provided

Accessible School Age Total \$18,797.00

2) Tot Structure Equipment

2	100005374	PB SQUARE DECK	\$936.00
1	200054512	CLIMBER AR CHN. PB 48"1220 SAFETY LOOP	\$787.00
1	200080795	TRANSFER STATION 915 MM F/PB	\$1,696.00
1	200084815	SLIDE ELBOW 70 DES F/PB	\$840.00
2	200101172	POST W/CAP F/PB 2895/118 3'	\$256.00
2	200151173	POST W/CAP F/PB 3295/128 5'	\$256.00
2	200101175	POST W/CAP F/PB 3680/157 1'	\$312.00
1	200107818	PB PANEL WINDOW W/ALEXAN KV TM	\$369.00
1	200109105	PB SQUARE ROOF W/IRD HOLES	\$548.00
1	200200330	SLIDE DBL W/D PLASTIC 48"1220MM PB (2004	\$836.00
1	200201291	PB CHIN UP PANEL	\$1,403.00

Accessible Tot Structure Total

\$8,119.00

3) Independent Events

1	200007469	SNAKE SEE-SAW W/POSTS	\$4,233.00
1	200088823	SWING 2-BAY MP 2440(8') W/4 BELT (3200)	\$1,658.00
1	200096028	SWING 1-BAY MP 2440(8') W/2 TOT (3200)	\$1,188.00
1	200200178	INFINITY CLIMBER TRI. GROUND-TO-POST F.	\$2,951.00
1	200200728	SWING TIRE 4877MM/10'SS W/SURIED POSTS	\$2,753.00
1	M00000950	SPRING RIDER LADYBUG SCARLET	\$1,028.00
1	M00000981	SPRING RIDER BUMBLEBEE NECTAR	\$880.00
1	M00000982	SPRING RIDER SNAIL LOLA	\$579.00

Accessible Independent Event Total

\$15,519.00

NORTH SCHOOL PARK

NORTH SCHOOL PARK PLAYGROUND RENOVATION

PLAYGROUND KEY	
(A)	COMPOSITE PIECE
(B)	TODDLER SING TABLE WITH 2 PULL BUCKETS
(C)	HORSE
(D)	BIRD

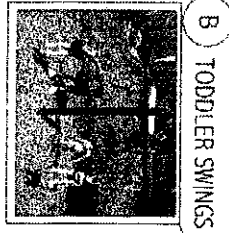
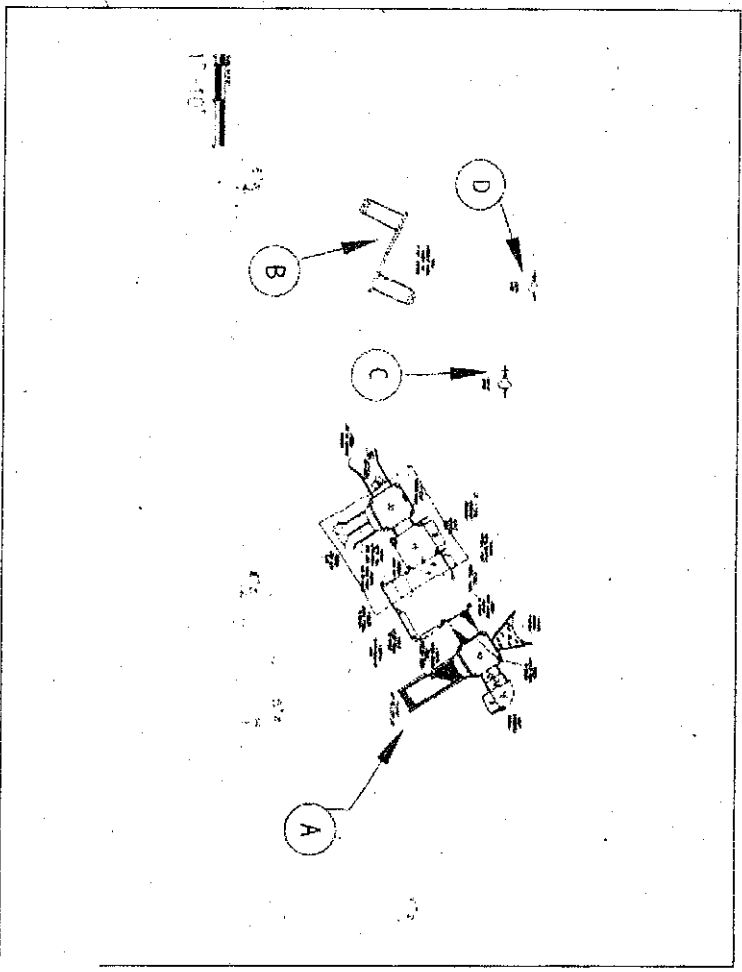

*Not to Scale

(A) COMPOSITE PIECE

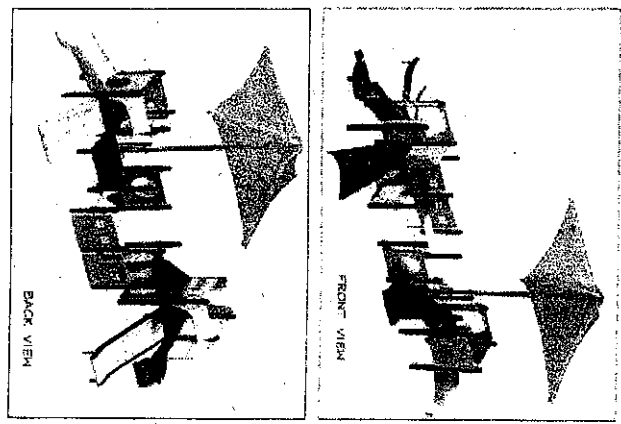

TO BE COMPLETED EARLY FALL 2008
 PLEASE VISIT WWW.AHPD.ORG FOR UPDATES

Appendix E.2
North School Park- ADA Playground

MARCH 25, 2008

NORTH SCHOOL
ARLINGTON HEIGHTS, IL
OPTION 1
ALUMINUM PLAYBOOSTER W/TENDERDECKS

QTY.	NO.	DESCRIPTION	UNIT PRICE	PRICE	Price ADA	Total ADA
4	111404E	116 ALUM. POST D.B.	195	\$780.00	\$0.00	\$0.00
4	111404F	108 ALUM. POST D.B.	190	\$780.00	\$0.00	\$0.00
1	111404G	100 ALUM. POST D.B.		\$185.00	\$0.00	\$0.00
3	111404H	92 ALUM. POST D.B.	175	\$625.00	\$0.00	\$0.00
2	111404I	84 ALUM. POST D.B.	185	\$330.00	\$0.00	\$0.00
3	111404J	76 ALUM. POST D.B.	155	\$465.00	\$0.00	\$0.00
1	154883D	221 STEEL POST FOR ROOF		\$470.00	\$0.00	\$0.00
1	152911B	CURVED TRANSFER MOD LEFT		\$1,625.00	\$0.00	\$0.00
1	121948A	KICK PLATE FOR 8 RISE		\$71.00	\$0.00	\$0.00
3	111228A	SQUARE TENDERDECK	810	\$1,830.00	\$0.00	\$0.00
1	112471A	TRANSFER STEP		\$320.00	\$0.00	\$0.00
1	122187A	TRIANGULAR TENDERDECK 90 DEG		\$505.00	\$0.00	\$0.00
1	154884A	COOLTOPPER SINGLE POST		\$1,985.00	\$0.00	\$0.00
1	115223A	BUBBLE PANEL ABOVE DECK		\$485.00	\$0.00	\$0.00
1	115228A	DRIVER PANEL ABOVE DECK		\$510.00	\$510.00	\$510.00
1	115235A	HOUSE PANEL ABOVE DECK		\$405.00	\$0.00	\$0.00
2	115235B	HOUSE PANEL BELOW DECK	510	\$1,020.00	\$1,020.00	\$1,020.00
1	115257A	STORE FRONT PANEL		\$365.00	\$365.00	\$365.00
1	130586A	TABLE PANEL		\$640.00	\$640.00	\$640.00
1	123333A	ROLLERSLIDE 40 DECK		\$1,460.00	\$4,460.00	\$4,460.00
1	145836A	LAVA RUN SLIDE PB D.B.		\$1,000.00	\$1,000.00	\$1,000.00
1	143189B	CONICAL CLIMBER 40 DECK		\$2,010.00	\$2,010.00	\$2,010.00
1	145835A	CRITTER CANYON PB D.B.		\$955.00	\$955.00	\$955.00
1	130907A	GRAB BAR		\$110.00	\$110.00	\$110.00
2	111276A	HANDLOOP ASSEMBLY	135	\$270.00	\$0.00	\$0.00
1	120818A	PLAYSTRUCTURE SEAT		\$220.00	\$0.00	\$0.00
1	119647A	WIRE CRAWL TUNNEL BELOW DECK		\$1,610.00	\$1,610.00	\$1,610.00
1	152907A	DECK LINK W/BARRIERS (1 STEP)		\$820.00	\$0.00	\$0.00
		SUBTOTAL		\$24,711.00	\$0.00	\$0.00
ALSO:						
1	100016B	BIRD (PERMALENE) D.B.		\$730.00	\$730.00	\$730.00
1	100016B	HORSE (PERMALENE) D.B.		\$720.00	\$720.00	\$720.00
1	117962B	TODDLER SWING		\$1,080.00	\$1,080.00	\$1,080.00
		SUBTOTAL		\$2,530.00	\$2,530.00	\$2,530.00
		EQUIPMENT TOTAL		\$27,241.00	\$15,210.00	\$55,839%

Appendix F
Nickol Knoll
Golf Club -
9' wide path
5' wide walk



*Not to Scale

Appendix G
Arlington Lakes Golf Club- 7' wide pathway



*Not to Scale

Appendix H
Pioneer Park- 5' wide sidewalk & bleacher pads
Ball Diamond #1

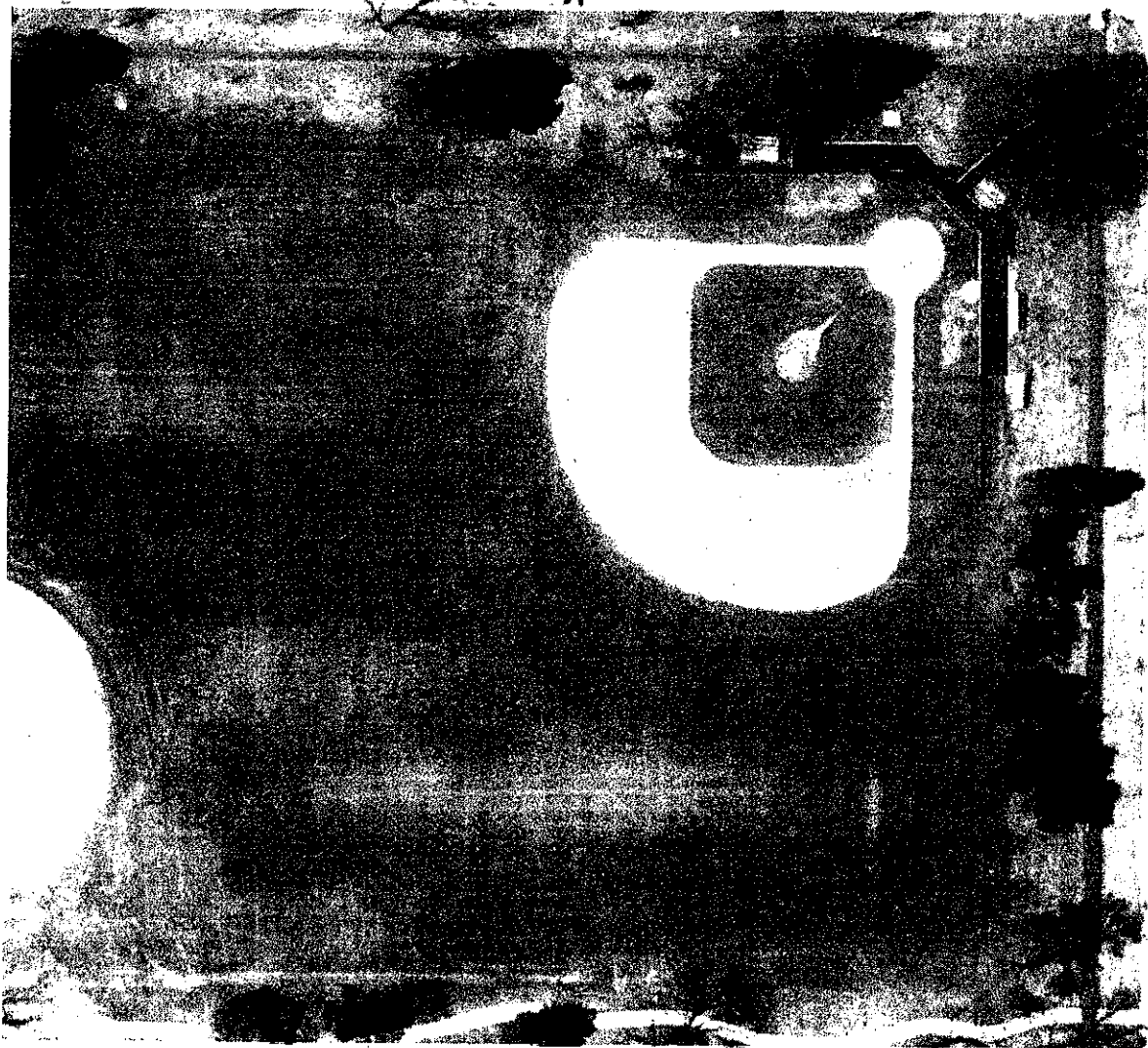

*Not to Scale

Appendix I
Carefree Park- 5' wide sidewalk

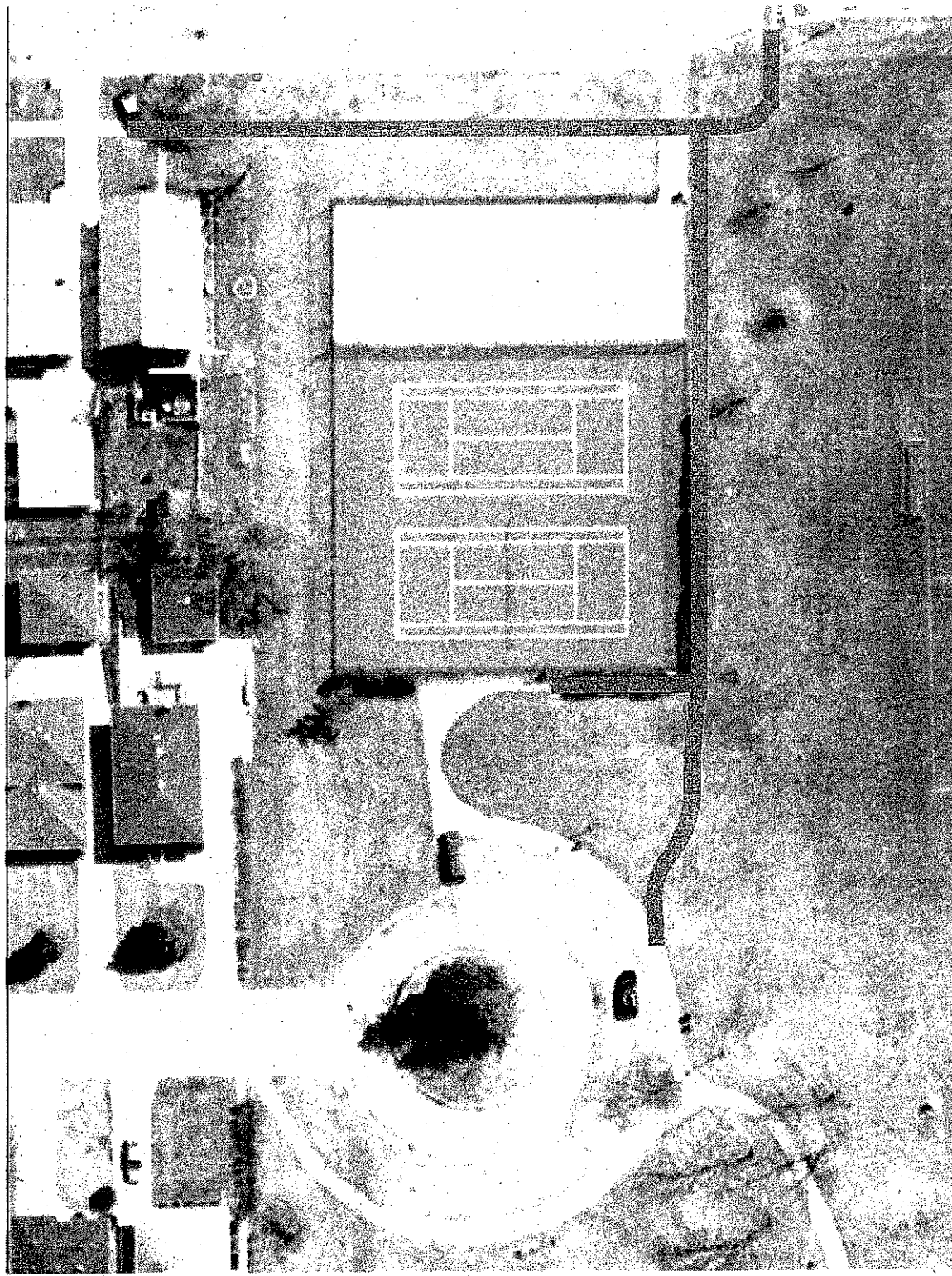

*Not to Scale

Enriching People's Lives!



Hanover Park

Park District

.....
hpparks.org 630.837.2468

1919 Walnut Ave. Hanover Park, IL 60133

September 21, 2009

Susie K. Julison
Executive Director
Northwest Special Recreation Association
3000 Central Road-Suite 205
Rolling Meadows, IL 60008

Re: Improvements proposed to be financed using special recreation levy

Dear Ms. Julison:

The Hanover Park Park District hereby notifies and requests approval of the NWSRA Board of Directors for the proposed expenditure of funds from the District's special recreation levy, to pay the cost of the following improvement(s).

The Hanover Park Park District owns and operates the Centre Court Athletic Club. The Club's fitness area currently owns thirty-one (31) pieces of exercise equipment that are not rated as inclusive / accessible for disabled individuals.

Staff has formulated a listing of members / users with disabilities composed of fifteen (15) individuals with varying degrees of disabilities, one of which is wheelchair bound. Due to HIPA restrictions, staff is unable to extensively survey our membership.

The Hanover Park Park District proposes the purchase of ten (10) replacement pieces of fitness equipment to realize a one third (1/3) ratio of total pieces of fitness equipment rated as inclusive / accessible.

The estimated cost of the improvements is \$46,715.22. The improvements are expected to be substantially complete by January 31, 2010. Anticipated benefits of the project to NWSRA are as follows:

The addition of this equipment will provide accessible equipment for utilization of NWSRA programs.

The District respectfully requests that you review this request and present it with your approving recommendation to the NWSRA Board of Directors. If you have any questions or require additional information, please do not hesitate to contact me.

Very truly yours,

Jeffrey Acks
Director of Park and Recreation
HANOVER PARK PARK DISTRICT

The district proposes to purchase the following equipment:

Strength: CYBEX Total Access

Leg Curl \$2661.75

Specifications

Model: #14061

Standard Stack: 165lbs. (75kg)

Heavy Stack: 205lbs. (93kg)

Dimensions: 56"L (142 cm) x 39"W (99 cm) x 64"H (162 cm)

Features

- Five Position Adjustable Calf Pad accommodates different lower leg lengths.
- Large Seat Base facilitates easy transfer from a wheelchair.
- Thigh Pad Hold-Down Mechanism allows the thighs to be secured above the knee for reduced shear force on the knee joint while keeping it in a stable position.
- Raised Numbers and Large Font on ROM. Start positions are easy to adjust/identify for visually impaired and older users.
- Start ROM on Cam Synchronised with User. Regardless of the starting position, the CYBEX Patent Pending ROM adjustment ensures the cam moves to maintain the correct strength profile for the user.
- User Accessible Weight Stack offers ease of weight selection from seated exercise position.
- Weight Stack with Low Start Weight and Integral Three-Position Twist Select systems offering 2.5 kg increments is suitable for inexperienced and older users.

Leg Press \$3604.25

Specifications

Model: #14040

Standard Stack: 405lbs. (184kg)

Heavy Stack: 505lbs. (229kg)

Dimensions: 99"L (252 cm) x 41"W (104 cm) x 78"H (198 cm)

Features

- Centrally Mounted Seat Adjustment with lever which can be easily operated with either right or left hand. No grip is required.
- Instructions at Seated User Height ensures ease of reading from a seated position by all users including those in wheelchairs.
- Large Foot Plate for stability when exercising.
- Laser Cut Numbering for seat adjustments, which can be viewed while seated. The large numbers are easily identified by visually impaired users.
- Side Handles below seat height for ease of transfer.
- Large Backrest and Seat Base offer more stability and confidence for older users as well as those with reduced balance.
- User Accessible Weight Stack offers ease of weight selection from seated exercise position.

- Weight Stack with Low Start Weight and Integral Three-Position Twist Select systems offering 2.5 kg increments is suitable for inexperienced and older users.

Row \$2596.75

Specifications

Model: #14030

Standard Stack: 245lbs. (111kg)

Heavy Stack: 305lbs. (138kg)

Dimensions: 51.25"L (130 cm) x 45.5"W (116 cm) x 76"H (193 cm)

Features

- Choice of Upper and Lower Handle Positions caters for wheelchair users who cannot adjust seat height, shorter users and those with reduced balance, who can then maintain full foot contact with the floor.
- Eight Position Reversible Chest Pad ensures a full range of movement is achieved by both tall and short users.
- Large Seat Base offers more stability and confidence for older users as well as those with reduced trunk stability.
- Top Mounted Input Arm Pivot position maintains the natural body movement of a gradually descending hand position during the movement.
- User Accessible Weight Stack offers ease of weight selection from seated exercise position.
- Weight Stack with Low Start Weight and Integral Three-Position Twist Select systems offering 2.5 kg increments is suitable for inexperienced and older users.

Chest Press \$2661.75

Specifications

Model: #14000

Standard Stack: 245lbs. (111kg)

Heavy Stack: 305lbs. (138kg)

Dimensions: 59.5"L (151 cm) x 43.25"W (110 cm) x 68.63"H (174 cm)

Features

- Locking Plunger Adjustment on swing away seat allows easy access for wheelchair users and one-handed seat adjustment for users with limited mobility.
- Adjustable Input Arm enables a non-stressed start position for users with limited shoulder flexibility and wheelchair users.
- Upright Seat Back Support (10°) allows wheelchair users to maintain stability with heavier weights.
- User Accessible Weight Stack offers ease of weight selection from seated exercise position.
- Weight Stack with Low Start Weight and Integral Three-Position Twist Select systems offering 2.5 kg increments is suitable for inexperienced and older users.
- Top Mounted Exercise Pivot Position ensures correct biomechanical chest press movement from the hinged lever arm pivoting at the top.

- Choice of Upper and Lower Handle Positions caters for wheelchair users, shorter users and those with reduced balance.

Overhead Press \$2596.75

Specifications

Model: #14010

Standard Stack: 165 lbs. (75 kg)

Heavy Stack: 205 lbs. (93 kg)

Dimensions: 63.75"L (162 cm) x 59.38"W (151 cm) x 63.88"H (162 cm)

Features

- Swing Away Seat with locking plunger adjustment allows easy access for wheelchair users and one-handed seat adjustment for users with limited mobility.
- Choice of Upper and Lower Handle Positions caters for wheelchair users, shorter users and those with reduced balance.
- Counterbalanced Input Arm with 2.5 kg start weight. This allows all users a light start weight for single arm (unilateral) use benefiting inexperienced and disabled users, including amputees and people who have had a stroke.
- Large Type Instructions with clear fonts, including written and graphic instructions, to suit all users.
- User Accessible Weight Stack offers ease of weight selection from seated exercise position.
- Weight Stack with Low Start Weight and Integral Three-Position Twist Select systems offering 2.5 kg increments is suitable for inexperienced and older users.
- Raised Weight Stack iconography for visually impaired users to identify weight stack positions.

Cardio: CYBEX Total Access

Treadmill \$9954 (total for two)

Specifications

Model: #445Ti

Speed Range: 0.5 mph – 11 mph (0.8 kph – 17.6 kph)

Elevation Range: 0% - 15%

Running Surface: 20" x 60" (51 cm x 152 cm)

Dimensions: 72" L (183 cm) x 32" W (81 cm) x 61" (155 cm)

Maximum User Weight: 350 lbs. (181 kg)

Features

- Multiple Belt Logos ensure that one logo is always completely visible at all times so that visually impaired and other users can recognize if the belt is moving.
- Raised Console Iconography and Colour allows easy identification of the main controls both by colour, large buttons and text for older users, plus raised iconography for visually impaired users.
- Emergency Stop Lanyard provides safe emergency stop for users with limited upper limb function.
- Running Deck and Belt Colour Contrast. This allows users to safely

differentiate between the moving and non moving parts of the treadmill from the static side rails.

ArcTrainer \$8394 (total for two)

Specifications Model: #630AI

Resistance: Up to 900 watts

Stride Length: 24" (61 cm)

Incline Levels: 11

Dimensions: 81" L (206 cm) x 60" H (153 cm) x 38" (96 cm)

at upper hand grips; 28.5" (72 cm) at base

Maximum User Weight: 400 lbs. (181 kg)

Features

- Locking Mechanism for Foot Pedals provides complete stability for users when stepping on and off the equipment.
- Static side Handles offer added stability when mounting, dismounting and exercising.
- Raised Console Iconography and Colour allows easy identification of the main controls both by colour, large buttons and text for older users, plus raised iconography for visually impaired users.
- Large Colour Contrasted Foot Pedals ensure easy identification when mounting and dismounting.

Cardio: Technogym

Upper Body Ergometer \$ 5745

Specifications

Model: Top 700 - Powered

Total no. of programs: 18 *Quick Start, Goals (Time-Distance- Calories), CPR, Profiles (6), Training Zone, Warm-up, Constant Power, Constant Speed, Tests (3)*

Resistance (watt): 25 – 1000

Difficulty Levels: 1 - 30

Dimensions: 26" W x 61" L x 61" H (650 x 1550 x 1540 mm)

Weight: 290 lbs. (130 kg)

Features

- Optimal Warm-up – Improve training effectiveness and prevent injuries by preparing arms and shoulders for resistance training.
- In just 4 minutes, by selecting the Warm-Up function on the display, users will be taken through an exercise routine that prepares for safe and effective training. The progressive resistance increase first lubricates the joints and then progressively engages and warms up all upper body muscles using a forward and backward rotation.
- Rotating Handles to vary the involvement of different muscle groups,

distributing load according to needs and preferences.

- Telescopic Arms for use in all positions and at different heights. This feature enables the user to select the length of the arms and therefore determine the level of involvement of the torso.
- Forward-backward resistance to enable users to achieve a more balanced workout and the total involvement of all shoulder and torso muscles.
- Adjustable Hand Crank height for user comfort and precise fit, as well as a diversified involvement of the different muscle groups.
- Custom Training: The Constant Speed program matches effort at all times by accommodating resistance to variations of force output. Most effectively applied to rehabilitation.
- The only Upper Body Ergometer that provides an extensive library of tests for assessment and evaluation purposes. Tests include Submaximal and Maximal, for the assessment of both aerobic and anaerobic (Wingate Test) levels.
- Fast & Safe Recovery – Perform optimal shoulder and elbow rehabilitation, by carrying out a concentric workout.
- Improve Posture – Develop muscular balance around the spine, shoulder, torso and core stabilizer muscles. The innovative seat angle helps improve stabilization, through promoting a slightly opened pelvis angle.
- Aerobic Conditioning For All – Provide an accessible cardiovascular exercise to temporarily or permanently impaired users.
- Save Time – Perform a complete workout that combines aerobic, toning and strengthening exercises.
- Improve Your Sports Performance – Achieve superior results in those sports that require upper body stamina, strength, power, endurance, speed.

TechnoGym

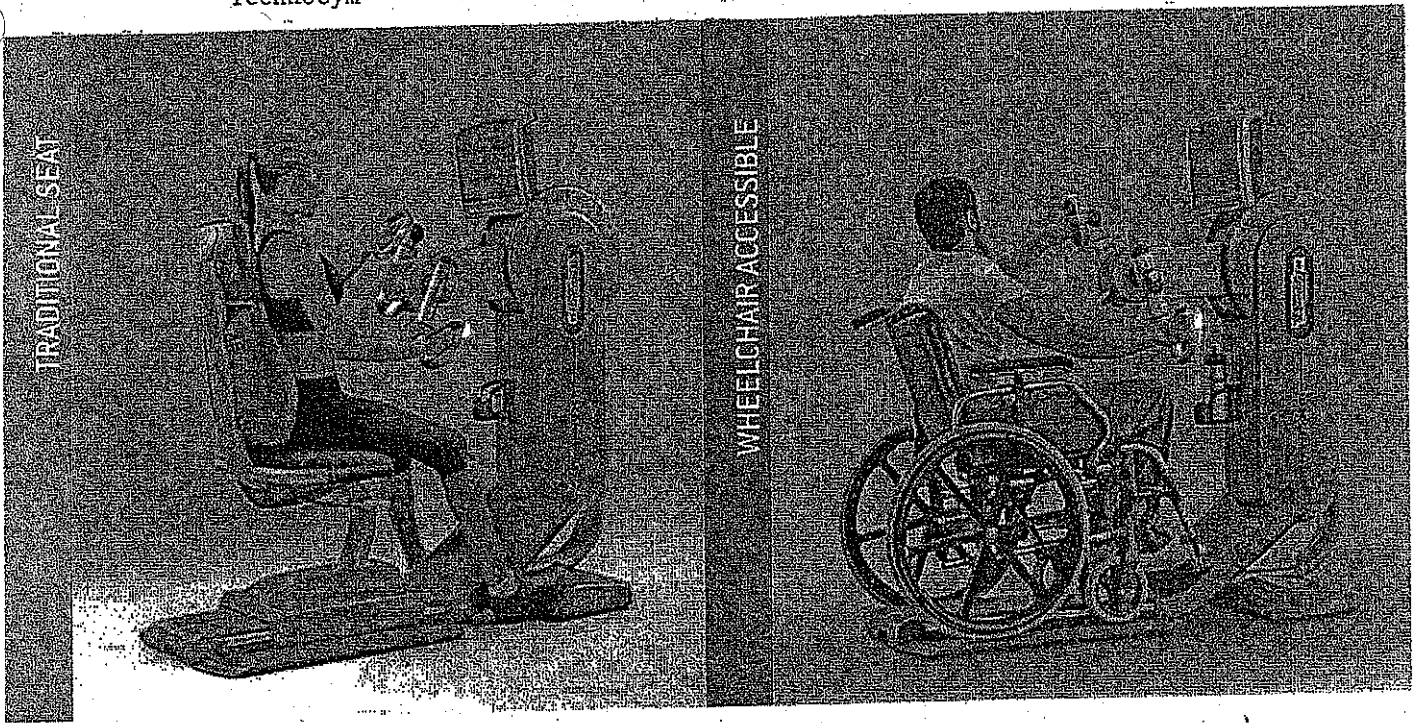

TRADITIONAL SEAT

WHEELCHAIR ACCESSIBLE

EXCITE™ TDP is now available with the new Active Wellness TV™. New features include:

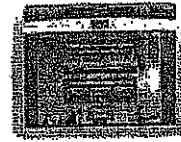
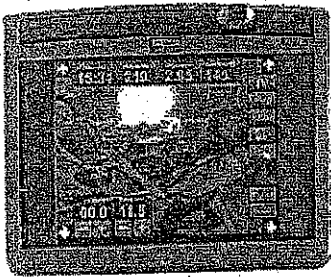

Personal Interface

It recognises the type of user, tuning into likes and needs and provides information & entertainment in the format best suited to the person.

Full Entertainment

The system includes built-in TV & radio and is compatible with iPods. Enjoy safe & easy fun with access to all iPod functions directly from the touch-screen, one-handed docking and iPod charging.

Fast Navigation Interface

Time, stress and energy saving access to workout, number, type and sequence of programmes can be modified dynamically according to system feedback on use.

Context Aware Interface

The buttons appear only in the phase when they are needed or when external devices are detected, so interaction is simple and intuitive.

ACTIVE WELLNESS TV

TOUCH SCREEN (CD-1)

The world's most extensive cardio line: Excite™ Family Feeling



SYNCHRO



BIKE



CARDIO WAVE



TDP



RUN



JOG

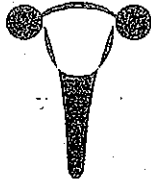

inclusive fitness
accredited item
2007-2010

CYBEX Total Access

Leg Curl | Model 14061

Features

- Five Position Adjustable Calf Pad accommodates different lower leg lengths.
- Large Seat Base facilitates easy transfer from a wheelchair.
- Thigh Pad Hold-Down Mechanism allows the thighs to be secured above the knee for reduced shear force on the knee joint while keeping it in a stable position.
- Raised Numbers and Large Font on ROM. Start positions are easy to adjust/identify for visually impaired and older users.
- Start ROM on-Cam Synchronised with User. Regardless of the starting position, the CYBEX Patent Pending ROM adjustment ensures the cam moves to maintain the correct strength profile for the user.
- User Accessible Weight Stack offers ease of weight selection from seated exercise position.
- Weight Stack with Low Start Weight and Integral Three-Position Twist Select systems offering 2.5 kg increments is suitable for inexperienced and older users.

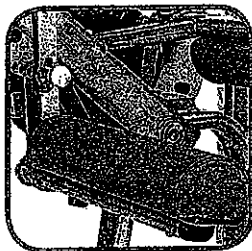
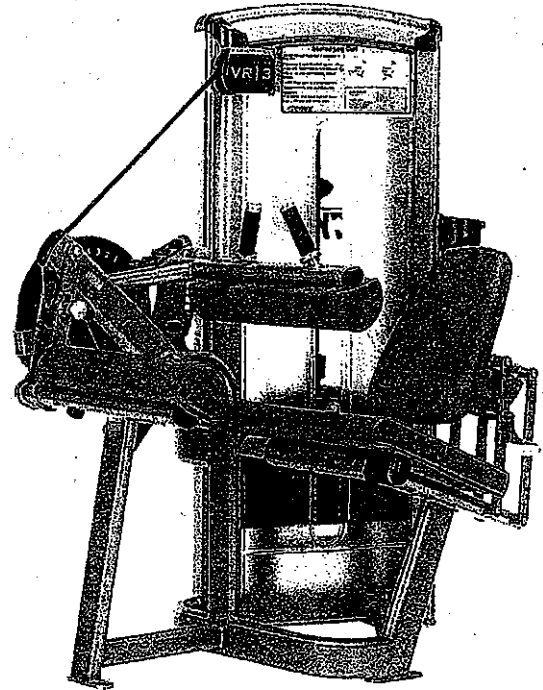

Adjustable calf pad

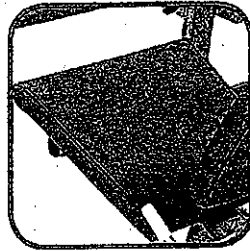

Large seat base

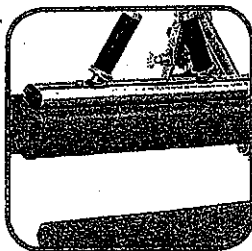

Thigh pad clamping mechanism

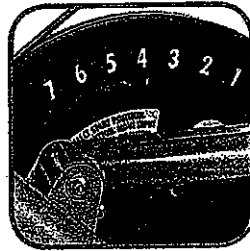

Raised numbering

Specifications

Model Number: 14061

Standard Stack: 165 lbs. (75 kg)

Heavy Stack: 205 lbs. (93 kg)

Dimensions: 56" (142 cm) L x 39"
(99 cm) W x 64" (162 cm) H

Stage 2 IFI accredited equipment

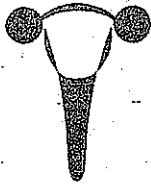

Inclusive fitness
accredited item
2007-2010

CYBEX Total Access

Leg Press | Model 14040

Features

- Centrally Mounted Seat Adjustment with lever which can be easily operated with either right or left hand. No grip is required.
- Instructions at Seated User Height ensures ease of reading from a seated position by all users including those in wheelchairs.
- Large Foot Plate for stability when exercising.
- Laser Cut Numbering for seat adjustments, which can be viewed whilst seated. The large numbers are easily identified by visually impaired users.
- Side Handles below seat height for ease of transfer.
- Large Backrest and Seat Base offer more stability and confidence for older users as well as those with reduced balance.
- User Accessible Weight Stack offers ease of weight selection from seated exercise position.
- Weight Stack with Low Start Weight and Integral Three-Position Twist Select systems offering 2.5 kg increments is suitable for inexperienced and older users.

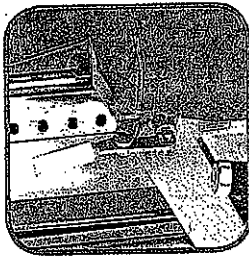
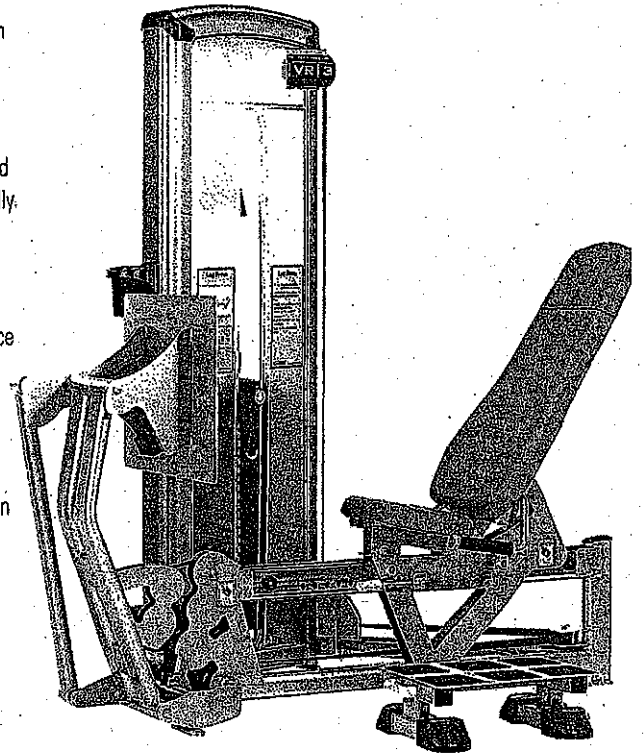

Central seat adjustment

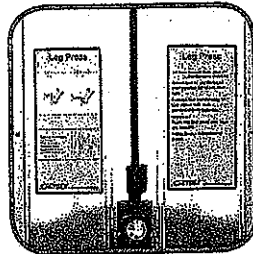

Instructions at seated height

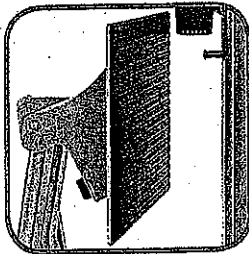

Large foot plate

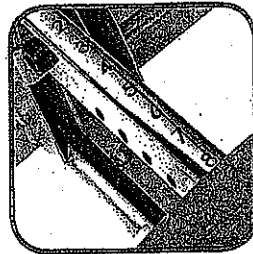

Laser cut numbering

Specifications

Model Number: 14040

Standard Stack: 405 lbs. (184 kg)

Heavy Stack: 505 lbs. (229 kg)

Dimensions: 99" (252 cm) L x 41"
(104 cm) W x 78" (198 cm) H

Stage 2 IFI accredited equipment



inclusive fitness
accredited item
2007-2010

CYBEX Total Access

Row | Model 14030

Features

- Choice of Upper and Lower Handle Positions caters for wheelchair users who cannot adjust seat height, shorter users and those with reduced balance, who can then maintain full foot contact with the floor.
- Eight Position Reversible Chest Pad ensures a full range of movement is achieved by both tall and short users.
- Large Seat Base offers more stability and confidence for older users as well as those with reduced trunk stability.
- Top Mounted Input Arm Pivot position maintains the natural body movement of a gradually descending hand position during the movement.
- User Accessible Weight Stack offers ease of weight selection from seated exercise position.
- Weight Stack with Low Start Weight and Integral Three-Position Twist Select systems offering 2.5 kg increments is suitable for inexperienced and older users.

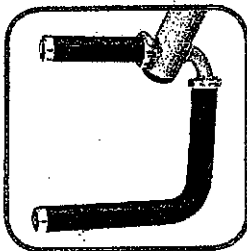
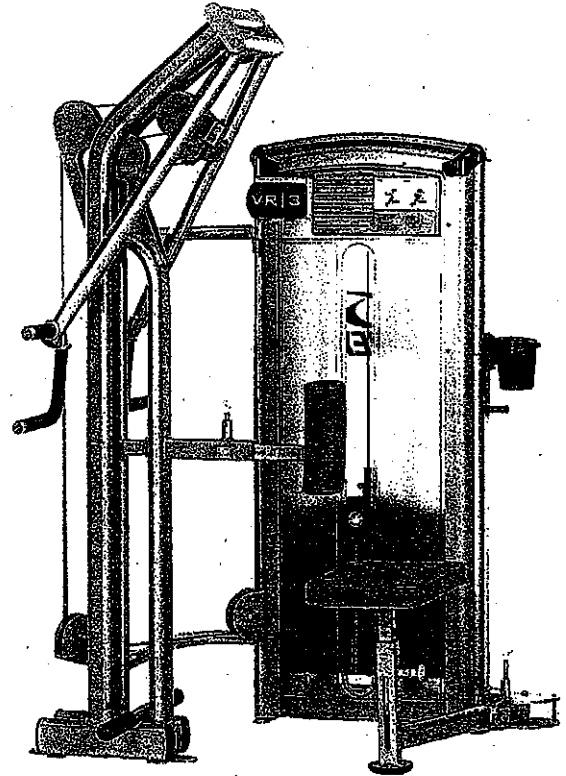

Choice of handle positions

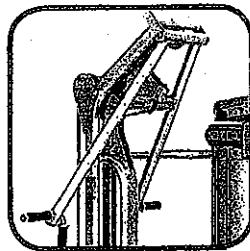

Top mounted input arm pivot

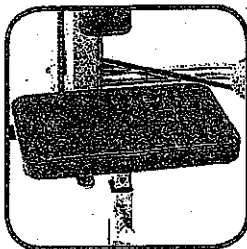

Large seat base

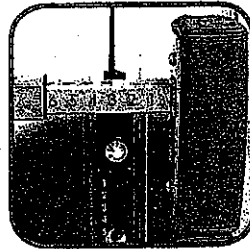

8 position reversible chest pad

Specifications

Model Number: 14030

Standard Stack: 245 lbs. (111 kg)

Heavy Stack: 305 lbs. (138 kg)

Dimensions: 51.25" (130 cm) L x 45.5"
(116 cm) W x 76" (193 cm) H

Stage 2 IFI accredited equipment

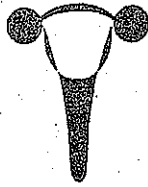

inclusive fitness
accredited item
2007-2010

CYBEX Total Access

Chest Press | Model 14000

Features

- Locking Plunger Adjustment on swing away seat allows easy access for wheelchair users and one-handed seat adjustment for users with limited mobility.
- Adjustable Input Arm enables a non-stressed start position for users with limited shoulder flexibility and wheelchairs users.
- Upright Seat Back Support (10°) allows wheelchair users to maintain stability with heavier weights.
- User Accessible Weight Stack offers ease of weight selection from seated exercise position.
- Weight Stack with Low Start Weight and Integral Three-Position Twist Select systems offering 2.5 kg increments is suitable for inexperienced and older users.
- Top Mounted Exercise Pivot Position ensures correct biomechanical chest press movement from the hinged lever arm pivoting at the top.
- Choice of Upper and Lower Handle Positions caters for wheelchair users, shorter users and those with reduced balance.

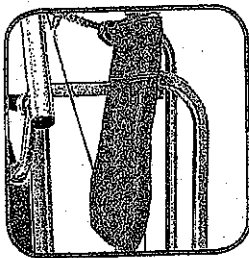
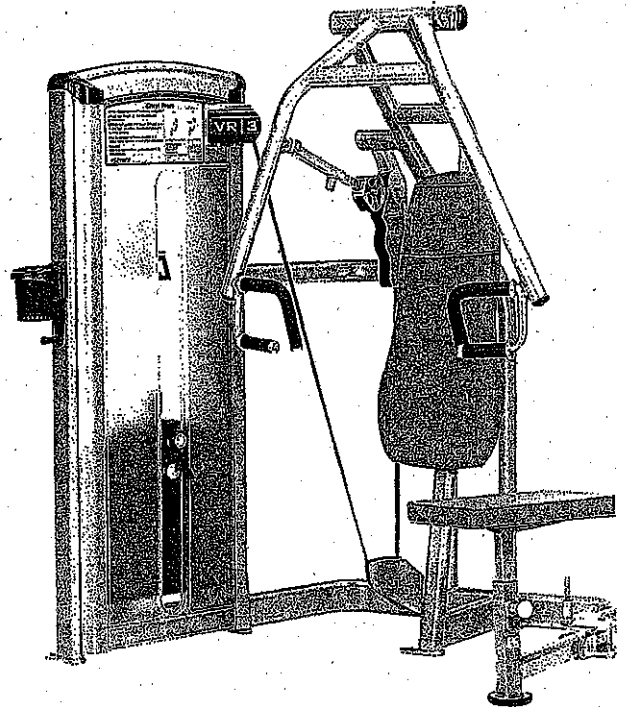

Upright seat back support

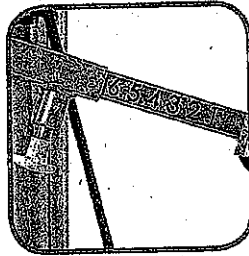

Adjustable input arm

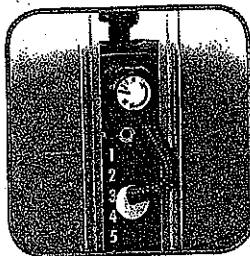

Twist select

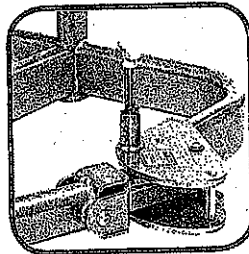

Locking plunger adjustment

Specifications

Model Number: 14000

Standard Stack: 245 lbs. (111 kg)

Heavy Stack: 305 lbs. (138 kg)

Dimensions: 59.5" (151 cm) L x 43.25"
(110 cm) W x 88.63" (174 cm) H

Stage 2 IFI accredited equipment



Inclusive fitness
accredited item
2007-2010

CYBEX Total Access

Overhead Press | Model 14010

Features

- Swing Away Seat with locking plunger adjustment allows easy access for wheelchair users and one-handed seat adjustment for users with limited mobility.
- Choice of Upper and Lower Handle Positions caters for wheelchair users, shorter users and those with reduced balance.
- Counterbalanced Input Arm with 2.5kg start weight. This allows all users a light start weight for single arm (unilateral) use benefiting inexperienced and disabled users, including amputees and people who have had a stroke.
- Large Type Instructions with clear fonts, including written and graphic instructions, to suit all users.
- User Accessible Weight Stack offers ease of weight selection from seated exercise position.
- Weight Stack with Low Start Weight and Integral Three-Position Twist Select systems offering 2.5 kg increments is suitable for inexperienced and older users.
- Raised Weight Stack iconography for visually impaired users to identify weight stack positions.

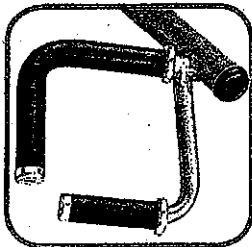
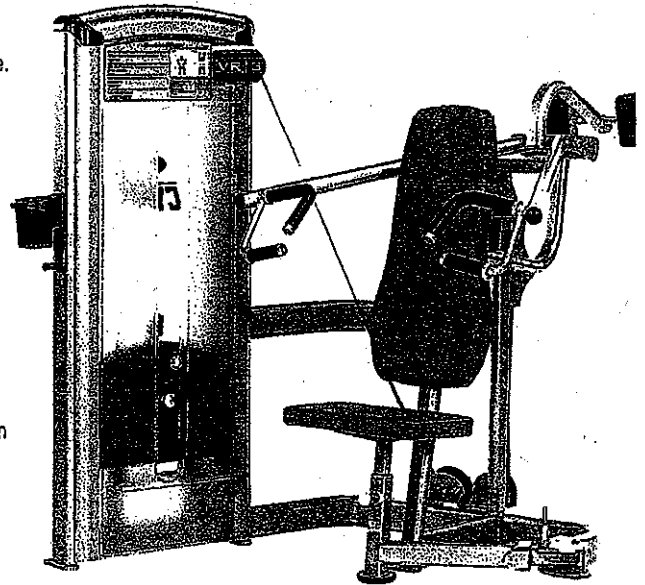

Choice of handle positions

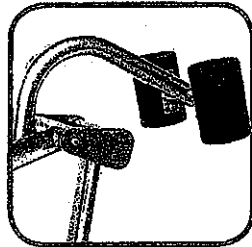

Counterbalanced input arm



Large type instructions

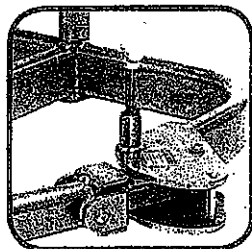

Locking plunger adjustment

Specifications

Model Number: 14010

Standard Stack: 165 lbs. (75 kg)

Heavy Stack: 205 lbs. (93 kg)

Dimensions: 63.75" (162 cm) L x 59.38"
(151 cm) W x 63.88" (162 cm) H

Stage 2 IFI accredited equipment

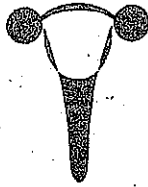

Inclusive fitness
accredited item
2007-2010

CYBEX Total Access

Treadmill | Model 445Ti

Features

- Multiple Belt Logos ensure that one logo is always completely visible at all times so that visually impaired and other users can recognise if the belt is moving.
- Raised Console Iconography and Colour allows easy identification of the main controls both by colour, large buttons and text for older users; plus raised iconography for visually impaired users.
- Emergency Stop Lanyard provides safe emergency stop for users with limited upper limb function.
- Running Deck and Belt Colour Contrast. This allows users to safely differentiate between the moving and non moving parts of the treadmill from the static side rails.

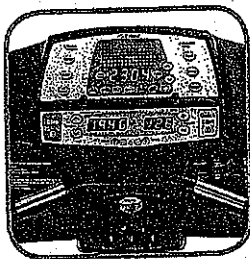
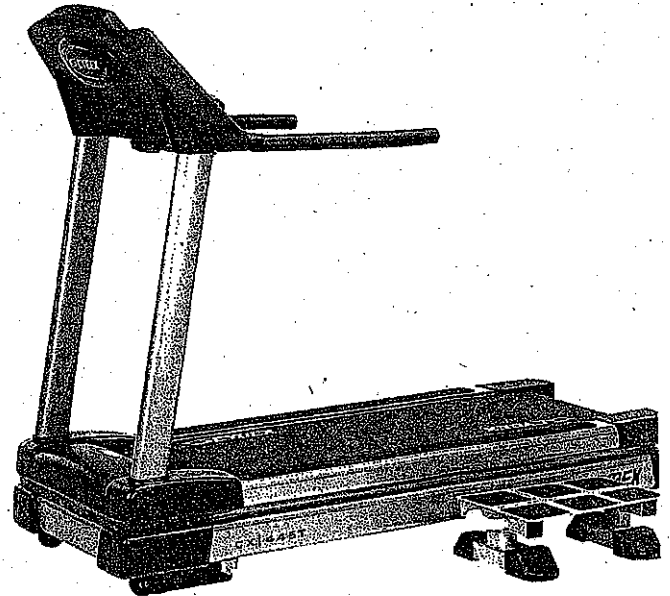

Raised console iconography

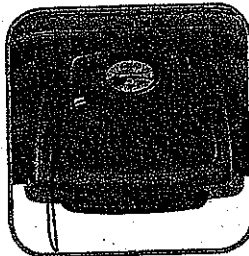

Emergency stop lanyard



Multiple belt logos

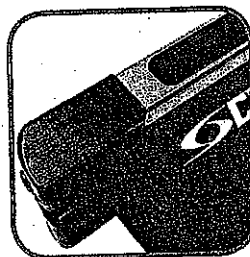

Colour contrasted deck & belt

Specifications

Model Number: 445Ti

Speed Range: 0.5 mph – 11 mph
(0.8kph – 17.6 kph)

Elevation Range: 0% – 15%

Running Surface: 20" x 60"
(51 CM x 152 CM)

Dimensions: 72" (183 CM) L x 32"
(81 CM) W x 61" (155 CM) H

Maximum User Weight: 350 lbs. (181 kg)

Stage 2 IFI accredited equipment



Inclusive fitness
accredited item
2007-2010

CYBEX Total Access

Arc Trainer | Model 630Ai

Features

- Locking Mechanism for Foot Pedals provides complete stability for users when stepping on and off the equipment.
- Static Side Handles offer added stability when mounting, dismounting and exercising.
- Raised Console Iconography and Colour allows easy identification of the main controls both by colour, large buttons and text for older users, plus raised iconography for visually impaired users.
- Large Colour Contrasted Foot Pedals ensure easy identification when mounting and dismounting.

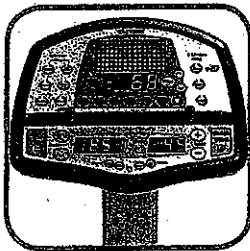
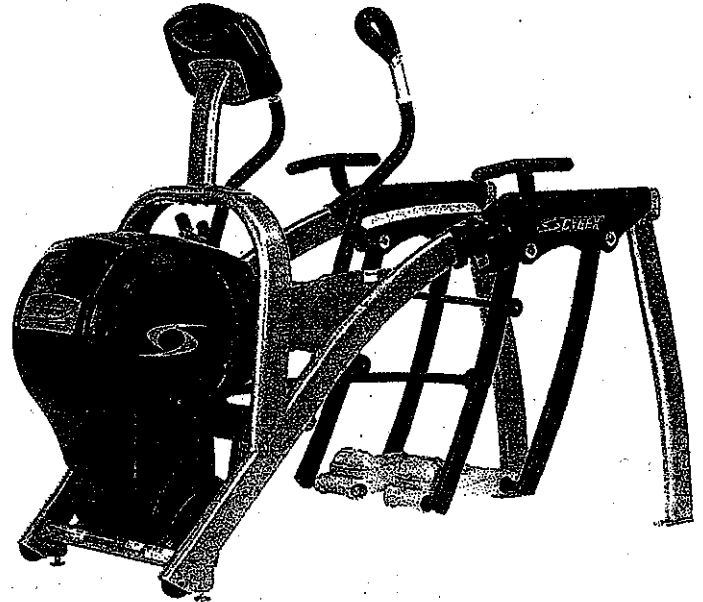

Raised console iconography



Static side handles

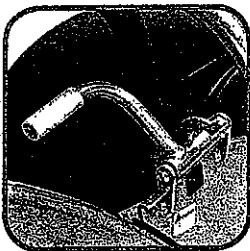

Foot pedal locking mechanism

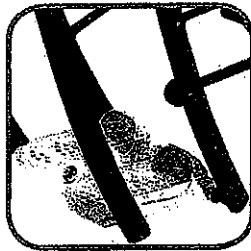

Colour contrasted foot pedals

Specifications

Model Number: 630Ai

Resistance: Up to 900 watts

Stride Length: 24" (61 cm)

Incline Levels: 11

Dimensions: 81" (206 cm) L x 60" (153 cm) H; 38" (96 cm) W at upper hand grips; 28.5" (72 cm) at base

Maximum User Weight: 400 lbs. (181 kg)

Stage 2 IFI accredited equipment

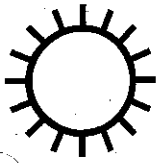

July 9, 2009

Susie K. Julison, Executive Director
NWSRA
3000 Central Rd
Ste 205
Rolling Meadows, IL 60008

RE: ADA Improvements Associated with the Construction of Black Bear Park

Dear Ms. Julison:

The Hoffman Estates Park District is currently constructing a new park to be known as Black Bear Park located west of Essex Drive in Hoffman Estates. Numerous ADA improvements have been planned for this park in an effort to make this facility accessible to everyone. At this time, the Hoffman Estates Park District hereby requests approval from the NWSRA Board of Directors for the following expenditures to be paid from the park district's Special Recreation levy. The proposed improvements will provide direct benefits to the partnership that the park district has with NWSRA and the participants that are served through our joint agreement.

Concrete Surfaces

Remove Curbs and Install Depressed Sections	\$820.00
Install Tactile Plates (3)	297.00
Excavate 5 ft walk	5,500.00
Stone for 5 ft walk	3,400.00
5 ft wide sidewalks (2,200 lin ft)	49,500.00
SUBTOTAL	59,517.00

Asphalt Surfaces

Excavate for 10 ft paths (5 ft ADA portion)	1,250.00
Stone (5 ft ADA portion)	7,000.00
Asphalt 10 ft path (300 lin ft – 5ft wide ADA portion)	2,145.00
Excavate for 8 ft paths (5 ft wide ADA portion)	2,750.00
Stone (5 ft wide ADA portion)	29,500.00
Asphalt 8 ft path (3,900 lin ft – 5 ft wide ADA portion)	27,885.00
SUBTOTAL	70,530.00

Playground	
Supply Equipment (13% of 36,666.)	4,766.58
Spring Toys (100%)	3,700.00
Install Equipment (13% of 17,560.)	2,282.00
ADA Soft Tiles	26,449.20
ADA Mulch Surface	7,081.00
SUBTOTAL	44,278.78
Disc Golf Walking Surface (8) ADA Woodchip Surface	10,360.00
Disc Golf Tees 6 ft x 16 ft	16,640.00
Nature Path ADA Woodchip Surface	2,883.00
SUBTOTAL	29,883.00
TOTAL	204,208.78

The above number reflects actual prices based on unit costs provided by the low bid contractors for this project. Should you or the board have any questions regarding the above numbers, please feel free to contact me at 847-561-2172. In the meantime, the Hoffman Estates Park District appreciates your consideration of this request.

Sincerely,



Gary Buczkowski
 Director of Planning and Development

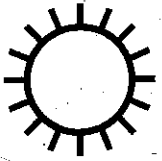

**HOFFMAN ESTATES
PARK DISTRICT**

1685 W. HIGGINS, HOFFMAN ESTATES, IL 60169-2998 • (847) 885-7500
FAX (847) 885-7523

July 9, 2009

Susie K. Julison, Executive Director
NWSRA
3000 Central Rd
Ste 205
Rolling Meadows, IL 60008

**RE: ADA Improvements Associated with High Point 2-5 Year Playground
Replacement**

Dear Ms. Julison:

High Point Park's 2-5 year-old playground was identified in the park district's ADA audit and conformance plan adopted in January 2009 as one of the priority projects within the plan. With this in mind, the Hoffman Estates Park District is currently renovating the parking lot at High Point Park located on Glenlake. As part of those improvements, the existing non-accessible playground is being replaced with a playground that utilizes a transfer point as the means for ADA access. In addition, new ADA compliant loose fill wood chip material is being installed as part of the project.

At this time, the Hoffman Estates Park District hereby requests approval from the NWSRA Board of Directors for the following expenditures to be paid from the park district's Special Recreation levy. The proposed improvements will provide direct benefits to the partnership that the park district has with NWSRA and the participants that are served through our joint agreement.

Playground Equipment costs (13% of 13,903.)	\$1,807.00
Install playground equipment (13% of 3,570.)	464.00
Purchase and install ADA compliant woodchip fall surface (106 cu yd)	2,888.00
TOTAL	5,159.00

The above numbers represent actual unit costs provided by the low bid contractor for this project. Should you or the board have any questions regarding the above numbers, please feel free to contact me at 847-561-2172. In the meantime, the Hoffman Estates Park District appreciates your consideration of this request.

Sincerely,

Gary Buczkowski
Director of Planning and Development

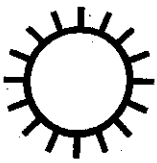

**HOFFMAN ESTATES
PARK DISTRICT**

July 9, 2009

1685 W. HIGGINS, HOFFMAN ESTATES, IL 60169-2998 • (847) 885-7500
FAX (847) 885-7523

Susie K. Julison, Executive Director
NWSRA
3000 Central Rd
Ste 205
Rolling Meadows, IL 60008

RE: ADA Improvements Associated with Pine Park Gate

Dear Ms. Julison:

Pine Park's Dasher Board players accessible gate was identified in the park district's ADA audit and conformance plan adopted in January 2009 as one of the priority projects within the plan. With this in mind, the Hoffman Estates Park District recently replaced the Accessible Gate at Pine Park located on Charleston in Hoffman Estates. The existing gate was 8" above the playing surface and did not allow ADA access to the playing area. The new gate is flush with no obstructions.

At this time, the Hoffman Estates Park District hereby requests approval from the NWSRA Board of Directors for the following expenditures to be paid from the park district's Special Recreation levy. The proposed improvements will provide direct benefits to the partnership that the park district has with NWSRA and the participants that are served through our joint agreement.

Becker ice Arena Products (Gate)	\$1,725.00
Concrete	186.00
In-House Labor	450.00
TOTAL	\$2,361.00

The above numbers represent actual costs expended by the park district for this project. Should you or the board have any questions regarding the above numbers, please feel free to contact me at 847-561-2172. In the meantime, the Hoffman Estates Park District appreciates your consideration of this request.

Sincerely,

Gary Buczkowski
Director of Planning and Development

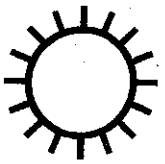

**HOFFMAN ESTATES
PARK DISTRICT**

1685 W. HIGGINS, HOFFMAN ESTATES, IL 60169-2998 • (847) 885-7500
FAX (847) 885-7523

July 9, 2009

Susie K. Julison, Executive Director
NWSRA
3000 Central Road
Ste 205
Rolling Meadows, IL 60008

RE: ADA Improvements Associated with Canterbury Fields

Dear Ms. Julison:

The Hoffman Estates Park District is currently constructing a new parking lot at Canterbury Fields Park located north of Maureen Drive in Hoffman Estates. As part of those improvements, new ADA accessible spaces and ADA accessible walkways will be created according to the specified ADA guidelines. I want to call your attention to the fact that the Village of Hoffman Estates has a unique detail associated with ADA parking spaces whereby concrete curb planters are required at the front of each ADA parking space. This special requirement necessitates the installation of a 6" x 12" barrier curb.

At this time, the Hoffman Estates Park District hereby requests approval from the NWSRA Board of Directors for the following expenditures to be paid from the park district's Special Recreation levy. The proposed improvements will provide direct benefits to the partnership that the park district has with NWSRA and the participants that are served through our joint agreement.

6 x 12 curbing (84 lin ft)	\$1,239.00
5 ft-wide sidewalk (1544 sq ft)	7,334.00
Tactile Plates (14)	1,386.00
Handicapped signs and posts (6)	510.00
Base Stone and Asphalt work for Van Drop-Off Spaces Adjacent to ADA Parking Spaces (6)	2,983.60
Handicapped Stall Painting (6)	450.00
TOTAL	13,902.60

Should you or the board have any questions regarding the above numbers, please feel free to contact me at 847-561-2172. In the meantime, the Hoffman Estates Park District appreciates your consideration of this request.

Sincerely,

Gary Buczkowski
Director of Planning and Development

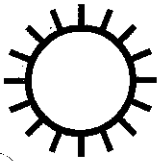

July 9, 2009

Susie K. Julison, Executive Director
NWSRA
3000 Central Rd
Ste 205
Rolling Meadows, IL 60008

RE: ADA Improvements Associated with High Point Park Parking Lot Improvements

Dear Ms. Julison:

High Point Park parking lot was identified in the park district's ADA audit and conformance plan adopted in January 2009 as one of the priority projects within the plan. With this in mind, the Hoffman Estates Park District is currently renovating the parking lot at High Point Park located on Glenlake. As part of those improvements, new ADA accessible spaces will be created according to the specified ADA guidelines. In addition, all walkways leading to the park from Glenlake with cross slopes greater than 2% were replaced with concrete. Also, a ramp from the existing parking lot leading to the playground was replaced so as to eliminate the existing 7.35% running slope.

At this time, the Hoffman Estates Park District hereby requests approval from the NWSRA Board of Directors for the following expenditures to be paid from the park district's Special Recreation levy. The proposed improvements will provide direct benefits to the partnership that the park district has with NWSRA and the participants that are served through our joint agreement.

6" x 12" barrier curb around parking stall planters (92 lin ft)	\$1,472.00
5 ft-wide thickened curb sidewalk (296 lin ft)	8,080.00
Concrete flat work (850 sq ft) behind the handicapped Parking stall planters	5,100.00
Asphalt work for 2 van drop-off spaces adjacent to ADA Parking spaces	259.00
Handicapped painted spaces (2)	40.00
Handicapped signs with posts (2)	170.00
Tactile insert plates (13)	1,287.00
Total	16,408.00

The above numbers represent actual unit costs provided by the low bid contractor for this project. Should you or the board have any questions regarding the above numbers, please feel free to contact me at 847-561-2172. In the meantime, the Hoffman Estates Park District appreciates your consideration of this request.

Sincerely,

Gary Buczkowski
Director of Planning and Development

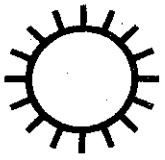

July 9, 2009

1685 W. HIGGINS, HOFFMAN ESTATES, IL 60169-2998 • (847) 885-7500
FAX (847) 885-7523

Susie K. Julison, Executive Director
NWSRA
3000 Central Road
Ste 205
Rolling Meadows, IL 60008

RE: ADA Improvements Associated with Poplar Creek Country Club Parking Lot Improvements

Dear Ms. Julison:

Poplar Creek Country Club parking lot was identified in the park district's ADA audit and conformance plan adopted in January 2009 as one of the priority projects within the plan. With this in mind, the Hoffman Estates Park District is currently renovating the parking lot at Poplar Creek Country Club located on Poplar Creek Drive in Hoffman Estates. As part of those improvements, new ADA accessible spaces will be created according to the specified ADA guidelines. In addition, all walkways leading to the clubhouse and/or driving range with side slopes greater than 2% are being replaced with conforming new concrete.

At this time, the Hoffman Estates Park District hereby requests approval from the NWSRA Board of Directors for the following expenditures to be paid from the park district's Special Recreation levy. The proposed improvements will provide direct benefits to the partnership that the park district has with NWSRA and the participants that are served through our joint agreement.

4' x 12" barrier curb around parking stall planters (505 lin ft)	\$8,080.00
5 ft-wide thickened curb sidewalk (256 lin ft)	7,680.00
7 ft-wide thickened curb sidewalk (68 lin ft)	
(Only 5/7 of the cost charged for this item)	2,040.00
Concrete flat work (2901 sq ft) around driving range and Clubhouse	17,406.00
Asphalt work for 8 van drop-off spaces adjacent to ADA Parking spaces	1,036.00
Handicapped painted spaces (8)	160.00
Handicapped signs with posts (9)	680.00
Tactile insert plates (19)	1,881.00
Total	38,963.00

The above numbers represent actual unit costs provided by the low bid contractor for this project. Should you or the board have any questions regarding the above numbers, please feel free to contact me at 847-561-2172. In the meantime, the Hoffman Estates Park District appreciates your consideration of this request.

Sincerely,

Gary Buczkowski
Director of Planning and Development

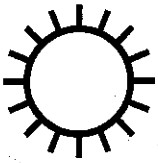

HOFFMAN ESTATES PARK DISTRICT

1685 W. HIGGINS, HOFFMAN ESTATES, IL 60169-2998 • (847) 885-7500
FAX (847) 885-7523

July 15, 2009

Susie K. Julison
Executive Director
Northwest Special Education Association
300 N. Central Rd.
Rolling Meadows, IL 60008

Re: Fitness Equipment at Prairie Stone™ Sports and Wellness Center and Community Center and Ice Arena to be financed using Special Recreation Levy

Dear Ms. Julison:

The Hoffman Estates Park District is requesting approval from the NWSRA Board of Directors for expenditures paid by the Park District for improvements made at Prairie Stone™ Sports and Wellness Center (PSS&WC) and the Community Center and Ice Arena (CCIA). The following is a list of equipment being purchased for these facilities as well as the justifications for these purchases to be financed using the Special Recreation Levy.

LifeFitness 95Ti Treadmill (\$4,700 x 2)	9,400.00
LifeFitness Signature Series Selectorized Strength Equipment:	
Seated Leg Press	4,304.00
Seated Leg Curl	3,150.00
Leg Extension	3,060.00
Glute	2,387.00
Hip Abduction	2,676.00
Hip Adduction	2,676.00
Pull down	2,629.00
Chest Press	2,969.00
Row/Rear Delt	2,787.00
Pec Fly/Rear Delt	2,199.00
Shoulder Press	2,687.00
Assisted Dip/Chin	2,695.00
Triceps Press	2,496.00
Biceps Curl	2,787.00
Torso Rotation	2,869.00
Back Extension	2,779.00
Abdominal	2,687.00
Abdominal Crunch	700.00
Shipping/Installation	6,990.34
Total	\$64,927.34

The 95Ti Treadmills the district is purchasing this year are the same models that were purchased for PSS&WC last year with the moneys received from the Special Recreation Levy. These updated models offer a smoother walking surface and larger display for greater ease of use. The treadmills purchased this year will be sent to CCIA replacing several of the older, out-dated and potentially unsafe treadmills that have been prone to frequent break down. The strength pieces the district is looking to obtain will be replacing many of the LifeFitness strength equipment which was originally purchased in 2000 for PSS&WC. The updated Signature Series from Lifefitness will be better able to meet the needs and/or physical requirements of this facility's users with varying disabilities. These machines utilize a diverging/converging arced motion that provides a more natural path that works with the body and puts less stress on joints. Many of the pieces in the Signature line have independent arms for iso-lateral training giving options for those with strength imbalances between right and left sides. The Signature Strength equipment also uses a turn-dial system for ease in adjustment as well as more gradual weight increases. The weight stacks in this series are easily accessible from a seated position which is helpful to those with movement difficulties. The Signature Series is a line of equipment from LifeFitness' selectorized strength group. Selectorized pieces, as opposed to the FreeMotion pieces that were purchased in recent years, are typically easier to learn to use and as a set, provide a balanced and structured program, which is helpful for beginners. There is generally more back support offered in the design of these pieces and each machine tends to work a single muscle/joint in a single plane of motion which makes it more likely that a given exercises will be performed correctly and safely.

The joint agreement that the Hoffman Estates Park District enjoys with NWSRA has allowed for groups from your organization to utilize our pools, the climbing wall and gyms. We would like to be able to expand upon the programming that is currently available and offer a chance for some of your program participants to learn new leisure skills (i.e., fitness/strength training activities), or perform at a higher level in their current sport. It is very common for individuals within the population served by NWSRA to become de-conditioned due to the lack ease in which facilities or equipment is made accessible. Being able to provide equipment that is user-friendly to those with varying types of disabilities is one way that we can provide additional opportunities for people participating in your organization to exercise in a safe, structured environment.

Jan Redding, a member at PSS&WC, was originally referred to our facility from Athletico Physical Therapy following a hip replacement. Jan's ability to exercise was also greatly effected by an injury to the knee and limited range of motion through the spine. Providing Jan with an exercise program she could perform on her own was challenging, but she has made great gains in her strength, mobility and balance. The Signature Strength series will provide Jan and others like her with similar limitations, a means of exercising with greater ease and efficiency and, subsequently, obtaining better results.

The Hoffman Estates Park District respectfully requests your approval of the purchase of the equipment described above.

If you have any questions, please feel free to contact me.

Sincerely,
Michael R. Kies
Director of Facilities
Hoffman Estates Park District
(847) 285-5422
mkies@heparks.org



Mt. Prospect Park District

Serving Portions of Mt. Prospect • Des Plaines • Arlington Heights • Elk Grove Village

www.mppd.org

ADMINISTRATIVE OFFICES

(847)255-5380
Fax (847)255-1438
1000 W. Central Road
Mt. Prospect, IL 60056

CENTRAL COMMUNITY CENTER

(847)255-5380
Fax (847)392-5726
1000 W. Central Road
Mt. Prospect, IL 60056

RECPLEX

(847)640-1000
Fax (847)364-2824
420 W. Dempster Street
Mt. Prospect, IL 60056

LIONS RECREATION CENTER

(847)632-9333
Fax (847)632-9325
411 S. Maple Street
Mt. Prospect, IL 60056

FRIENDSHIP PARK CONSERVATORY

(847)298-3500
Fax (847)296-2053
395 Algonquin Road
Des Plaines, IL 60018

MT. PROSPECT GOLF CLUB

(847)259-4200
Fax (847)632-9334
600 See-Gwun
Mt. Prospect, IL 60056

GOLF COURSE GARAGE

(847)632-9330
Fax (847)342-9113
600 See-Gwun
Mt. Prospect, IL 60056

LIONS GARAGE

(847)632-9320
Fax (847)255-8349
411 S. Maple Street
Mt. Prospect, IL 60056

July 17, 2009

Ms. Susie K. Julison
Executive Director
Northwest Special Education Association
300 N. Central Road #205
Rolling Meadows, IL 60008

RE: Equipment for Mt. Prospect Park District Fitness Center Financed
Using Special Recreation Levy.

Dear Ms. Julison:

The Mt. Prospect Park District hereby requests approval from the Northwest Special Recreation Association Board of Directors for RecPlex Fitness Center fitness equipment.

The Mt. Prospect Park District's membership demographic includes many individuals with special needs, and an increasingly aging population. Over the last several years, this demographic has sought expanded wellness and fitness opportunities that this equipment will provide.

In July, Park District staff will solicit bids from qualified vendors for the following equipment:

Abdominal
Biceps Curl
Back Extension
Chest Press
Hip Abduction
Hip Adduction
Leg Extension
Pulldown
Pectoral Fly
Row/Rear Delt

Seated Leg Curl
Seated Leg Press
Shoulder Press
Triceps Press
Torso Rotation
Assist Dip Chin
Dual Adjustable Pulley
Crunch Bench
Leg Raise
Back Extension
Cross Trainer

Total Request not to exceed \$80,000.

This request is part of a renovation to the Center that is anticipated to be completed in 2009. With each new addition to the Fitness Center, staff carefully considers the benefits provided to those with special needs.

The current inventory of the fitness equipment at the Mt. Prospect Park District is aging and in need of replacement. The District offset its request by those items that it was able to trade in.

The Mt. Prospect Park District requests approval by the NWSRA Board to provide support for purchasing this equipment to better serve those individuals with special needs. The equipment will benefit NWSRA by providing and enhancing the facilities for their use. The requested equipment provides a safe way for members with disabilities to improve their fitness level, strength and balance thus improving their quality of life.

Some of the additional individual equipment features that can benefit our special needs users:

- The visually enhanced instructional placards are clearly marked, located in the most visible position, and provide simple instructions for correctly performing each exercise.
- A unique increment weight system, which is integrated into the weight stack, allows users to simply turn a dial for small, gradual increases in their resistance training program.
- Front shrouds and pulley covers make the equipment more approachable, less intimidating, and safe to all users. The shrouds cover the weight stack and protect the users fingers.
- Converging and diverging axes that correctly align with the user's joint movement, provide a natural, comfortable feel throughout the range of motion. Many of the Signature Series machines have the range of motion control to accommodate a range of users/capabilities.
- A low and consistent profile allows for easy entry and exit.
- The Cable Motion Dual Adjustable Pulley is wheel chair accessible and has low resistance cabling and small incremental increases.

Very truly yours,

MT. PROSPECT PARK DISTRICT



Louis J. Ennesser, Jr., RLA
Director of Parks & Planning

LE/lk



May 5, 2009

Ms. Susie Julison
 Executive Director
 NWSRA
 3000 Central Road – Suite 205
 Rolling Meadows, IL 60008

Re: Improvements Proposed to be Financed using Special Recreation Levy

Dear Ms. Julison:

The Bartlett Park District hereby requests approval from the NWSRA Board of Directors for the proposed expenditure of funds from the District's special recreation levy to pay for the cost of the following ADA improvements:

1. Leiseberg Park is a 12-acre park that was renovated in 2008. The project included the installation of new asphalt walking paths, play equipment, splash pad, drinking fountain, picnic shelter, and the renovation of the existing parking lot.

DESCRIPTION	COST	ADA PORTION	SUBMITTED
Drinking fountain	\$2,660.00	25%	\$665.00
Playground surfacing	\$7,128.50	50%	\$3,564.25
Playground ramp	\$3,050.00	100%	\$3,050.00
Sand play table	\$3,365.00	100%	\$3,365.00
Spray park equipment and installation	\$87,785.00	25%	\$21,946.25
Concrete paving – shelter and water park	\$46,189.10	25%	\$11,547.28
Asphalt paving – path	\$26,779.50	50%	\$13,389.75
Parking lot renovation	\$128,339.60	10%	\$12,833.96
ADA picnic tables	\$1,293.16	100%	\$1,293.16
Total ADA Compliance			\$71,654.65

2. Added 665 cubic yards of engineered wood fiber safety surface to 13 playground areas.
 - a. \$14,662.50 (total engineered wood fiber installation cost) x 0.5 (one half of safety surface installation cost) = \$7,331.25 (accessible portion of safety surface)
 - b. **ADA Portion: \$7,331.25**
3. 15-Passenger Bus with Accessible Lift – the cost for the bus is **\$44,521.00**

Total costs for park improvements and for the bus equals **\$123,506.90**.

The Bartlett Park District respectfully requests that you review this proposal and present it with your approving recommendation to the NWSRA Board of Directors. If you have any questions or require additional information please contact me.

Sincerely,

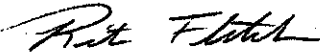

Rita Fletcher
Executive Director



Mt. Prospect Park District

Serving Portions of Mt. Prospect • Des Plaines • Arlington Heights • Elk Grove Village

www.mppd.org

ADMINISTRATIVE OFFICES

(847)255-5380
Fax (847)255-1438
1000 W. Central Road
Mt. Prospect, IL 60056

CENTRAL COMMUNITY CENTER

(847)255-5380
Fax (847)392-5726
1000 W. Central Road
Mt. Prospect, IL 60056

RECPLEX

(847)640-1000
Fax (847)364-2824
420 W. Dempster Street
Mt. Prospect, IL 60056

LIONS RECREATION CENTER

(847)632-9333
Fax (847)632-9325
411 S. Maple Street
Mt. Prospect, IL 60056

FRIENDSHIP PARK CONSERVATORY

(847)298-3500
Fax (847)296-2053
395 Algonquin Road
Des Plaines, IL 60018

MT. PROSPECT GOLF CLUB

(847)259-4200
Fax (847)632-9334
600 See-Gwun
Mt. Prospect, IL 60056

GOLF COURSE GARAGE

(847)632-9330
Fax (847)342-9113
600 See-Gwun
Mt. Prospect, IL 60056

LIONS GARAGE

(847)632-9320
Fax (847)255-8349
411 S. Maple Street
Mt. Prospect, IL 60056

April 21, 2009

Susie K. Julison
Executive Director
Northwest Special Recreation Association
3000 Central Road - Suite 205
Rolling Meadows, IL 60008

Re: Prospect Meadows Park Improvements Proposed To Be Financed Using
Special Recreation Levy

Dear Ms. Julison:

The Mt. Prospect Park District hereby notifies and requests approval of the NWSRA Board of Director for the proposed expenditure of funds from the District's special recreation levy, to pay the cost of the following improvements at Prospect Meadows Park.

See Attachment 'A'.

Note: Where the cost of accessible paths are used to calculate their worth, only three feet (3') of width is calculated, regardless of the actual path width.

The total estimated cost of the improvements including consultants is \$185,989.00. Of that total, \$78,674.00 is estimated to be the cost for accessible improvements. These improvements are scheduled to be completed by October 2009. The benefits of this project to NWSRA are as follows:

- Provides accessible paths from the proposed parking, basketball courts and T-Ball fields to the new play area.
- Provides accessible paths within the new playground.
- Provides accessible play to 67% of the older kids play structure, 100% of the younger kids play structure and 100% of all independent play equipment.
- Provides accessible paths from the adjacent residential neighborhood.

Included in this request are the proportionate costs for professional consulting services. The benefits to NWSRA are as follows:

- Provides for preparation of contract drawings, details and specifications to establish ADA compliant horizontal and vertical control for all pedestrian paths and ADA compliant layout of play equipment (i.e. safety zones).
- Provides for construction field staking to transfer horizontal and vertical controls indicated on drawings and details to the site.
- Provides for construction observation to ensure final construction is compliant with ADA requirements as shown on the drawings, details and specifications.

The Mt. Prospect Park District respectfully requests that you review this proposal and present it with your approving recommendation to the NWSRA Board of Directors. If you have any questions or require additional information, please do not hesitate to contact me at (847) 255-5380.

Very truly yours,

MT. PROSPECT PARK DISTRICT

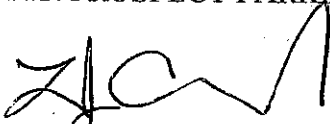

Louis J. Ennesser, Jr. RLA
Director of Parks & Planning
Mt. Prospect Park District

Cc w/Attachments Walter L. Cook
 Chief Executive Officer
 Mt. Prospect Park District

Sharon Anderson
Director of Recreation
Mt. Prospect Park District

ATTACHMENT 'A'
MT. PROSPECT PARK DISTRICT
PROSPECT MEADOWS PARK IMPROVEMENTS TO BE FINANCED USING SPECIAL RECREATION LEVY
COST SUMMARY
APRIL 21, 2009

DESCRIPTION	CALCULATION	COST
1 " Older Kids" Play Structure	1 EA @ \$31,954 x .67 (67%) See attachment 'B'.	\$21,409.00
2 "Younger Kids" Play Structure	1 EA @ \$10,990 x 1 (100%) See Attachment 'B'.	\$10,990.00
3 4 Seat Swing w / 1 Full Bucket & 1 Molded Bucket Seats	1 EA @ \$3,300 x 1 (100%) See Attachment 'B'.	\$3,300.00
4 4 Seat See-Saw w / Back Rests	1 EA @ \$3,300 x 1 (100%) See attachment 'B'.	\$3,300.00
5 Motorcycle Spring Toy	1 EA @ \$1,350 x 1 (100%) See attachment 'B'.	\$1,350.00
6 Dolphin Spring Toy	1 EA @ \$1,250 x 1 (100%) See Attachment 'B'.	\$1,250.00
7 Engineered Wood Fibre Playground Surfacing	205 CY @ \$25.00	\$5,125.00
8 3' Wide Integral Concrete Curb/Walk around Perimeter of Play Area	1310 SF @ \$9.90	\$12,969.00
9 Concrete Walk	612 SF x .6 (3' of 5' total width) = 367 SF @ \$5.00	\$1,835.00
10 Asphalt Walk	307 SY x .6 (3' of 5' total width) = 184 SY @ \$27.00	\$4,968.00
11 Asphalt Drive (Handicapped Parking)	130 SY @ \$32.00	\$4,160.00
12 Pavement Markings (Handicapped Parking)	300 LF X \$1.50	\$450.00
13 Signage (Handicapped Parking)	2 EA @ \$400.00	\$800.00
	Sub-Total - Construction	\$71,906.00

ATTACHMENT 'A'
MT. PROSPECT PARK DISTRICT
PROSPECT MEADOWS PARK IMPROVEMENTS TO BE FINANCED USING SPECIAL RECREATION LEVY
COST SUMMARY
APRIL 24, 2009

DESCRIPTION	CALCULATION	COST
	NOTE: \$71,906.00 (ADA Improvement Costs) + \$169,989.00 (Total Construction Cost Estimate) = 42.3% of Project Funds Allocated for ADA Improvements.	
Civil Engineer	\$16,000.00 (Consultant Fee) x .423 (42.3%)	\$6,768.00
	Sub-Total - Consultants	\$6,768.00
	Total - Prospect Meadows Park Improvements	\$78,674.00
TOTAL AMOUNT REQUESTED		\$78,674.00

ATTACHMENT 'A'
MT. PROSPECT PARK DISTRICT
PROSPECT MEADOWS PARK IMPROVEMENTS TO BE FINANCED USING SPECIAL RECREATION LEVY
COST SUMMARY
APRIL 21, 2009

	DESCRIPTION	CALCULATION	COST
1	"Older Kids" Play Structure	1 EA @ \$31,954 x .67 (67%) See attachment 'B'.	\$21,409.00
2	"Younger Kids" Play Structure	1 EA @ \$10,990 x 1 (100%) See Attachment 'B'.	\$10,990.00
3	4 Seat Swing w / 1 Full Bucket & 1 Molded Bucket Seats	1 EA @ \$3,300 x 1 (100%) See Attachment 'B'.	\$3,300.00
4	4 Seat See-Saw w / Back Rests	1 EA @ \$3,300 x 1 (100%) See attachment 'B'.	\$3,300.00
5	Motorcycle Spring Toy	1 EA @ \$1,350 x 1 (100%) See attachment 'B'.	\$1,350.00
6	Dolphin Spring Toy	1 EA @ \$1,250 x 1 (100%) See Attachment 'B'.	\$1,250.00
7	Engineered Wood Fibre Playground Surfacing	205 CY @ \$25.00	\$5,125.00
8	3' Wide Integral Concrete Curb/Walk around Perimeter of Play Area	1310 SF @ \$9.90	\$12,969.00
9	Concrete Walk	612 SF x .6 (3' of 5' total width) = 367 SF @ \$5.00	\$1,835.00
10	Asphalt Walk	307 SY x .6 (3' of 5' total width) = 184 SY @ \$27.00	\$4,968.00
11	Asphalt Drive (Handicapped Parking)	130 SY @ \$32.00	\$4,160.00
12	Pavement Markings (Handicapped Parking)	300 LF X \$1.50	\$450.00
13	Signage (Handicapped Parking)	2 EA @ \$400.00	\$800.00
		Sub-Total - Construction	\$71,906.00

ATTACHMENT 'A'

MT. PROSPECT PARK DISTRICT

PROSPECT MEADOWS PARK IMPROVEMENTS TO BE FINANCED USING SPECIAL RECREATION LEVY

COST SUMMARY

APRIL 21, 2009

DESCRIPTION	CALCULATION	COST
NOTE: \$71,906.00 (ADA Improvement Costs) + \$169,989.00 (Total Construction Cost Estimate) = 42.3% of Project Funds Allocated for ADA Improvements.		
Civil Engineer	\$16,000.00 (Consultant Fee) x .423 (42.3%)	\$6,768.00
	Sub-Total - Consultants	\$6,768.00
	Total - Sunset Park Improvements	\$78,674.00
TOTAL AMOUNT REQUESTED		\$78,674.00

ATTACHMENT 'B'



Box 2121
LaGrange, IL 60525
708-579-9055
708-579-0109 (fax)
1-800-526-6197

February 5, 2009

Lou Ennesser
Mt. Prospect Park District
1000 W. Central Rd.
Mt. Prospect, IL 60056

Re: Prospect Meadows Park
Mt. Prospect Park District

Dear Lou,

Thank you for your phone call about the accessibility of the proposed play equipment at Prospect Meadows Park.

Attached find our analysis of compliance to current guidelines of accessible elements and percentage of the total equipment by cost.

Please call me if I can be of further help. We appreciate your interest in our equipment and look forward to working with you on the development of this play area.

Sincerely,
NuToys Leisure Products

Jack Gleason

JG/mw

Attachment



Box 2121
 LaGrange, IL 60525
 708-579-9055
 708-579-0109 (fax)
 1-800-526-6197

FEBRUARY 5, 2009

PROSPECT MEADOWS PARK
 MOUNT PROSPECT, IL
 OPTION 3 - REVISED
 ALUMINUM PLAYBOOSTER W/TENDERDECKS

QTY NO. DESCRIPTION

1.) SCHOOL AGE AREA PLAYSTRUCTURE

3	111404A	148 ALUM. POST D.B.
2	111404B	140 ALUM. POST D.B.
4	111404C	132 ALUM. POST D.B.
1	111404E	116 ALUM. POST D.B.
1	111404F	108 ALUM. POST D.B.
1	152911A	CURVED TRANSFER MOD LEFT
1	111228A	SQUARE TENDERDECK
2	111231A	TRIANGULAR TENDERDECK
1	123333B	ROLLERSLIDE 56 DECK
1	130390A	DOUBLE SWOOSH POLY SLIDE 72 DECK
1	148434B	LOOP POLE W/PERM 56 DECK
1	145624D	VERTICAL ASCENT 72 DECK
1	160054C	STATIONARY CYCLER PEDALS/HANDLES
1	152908A	DECK LINK W/HANDRAILS (1 STEP)
1	152908B	DECK LINK W/HANDRAILS (2 STEPS)

ACCESSIBLE SCHOOL AGE TOTAL

67%

II.) INDEPENDENT EQUIPMENT

1	100013B	MOTORCYCLE (PERMALENE) D.B.
1	135536B	WHIMSY RIDER DOLPHIN D.B.
1	148637A	SEESAW 4-SEATS D.B.
2	148706B	SEE SAW BACK REST W/O BELT
1	122837A	4 PLACE SGL POST SWING W/ GALVANIZED CHAINS
1	122838A	W/ 2 BELT SEATS & W/1 FULL BUCKET & W/1 MOLDED BUCKET SEAT

ACCESSIBLE INDEPENDENT TOTAL

100%

III.) PRESCHOOL AGE AREA

- 4 111404E 116 ALUM. POST DAB.
- 1 111404I 84 ALUM. POST D.B.
- 1 152911B CURVED TRANSFER MOD LEFT
- 1 111228A SQUARE TENDERDECK
- 1 119514A PILOT PANEL ABOVE DECK
- 1 115254A STORE FRONT PANEL
- 1 123331B DOUBLE POLY SLIDE 40 DECK
- 1 123293A COZY CLIMBER W/PERM HANDHOLD
- 2 111363A TALK TUBE (NO POST)
- 1 111362A TALK TUBE 40' TUBING KIT

ACCESSIBLE PRESCHOOL AGE TOTAL

100%



JANUARY 9, 2009

Box 2121
 LaGrange, IL 60
 708-579-9055
 708-579-0109 (f)
 1-800-526-6197

PROSPECT MEADOWS PARK
 MOUNT PROSPECT, IL
 OPTION 3

SCHOOL AGE AREA

ADA GUIDE LINES

TOTAL ELEVATED PLAYSTRUCTURE COMPONENTS - 6

NO RAMP REQUIRED

PROVIDED

	N/A	#
PLAYSTRUCTURE COMPONENTS ACCESSIBLE VI		
PLAYSTRUCTURE COMPONENTS ACCESSIBLE V	4	
GROUND LEVEL EVENTS	4	
GROUND LEVEL TYPES	3	

PRESCHOOL AGE AREA

ADA GUIDE LINES

TOTAL ELEVATED PLAYSTRUCTURE COMPONENTS - 3

NO RAMP REQUIRED

PROVIDED

	N/A	#
PLAYSTRUCTURE COMPONENTS ACCESSIBLE VI		
PLAYSTRUCTURE COMPONENTS ACCESSIBLE V	3	
GROUND LEVEL EVENTS	6	
GROUND LEVEL TYPES	3	

March 9, 2009

Ms. Susie K. Julison
Executive Director
Northwest Special Recreation Association
3000 Central Road, Suite 205
Rolling Meadows, IL 60008

Re: Malibu Park Improvements Proposed to be Financed Using Special Recreation Levy

Dear Ms. Julison:

The Wheeling Park District hereby notifies and requests approval of the NWSRA Board of Directors for the expenditure of funds from the District's special recreation levy to pay the cost of the following improvements at Malibu Park:

- Replacement of outdated play equipment with a new play structure and installation of new accessible playground safety surface.
- Installation of a new accessible drinking fountain
- New walkways to provide accessibility to the play equipment
- Installation of accessible benches
- Replacement of an inaccessible concrete walk (grade too steep) entry into the park.

Park District staff has determined that the ADA portion of these improvements should be 64% of playground cost (\$90,240), 50% of the ADA accessible drinking fountain (\$4,300), 50% of the new concrete walkways (\$2,200) and, 50% of permitting and A/E fees (\$5,220). The total cost for the improvements was \$232,500. Of that total, \$101,960.00 was determined to be the cost for the accessible portion of the park. These improvements were completed in May, 2008. The benefits of this project to NWSRA are as follows:

- Provides a play structure that exceeds ADA guidelines for accessibility
- Provides an accessible playground surface to the play elements
- Provides accessibility throughout the park
- Provides accessible site amenities

The Wheeling Park District respectfully asks that you review this request and present it with your approving recommendation to the NWSRA Board of Directors. If you have any questions or require additional information, please do not hesitate to contact me at (847) 465-7772.

Sincerely,

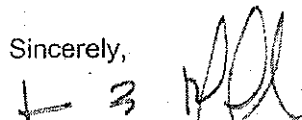

Lawrence Raffel, ASLA, CPSI
Superintendent of Planning



Mt. Prospect Park District

Serving Portions of Mt. Prospect • Des Plaines • Arlington Heights • Elk Grove Village

www.mppd.org

ADMINISTRATIVE OFFICES

(847)255-5380

Fax (847)255-1438

1000 W. Central Road
Mt. Prospect, IL 60056

CENTRAL COMMUNITY CENTER

(847)255-5380

Fax (847)392-5726

1000 W. Central Road
Mt. Prospect, IL 60056

RECPLEX

(847)640-1000

Fax (847)364-2824

420 W. Dempster Street
Mt. Prospect, IL 60056

LIONS RECREATION CENTER

(847)632-9333

Fax (847)632-9325

411 S. Maple Street
Mt. Prospect, IL 60056

FRIENDSHIP PARK CONSERVATORY

(847)298-3500

Fax (847)296-2053

395 Algonquin Road
Des Plaines, IL 60018

MT. PROSPECT GOLF CLUB

(847)259-4200

Fax (847)632-9334

600 See-Gwun
Mt. Prospect, IL 60056

GOLF COURSE GARAGE

(847)632-9330

Fax (847)342-9113

600 See-Gwun
Mt. Prospect, IL 60056

LIONS GARAGE

(847)632-9320

Fax (847)255-8349

411 S. Maple Street
Mt. Prospect, IL 60056

March 2, 2009

Susie K. Julison
Executive Director
Northwest Special Recreation Association
3000 Central Road - Suite 205
Rolling Meadows, IL 60008

Re: Central Community Center Main Entry Door Improvements Proposed To Be
Financed Using Special Recreation Levy

Dear Ms. Julison:

The Mt. Prospect Park District hereby notifies and requests approval of the NWSRA Board of Director for the proposed expenditure of funds from the District's special recreation levy, to pay the cost of the following improvements:

Convert Four (4) Main Entry Doors from Manual to Automatic (Push Button
Door Operation)

The total cost of the improvements is \$8,297.18. These improvements are scheduled to be completed by Spring 2009.

The Mt. Prospect Park District respectfully requests that you review this proposal and present it with your approving recommendation to the NWSRA Board of Directors. If you have any questions or require additional information, please do not hesitate to contact me at (847) 255-5380.

Very truly yours,

MT. PROSPECT PARK DISTRICT

Louis J. Ennesser, Jr. RLA
Director of Parks & Planning
Mt. Prospect Park District

Cc: Walter L. Cook
Chief Executive Officer
Mt. Prospect Park District

Sharon Anderson
Director of Recreation
Mt. Prospect Park District

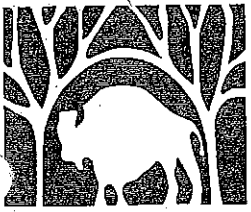

Buffalo Grove Park District



February 26, 2009

Ms. Susie Julison
Executive Director
Northwest Special Recreation Association
3000 W. Central Road #205
Rolling Meadows, IL 60008

Dear Ms. Julison:

The Buffalo Grove Park District hereby requests approval of the NWSRA Board of Directors for the proposed expenditure of funds from the District's Special Recreation Levy to pay for two pieces of fitness equipment at the Buffalo Grove Fitness Center.

(1) Freemotion Dual Cable Cross

The Dual Cable Cross Machine from Freemotion Fitness is one of the most universal and diverse pieces of fitness equipment on the market. The versatility provides strength training options for individuals from the most elite athletes to the deconditioned or physically challenged. The arms move independently of each other allowing for the increased diversity. Each arm moves almost 180 degrees vertically and 90 degrees horizontally. The independent weight stacks allow each arm to have different amounts of resistance to accommodate 2 different people at one time or assist individuals with strength imbalances from one side to another.

The one Dual Cable Cross Machine currently at the Buffalo Grove Fitness Center has been widely used and utilized by both members and Personal Training staff.

(2) NuStep Recumbent Cross Trainer

The NuStep is an adaptable piece of equipment from able bodied individuals to others with more complex physical limitations. The machine has a larger seat to ensure stability of the user. The seat also swivels 90 degrees to the left or right allowing for ease of access when transferring from a standing position or from a wheelchair. There are several adjustments to accommodate individuals from 5 ft tall to well over 6 ft tall in addition to multiple resistance settings for all fitness levels. The machine also features upper body and lower body movement. This is a great option for individuals who have suffered from a stroke or other forms of paralysis since it allows both stability and an opportunity to move all 4 limbs.

Currently, Buffalo Grove Fitness Center has 2 NuStep machines. They are widely used from members of all ages and fitness levels and at times even have people waiting. The addition of a third NuStep would be appreciated by the members and add another machine for those members with physical limitations or disabilities.

The total cost for the two pieces of fitness equipment with delivery is \$9,162.

Buffalo Grove Park District respectfully requests that you review this proposal and present it with your recommendation to the NWSRA Board of Directors.

If you have any questions or require additional information, please do not hesitate to contact me at 847-850-2110. We appreciate our time and consideration.

Sincerely,



Michael Rylko
Executive Director

Sales Quotation

Selling Dealer:

MGL Fitness, Inc

314 N. Monroe Ave., Green Bay WI 54301

Mike LeMere 920-435-2770

www.mglfitness.com

Order Hotline Fax:
(866) 591-0671

Selling Agent: David Podolske

This Fitness Solution Prepared For:	Date: 01/14/09	Expiration Date: 02/13/09	
Company: Buffalo Grove Fitness Center	Customer P.O.:		<input type="checkbox"/> Drop Ship
Contact Person: Jason Busdeker	Payment Terms: 50/50	▼	<input type="checkbox"/> Exempt
Address 1:	Requested Delivery Date:		
Address 2: 601 W. Deerfield Parkway	Account Manager:	Dave Podolske	▼
City, State, Zip: Buffalo Grove, IL	Phone: (262) 227-2774	Fax: 866-591-0671	
Phone: (847) 353-8701	Fax:		
EMAIL: jbusdeker@bgfitnesscenter.com	email: davep@mglfitness.com		

Qty	Manufacturer	Model	Description	List Price	Unit Price	Price
1	Freemotion	GZFM6024	Freemotion Dual Stack Cable Cross	\$5,495.00	\$ 4,899.00	\$ 4,899.00
					\$ -	\$ -
					\$ -	\$ -
			Shipping Includes:		\$ -	\$ -
			Delivery		\$ -	\$ -
			Assembly		\$ -	\$ -
			Full Installation		\$ -	\$ -
					\$ -	\$ -
					\$ -	\$ -
					\$ -	\$ -
					\$ -	\$ -
					\$ -	\$ -
					\$ -	\$ -
					\$ -	\$ -
					\$ -	\$ -
					\$ -	\$ -

Page 1 Subtotal	\$ 4,899.00
Page 2 & 3 Subtotal	\$ -
Shipping, Delivery, & Installation	\$ 420.00
Grand Total**	\$ 5,319.00

Sales taxes will be added to all orders. Please provide exemption certificate, if applicable.
- We reserve the right to charge a 15% re-stocking fee on cancelled orders.

Frame:	Upholstery:
---------------	--------------------

Comments:

Customer Acceptance: _____	Date: _____
----------------------------	-------------

Account Manager Signature: David Podolske

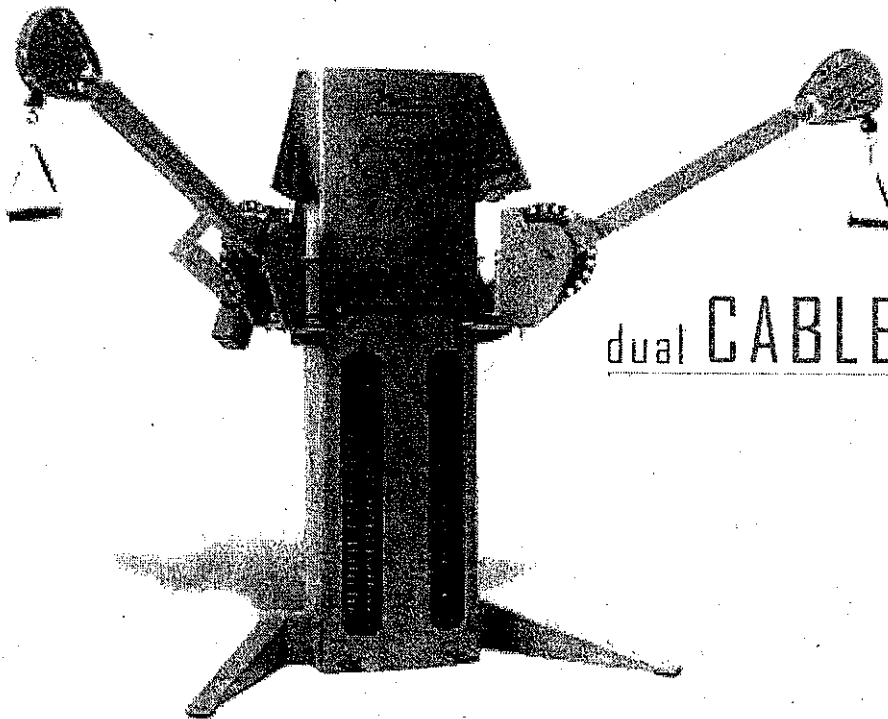

dual CABLE CROSS

specifications	GZFM6024	
effective resistance of both weight stacks: 1 arm - 75 lbs. (34 kg) configuration: 2.5 - 75 x 2.5 lbs. (1.125 - 34 x 1.125 kg)	US / METRIC L - 70" / 178 cm W - 132" / 330 cm H - 95" / 241 cm 1150 lbs. / 522 kg cable diameter: 3/16-inch rated to 2,000 lbs.	

Swivel pulley - Pulley design ensures fluid cable travel and provides nearly unlimited range of motion.

Independently rotating arms - Each arm rotates vertically and horizontally with 12 vertical and 9 horizontal settings to accommodate virtually any movement pattern. Arms are counterbalanced for easy positioning.

Independently moving handles - Handles can move independently for virtually unlimited exercises.

ADA Compliant - Compliant with Americans with Disabilities Act for wheelchair accessibility.

Extensive cable travel - Extensive cable travel allows for full exercise extension or flexion, single arm - 92 inches (234 cm), two arms - 92 inches (234 cm).

Enclosed weight stacks - Enclosed weight stacks limit access to moving parts for user safety. Dual independent stacks allow two members to work out simultaneously.

Industrial construction - Equipment is built with 14- and 7-gauge steel and is electrostatically powder coated.

Stainless steel kick plates - 16-gauge stainless steel kick plates protect the machine from wear and tear.

FREEMOTION FITNESS™

1096 Elkton Drive Suite 600, Colorado Springs, CO 80907

toll free 877.363.8449 or [+1] 719.533.2900 www.freemotionfitness.com

NuStep, Inc.
5111 Venture Dr.
Suite 1
Ann Arbor, MI 48108
USA



Phone: 1-800-322-2209
Fax: (734) 769-8180

Transforming Lives®

Customer No. 8970
Quote Number: 17502

Quote

Page: 1 of 1

Quote To:

Jason Busdeker
Buffalo Grove Park District
530 Bernard Drive
Buffalo Grove IL 60089
USA

Phone: 847-353-7505

Date: 2/25/2009

Expires: 5/26/2009

Active Living Consultant:

Jim Steinhebel
1-800-322-2209 x113
734-769-8180
jsteinhebel@nustep.com

US Dollars

Line	Part Number	Description	Rev	Drawing
1	04006	T4 Recumbent Cross Trainer	B	
<i>Full-Service delivery includes inside set up, assembly and removal of shipping crate. Drop ship/Dock to Dock delivery is available for \$239 in lieu of Full Service.</i>				

Quantity	Unit Price	Adjustment	Net Price
1.00	3,495.00	0.00	3,495.00

Line(1) - Miscellaneous Charge -

Freight-U.S. Professional - 348.00
Shipping Type Quoted: Full Service
FOB: Destination

\$3,843.00

For Michigan orders a 6% sales tax, and for Indiana Orders a 7% sales tax will be added to all equipment including shipping and accessories, unless tax exempt. For Massachusetts orders, a 5% sales tax will be added to all equipment and accessories only.

The NuStep Recumbent Cross Trainer is solely manufactured by NuStep, Inc. (tax ID#38-3347347) 5111 Venture, Suite 1, Ann Arbor, MI 48108.

Terms are net 30 from ship date. If payment is more than 15 days past due, a late fee of \$35 and interest in the amount of 1.5% per month will be charged, or, if less, the maximum rate of interest permitted under applicable law. For customers with a line of credit, balances not paid within 90 days will result in the loss of their line of credit. Non sufficient fund (NSF) fee is \$35.

Thank You! We look forward to your order.

Visit our website at www.nustep.com

The classic, award-winning
design for professional and
home exercise.

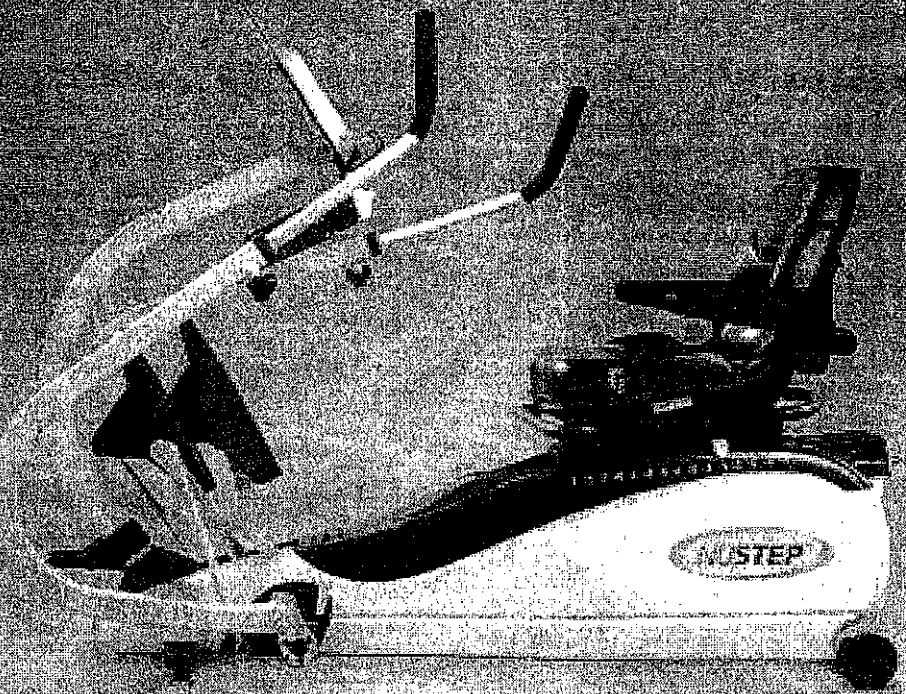

**MADE IN THE
USA**

Questions?

A NuStep Active Living
Consultant will answer any
questions and assist with
your order.

- Product Overview
- Value Story
- Key Features
- Set-Up
- T4 Add-Ons
- Product Details
- Video Gallery



[Download a T4 spec
sheet \(PDF\)](#)

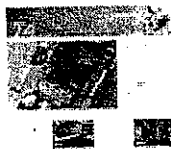

[Download a spec
sheet for T4
accessories \(PDF\)](#)

The NuStep T4 has been the most popular recumbent cross trainer in the healthcare and fitness industries, and it has become the leading product of its kind for home users. Its patented design combines a comfortable seated position with a smooth stepping motion. It provides simultaneous upper and lower body motion to work all the major muscle groups, helping all users to burn calories, build strength, and improve their overall cardiovascular fitness.

The T4 simulates a natural walking motion while eliminating undesirable joint stress and promoting functional fitness. Its ergonomic design accommodates nearly every body type and size, and it includes a swivel seat for easy transfer. The T4 also features a large, easy-to-read display. The display is battery powered to optimize your flexibility to place the product anywhere within your home or commercial environment, without concern for power cords or outlets.

Clinicians around the world have demonstrated that the T4 is the preferred piece of rehabilitation equipment to ensure safe and effective treatment of individuals within a wide range of ability levels. By enabling independent control of step length, resistance level, pace, and exercise duration, the T4 provides treatment flexibility for therapists and a greater feeling of control and independence for users.

The T4 is quiet during operation and is virtually maintenance free.

Click on our menu for a complete list of product specifications, warranty, and other information, or contact a NuStep Active Living Consultant to order now and start enjoying the benefits of exercise with the T4 Recumbent Cross Trainer!





Mt. Prospect Park District

Serving Portions of Mt. Prospect • Des Plaines • Arlington Heights • Elk Grove Village

www.mppd.org

ADMINISTRATIVE OFFICES

(847)255-5380

Fax (847)255-1438

1000 W. Central Road
Mt. Prospect, IL 60056

CENTRAL COMMUNITY CENTER

(847)255-5380

Fax (847)392-5726

1000 W. Central Road
Mt. Prospect, IL 60056

RECPLEX

(847)640-1000

Fax (847)364-2824

420 W. Dempster Street
Mt. Prospect, IL 60056

LIONS RECREATION CENTER

(847)632-9333

Fax (847)632-9325

411 S. Maple Street
Mt. Prospect, IL 60056

FRIENDSHIP PARK CONSERVATORY

(847)298-3500

Fax (847)296-2053

395 Algonquin Road
Des Plaines, IL 60018

MT. PROSPECT GOLF CLUB

(847)259-4200

Fax (847)632-9334

600 See-Gwun
Mt. Prospect, IL 60056

GOLF COURSE GARAGE

(847)632-9330

Fax (847)342-9113

600 See-Gwun
Mt. Prospect, IL 60056

LIONS GARAGE

(847)632-9320

Fax (847)255-8349

411 S. Maple Street
Mt. Prospect, IL 60056

December 11, 2009

Susie K. Julison
Executive Director
Northwest Special Recreation Association
3000 Central Road - Suite 205
Rolling Meadows, IL 60008

Re: Purchase of ASTM F1292/ASTM F1951 Compliant Playground Surfacing in 2009

Dear Ms. Julison:

The Mt. Prospect Park District hereby notifies and requests approval of the NWSRA Board of Directors for the proposed expenditure of funds from the District's special recreation levy, to pay the cost of the following improvements:

Purchase and placement of the referenced playground surfacing Park District-wide at a cumulative cost not to exceed \$12,000 for the year 2009. The surfacing will be used to refresh various existing playgrounds and access routes, thus insuring continued compliance with ADA requirements. The Mt. Prospect Park District will supply NWSRA with year-end documentation of the total amount spent and the location of the facilities.

The Mt. Prospect Park District respectfully requests that you review this proposal and present it with your approving recommendation to the NWSRA Board of Directors. If you have any questions or require additional information, please do not hesitate to contact me at (847) 255-5380.

Very truly yours,

MT. PROSPECT PARK DISTRICT

Louis J. Emnesser, Jr. RLA
Director of Parks & Planning
Mt. Prospect Park District

cc: Walter L. Cook
Chief Executive Officer
Mt. Prospect Park District

Sharon Anderson
Director of Recreation
Mt. Prospect Park District

Daryl Kimbrough
Grounds Department Manager
Mt. Prospect Park District

RIVER TRAILS

PARK DISTRICT



ADMINISTRATIVE OFFICE
401 East Camp McDonald Road, Prospect Heights, Illinois 60070
Phone: (847) 788-0551 Fax: (847) 788-1248
E-Mail: admin@rtpd.org

MARVIN S. WEISS COMMUNITY CENTER
1500 East Euclid Avenue, Mount Prospect, Illinois 60056
Phone: (847) 255-1200 Fax: (847) 255-1285
E-Mail: info@rtpd.org

January 6, 2009

Ms. Susie Julison
Executive Director
NWSRA
3000 Central Road – Suite 205
Rolling Meadows, IL 60008

Re: Improvements Proposed to be Financed Using Special Recreation Levy

Dear Ms. Julison,

We request approval from the NWSRA Board of Directors for the proposed expenditure of funds from the River Trails Park District's Special Recreation Levy to pay for the cost of the following ADA improvements:

Woodland Trails Park Asphalt repairs and sealcoating of all parking lots and accessible paths:

Out of the total bill of \$29,997.80, we are requesting \$3438.11.

- 9 painted handicapped parking stalls @ \$175 each = **\$1575.00**
- 10% of the costs of sealcoating and repairs to the paths
 - Parking lots = 120,476 square feet
 - Accessible bike/walking paths = 78,967 square feet
 - $78,967 / 120,476 = 65.55\%$
 - $(\$29,997.80 - \$1575.00) \times 65.55\% \times 10\% =$ **\$1863.11**

\$3438.11

We respectfully request that you review this proposal and present it for recommendation to the NWSRA Board of Directors.

Thank you very much for your consideration.

Sincerely,

A handwritten signature in cursive script that reads "Debbie".

Debbie Carlson Kudla
Director, River Trails Park District