

Mt. Prospect Park District

Serving Portions of Mt. Prospect • Des Plaines • Arlington Heights • Elk Grove Village

www.mppd.org

ADMINISTRATIVE OFFICES

(847)255-5380

Fax (847)255-1438

1000 W. Central Road

Mt. Prospect, IL 60056

CENTRAL COMMUNITY CENTER

(847)255-5380

Fax (847)392-5726

1000 W. Central Road

Mt. Prospect, IL 60056

RECPLEX

(847)640-1000

Fax (847)364-2824

420 W. Dempster Street

Mt. Prospect, IL 60056

LIONS RECREATION CENTER

(847)632-9333

Fax (847)632-9325

411 S. Maple Street

Mt. Prospect, IL 60056

FRIENDSHIP PARK CONSERVATORY

(847)298-3500

Fax (847)296-2053

395 Algonquin Road

Des Plaines, IL 60018

MT. PROSPECT GOLF CLUB

(847)259-4200

Fax (847)632-9334

600 See-Gwun

Mt. Prospect, IL 60056

GOLF MAINTENANCE

(847)632-9330

Fax (847)342-9113

600 See-Gwun

Mt. Prospect, IL 60056

MAINTENANCE FACILITY

(847)956-6773

Fax (847)956-6911

1645 Carboy

Mt. Prospect, IL 60056

March 9, 2017

Tracy Crawford
Executive Director
Northwest Special Recreation Association
3000 Central Road – Suite 205
Rolling Meadows, IL 60008

Re: ADA Improvements – Einstein Park Phase II Construction

Ms. Crawford,

The Mt. Prospect Park District hereby notifies and requests approval of the NWSRA Board of Directors for the proposed expenditures of funds from the Park District's Special Recreation levy to pay for the following improvements:

Reimbursement for ADA related improvements to include new ADA accessible parking areas and routes of travel, ADA accessible exercise equipment, drinking fountain, benches, and Basketball and Baseball improvements. These improvements will provide new ADA accessible play and exercise opportunities where none previously existed. In addition it will create accessible routes of travel throughout the park to these new amenities.

The total construction and Engineering cost for this project is \$554,813.02.

The total identified **ADA** related costs associated with this product are **\$148,147.02**.

Please see the attached supporting documents from Ratio Architects for itemized details and costs for the proposed accessibility upgrades.

The Mt. Prospect Park District respectfully requests that you review this proposal and present it with your approving recommendation to the NWSRA Board of Directors.

Sincerely,

Jim Jarog
Director of Parks & Planning
Mt. Prospect Park District

CC: Greg Kuhs
Executive Director
Mt. Prospect Park District



RATIO

Architecture Preservation Interior Design Landscape Architecture Urban Design + Planning Graphic Design

March 10, 2017

Jim Jarog, Director of Parks and Planning
Mt. Prospect Park District
1000 Central Road
Mount Prospect, IL 60056

Re: Accessibility Fund Reimbursement from NWSRA
Einstein Park Phase II

Dear Jim,

Einstein Park is a 6 acre park in the City of Des Plaines. Many of the existing improvements were installed in the mid 80's and will be replaced or upgraded. The new improvements will include new parking area, new pathways, exercise and workout stations, revised ballfield, drinking fountain, halfcourt basketball and benches and tables. We recommend the following funds be reimbursed to the Mt. Prospect Park District for Accessibility improvements. The funds will be paid to the contractor through a competitively bid Park District contract. The Park District is being partially reimbursed through the Illinois Department of Natural Resources OSLAD grant program.

The below costs are an estimate of costs based on past experience in bidding similar projects

- 1) Request reimbursement for the removal and replacement of the two handicap parking spots and signage in the amount of \$4,700.00
- 2) Request reimbursement for 5' portion of concrete and asphalt pathways including both removals and construction for pathways that lead to the activities that require access or part of an accessible loop in the amount of \$88,331.00
- 3) Request reimbursement for 50% of the cost of exercise equipment and installation and reimbursement of 50% of the accessible surface in the amount of \$22,858.00. The exercise equipment is a combination of equipment accessible from your wheel chair, equipment that can be transferred onto or for ground mounted use.
- 4) Request reimbursement for 50% of the cost of the drinking fountain and associated utility work in the amount of \$8,513.00.
- 5) Request reimbursement for 50% of the cost of the benches and picnic tables in the amount of \$6,000.00
- 6) Request reimbursement for 15% of the cost of the dugout improvements in the amount of \$ 4,200.00. Nationally 1:6 of the population are people with disabilities or about 15%. The dugouts will be designed so as to be accessible from the stands and the rest of the park and from the field, as well as allow for shoulder to shoulder seating at the team benches.
- 7) Request reimbursement of 27% (percentage of accessibility improvements of total improvement) of the cost of professional services \$13,545.02

RATIO Architects recommends the Mt Prospect Park District request \$148,147.02 for reimbursement from the NWSRA for accessibility improvements made as part of the Einstein Park Phase II Construction. If you have any questions please let me know.

Sincerely,

Ben Kutscheid, ASLA, RLA
Project Director

Cost Estimate for Einstein Park

OSLAD Grant - PHASE 2

Mount Prospect Park District

PHASE 2

3/10/2017

	Quantity	Units	Unit Cost	Total	NWSRA
Demolition and Removals					
Asphalt Parking Lot	13330	sf	\$ 1.40	\$ 18,662.00	\$ 1,000.00
Parking Curb	900	lf	\$ 4.50	\$ 4,050.00	
Asphalt Pathways	19208	sf	\$ 1.00	\$ 19,208.00	\$ 16,009.87
Backstop and infield - South	1	ea	\$ 6,000.00	\$ 6,000.00	
Backstop and infield - North	1	ea	\$ 6,500.00	\$ 6,500.00	
Miscellaneous Removals	1	ea	\$ 6,000.00	\$ 6,000.00	
Construction fencing and Signage	1	ea	\$ 10,000.00	\$ 10,000.00	
				\$ 70,420.00	
Grading and Utilities					
Grading	1	ls	\$ 20,000.00	\$ 20,000.00	
Catch Basin	1	ea	\$ 2,500.00	\$ 2,500.00	
Stormwater utilities	1	ls	\$ 5,000.00	\$ 5,000.00	
Storm Water Pipe	120	lf	\$ 35.00	\$ 4,200.00	
Drinking Fountain					
Drinking Fountain	1	ea	\$ 5,500.00	\$ 5,500.00	\$ 2,750.00
Water Service/ RPZ	1	ea	\$ 5,000.00	\$ 5,000.00	\$ 2,500.00
Copper Pipe	107	lf	\$ 35.00	\$ 3,745.00	\$ 2,013.00
Drain to french drain	1	ls	\$ 2,000.00	\$ 2,000.00	\$ 1,250.00
				\$ 47,945.00	
Parking Lot					
Curb	990	lf	\$ 24.00	\$ 23,760.00	
Asphalt Paving	10752	sf	\$ 3.80	\$ 40,857.60	\$ 3,500.00
Paver Curb	101	lf	\$ 22.00	\$ 2,222.00	
Permeable Paver Paving	847	sf	\$ 13.00	\$ 11,011.00	
Striping	1	ls	\$ 1,800.00	\$ 1,800.00	\$ 200.00
				\$ 79,650.60	
North Baseball Diamond					
New Backstop with overhang	1	ls	\$ 26,000.00	\$ 26,000.00	
Sidewing Fencing	130	lf	\$ 65.00	\$ 8,450.00	
Infield - New	4500	sf	\$ 0.80	\$ 3,600.00	
Infield - Existing	7300	sf	\$ 0.20	\$ 1,460.00	
Covered Dugouts (Installed)	2	ea	\$ 14,000.00	\$ 28,000.00	\$ 4,200.00
Dugout Benches	4	ea	\$ 800.00	\$ 3,200.00	
				\$ 70,710.00	
Park Paving					
Asphalt Paving (8' Wide, BBALL)	25660	sf	\$ 3.25	\$ 83,395.00	\$ 58,520.04
Asphalt Paving Existing base	2807	sf	\$ 2.00	\$ 5,614.00	\$ 4,679.27
Concrete Paving	1384	sf	\$ 9.00	\$ 12,456.00	\$ 9,121.82
				\$ 101,465.00	

Basketball

Basketball Hoops	1	ea	\$	2,200.00	\$	2,200.00
Basketball Striping	1	ls	\$	1,200.00	\$	1,200.00

Miscellaneous and Amenities

Workout Station	1	ls	\$	27,014.00	\$	27,014.00	\$	13,507.00
Surfacing - PIP	1091	sf	\$	14.50	\$	15,819.50	\$	7,851.00
Concrete Curb	125	sf	\$	24.00	\$	3,000.00	\$	1,500.00
Benches	3	ea	\$	1,600.00	\$	4,800.00	\$	2,400.00
Plaza Tables	4	ea	\$	1,800.00	\$	7,200.00	\$	3,600.00
Waste Receptacles	6	ea	\$	800.00	\$	4,800.00		
Shelter								
New Metal Roof	1350	sf	\$	8.50	\$	11,475.00		
Facia Repairs	1	ls	\$	1,500.00	\$	1,500.00		
Painting	1	ls	\$	2,500.00	\$	2,500.00		
New Sign	1	ea	\$	6,000.00	\$	6,000.00		
New fence at Electric Service	40	lf	\$	35.00	\$	1,400.00		
Lighting								
Move light pole, new footing, fix	1	ls	\$	5,500.00	\$	5,500.00		
New Light Fixture	2	ea	\$	2,500.00	\$	5,000.00		
Knock Down Bollards	2	ea	\$	900.00	\$	1,800.00	\$	97,808.50

Landscape

Bioswales	15000	sf	\$	0.50	\$	7,500.00
Bioswale Interpretation	1	ea	\$	2,500.00	\$	2,500.00
Turf Restoration	50000	sf	\$	0.20	\$	10,000.00
Shrub Planting at Parking	63	ea	\$	40.00	\$	2,520.00
Move Shrub / Tree	2	ea	\$	100.00	\$	200.00
Shade Trees	5	ea	\$	550.00	\$	2,750.00

	\$	25,470.00	NWSRA
Totals	\$	496,869.10	\$ 134,602.00
Estimate of Fees and Asbuilt Survey	\$	50,000.00	\$ 13,545.02
Sub total	\$	546,869.10	
Contingency	\$	5,943.92	
Grant Total	\$	552,813.02	
Accounting Audit	\$	2,000.00	
Grant Grand Total Remaining	\$	554,813.02	\$ 148,147.02



EINSTEIN PARK
MT. PROSPECT, IL

CODE: MTP16EIN1
HEALTHBEAT EQUIPMENT
11/2/2016 DRAWN BY: DS

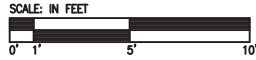

STRUCTURE DIMENSIONS:
ACTUAL SIZE:
AREA REQUIRED:

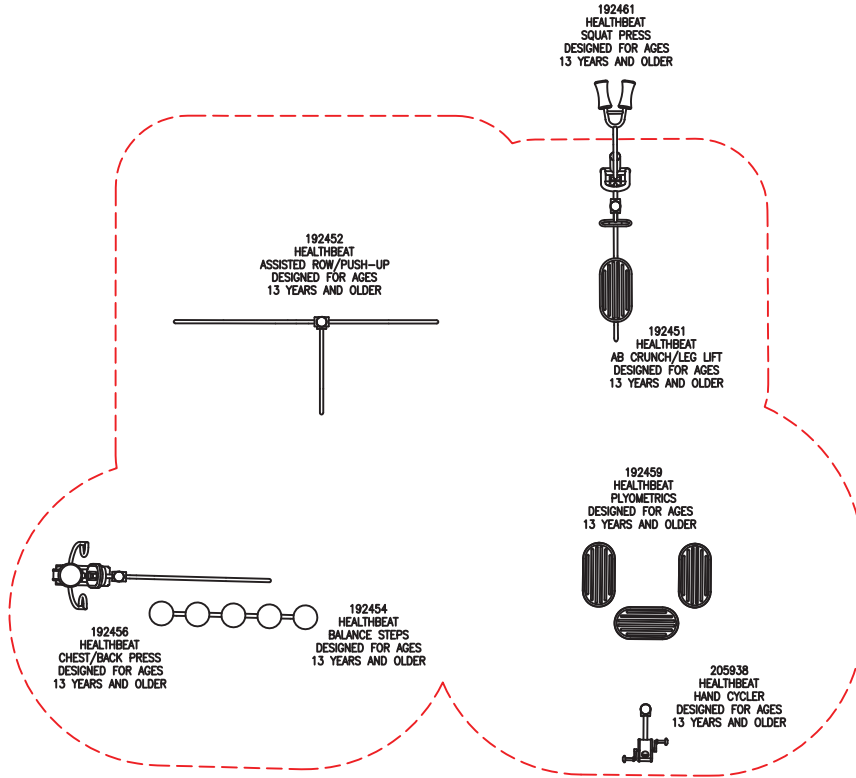

EINSTEIN PARK

MT PROSPECT, IL February 16, 2017 MTP16EIN1-1



**Better playgrounds.
Better world.®**
playlsi.com

Proudly presented by:





model no:

SY111D, SY111P,
SY201D, SY201P

SPYDER SERIES

46" ROUND ADA EXPANDED METAL & PERFORATED TABLES
IN-GROUND, PORTABLE/SURFACE MOUNT



© Wabash Valley Manufacturing, Inc.

customer service:

ASSEMBLERS: If you find any parts missing or damaged, or if you're having difficulty assembling your furniture/equipment, call us at:

* Before calling, have your product model number available.

1-800-253-8619 (Inside U.S.A.)

260-352-2102 (Outside U.S.A.)

Monday thru Friday,
8:00 AM - 4:30 PM Eastern Time
(EXCEPT HOLIDAYS)

Any correspondence concerning our product should be sent directly to our Customer Service Manager at:

Wabash Valley Manufacturing, Inc.
505 E. Main Street
P.O.Box 5
Silver Lake, IN 46982 U.S.A.
FAX: 260-352-2160

maintenance:

Regular inspection and maintenance of all parts, and fasteners is necessary. Tighten all bolts and nuts. Inspect Tops, Seats, Legs, Braces and Fasteners periodically for wear or vandalism. Replace broken or worn parts immediately or take equipment out of service until repairs are made. Use genuine Wabash Valley replacement parts.

To restore plastisol coating to its luster after prolonged use, wash/rinse/dry and use Armor-All ® or similar quality vinyl protectant.

KEEP THIS ASSEMBLY/SPECIFICATION SHEET FOR FUTURE REFERENCE.

specifications:

NOTE: We reserve the right to change specifications without notice.

Heat fused poly-vinyl coating, finished on inner-metal structure, to an approximate 3/16" thickness. Framework assemblies are finished with powder coating; electrostatically applied and oven cured according to powder manufacturer's specifications. Fasteners are stainless steel to resist corrosion.

TOPS

Expanded metal table tops use 3/4 #9, and the perforated is made of 12 gage sheet metal. The perimeter rings on the tops are 1/8" strip steel. Both top's mounting brackets are made of 1/4 flat bar stock. The support braces are made of 1/8" strip steel, the umbrella collar is 14 gage tubing.

SEATS

The concave seats use 3/4 #9 expanded metal and 12 gage sheet metal for the perforated. The perimeter ring on the seats are 1/8" strip steel. The mounting brackets are 1/4 flat bar stock.

TABLE FRAME

The Spyder legs are made of 12 gage x 2 7/8" od tubing. The brace mounting tab is 1/4" thick plate along with seat assembly mounting plate and female screw-in attachment receiver. The 46" Spyder leg uses a 1/4" flat bar for the mounting bracket and the brace mounting tab is 7 gage plate. The surface mount screw-in attachments are made of steel plate 1/4" x 6" with a 5/8 threaded stud. The inground screw-in attachments are 12 gage x 2 7/8" tubing with a 7 gage insert and 5/8 threaded stud. The Spyder cross brace is of 16 gage x 1 1/4" od tubing with a 12 gage x 2 3/8" od center peice. The mounting plate covers are made of 16 gage spun steel. All tubing is galvanized.

GENERAL

Three legged Spyder ADA table ground space requirements are 76 3/8" diameter. It is 29 3/16" to the top of the table and 19 13/16" to the top of the seats.

parts identification:

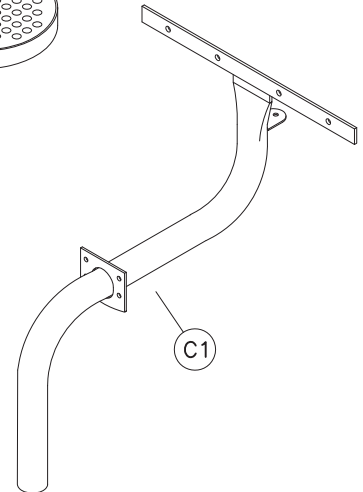
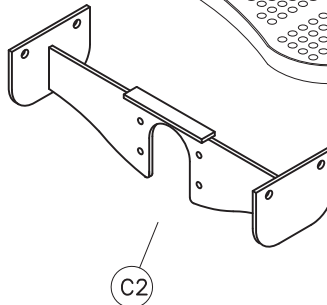
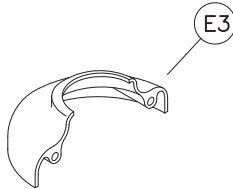
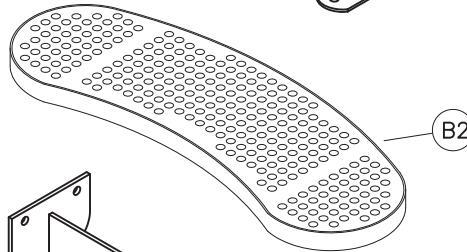
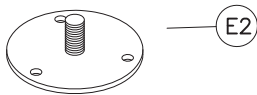
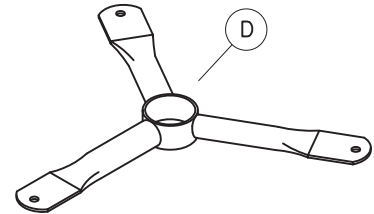
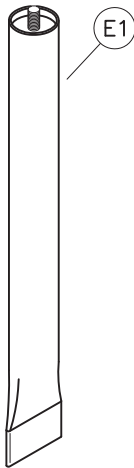
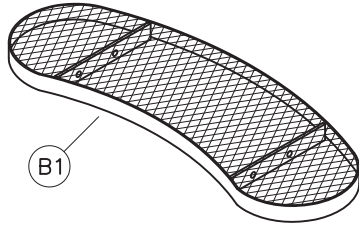
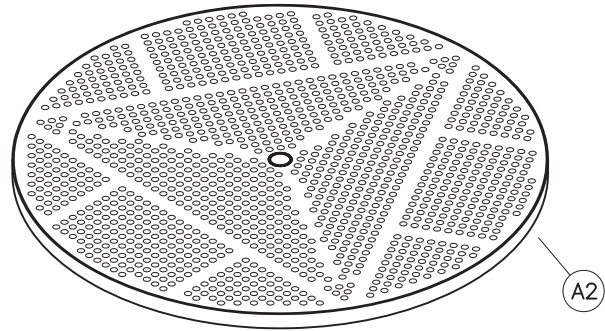
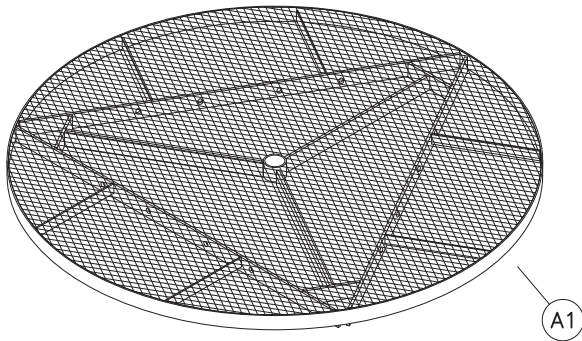

ITEM	PART#	DESCRIPTION	QTY
A1	7816	46" EXPANDED METAL SPYDER TOP	1
A2	7979	46" PERFORATED SPYDER TOP	1
B1	7666	EXPANDED METAL CONCAVE SEAT	3
B2	8000	PERFORATED CONCAVE SEAT	3
C1	7206	46" SPYDER LEG	3
C2	7228	SPYDER LEG SEAT ASSEMBLY	3
D	7258	3 LEGGED SPYDER CROSS BRACE	1
E1	7219	INGROUND SCREW IN ATTACHMENT	3
E2	7256	SURFACE MOUNT SCREW IN ATTACHMENT	3
E3	7121	MOUNTING PLATE COVERS (OPTIONAL)	3

hardware identification:

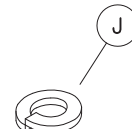
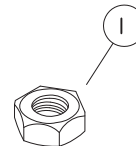
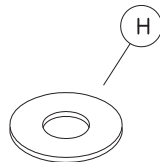
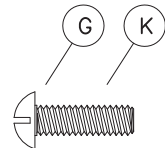
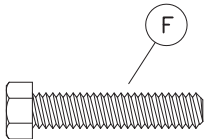

ITEMS INCLUDED IN HARDWARE PACKAGE #:

ITEM	PART#	DESCRIPTION	21088 QTY	21101 QTY
F	17011	5/16-18 x 1 1/2" HEX HEAD BOLT - SS	36	0
G	17088	5/16-18 x 1" TRUSS HEAD MACHINE SCREW - SS	3	0
H	17028	3/8" ID x 7/8" OD WASHER - SS	75	0
I	17032	5/16" HEX FINISH NUT - SS	39	0
J	17050	5/16" SPLIT LOCK WASHER - SS	36	0
K	17052	1/4-20 x 1" MACHINE SCREW - SS	0	2

ASSEMBLY TOOLS REQUIRED

- 1 - REGULAR TIP SCREWDRIVER
- 2 - 1/2" WRENCHES
- 1 - 3' OR 6' LEVEL

assembly procedures: IMPORTANT: Assemblers should be reasonably skilled in the assembly of commercial grade/heavy duty fabricated steel equipment.

To ensure proper assembly, it is suggested that you take adequate time to locate and identify each part. To prevent scratching of the finished pieces, we recommend this unit to be assembled on a clean, flat, solid, surface with a drop cloth, allowing plenty of working room. Also please read the instructions and study the sketches very carefully. A little extra time spent before assembly will be well worth it in performing a complete, proper assembly. Please note that all parts have been pre-cut and pre-drilled.

During the assembly process leave all bolts and nuts "finger tight", until the entire unit is completely assembled. This allows room for movement to level or adjust all seats, tops, benches, framework and braces if necessary. After final adjustment and leveling, permanently tighten all nuts, bolts and fasteners.

76

46" ROUND SPYDER ADA TABLES

FIG. 1

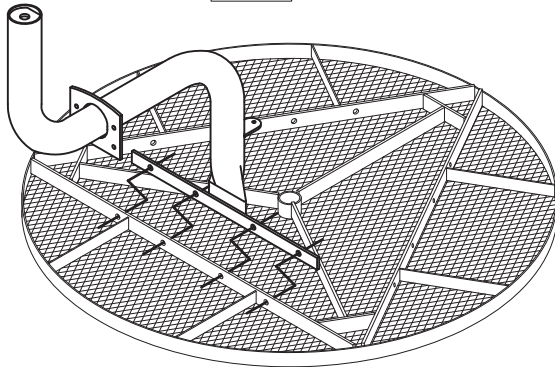

STEP 1: Invert top (A-) and secure Spyder legs (C1) to the inside of the top's mounting brackets using one (F), (I), (J) and two (H) per (F), see FIG. 1.

STEP 2: Attach Spyder cross brace (D) to the inverted top side of the mounting tabs using one (G), one (I), and (H). Attach the screw-in attachments (E1 or E2), see FIG. 2. After all parts have been secured carefully rotate the table to its upright position.

FIG. 2

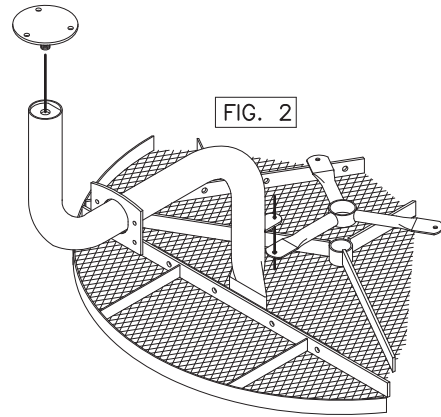

If mounting plate covers (E3) are used, place halves around legs and secure with 2 (K) screws, see FIG. 5. Draw to a snug fit being careful not to over tighten.

FIG. 3

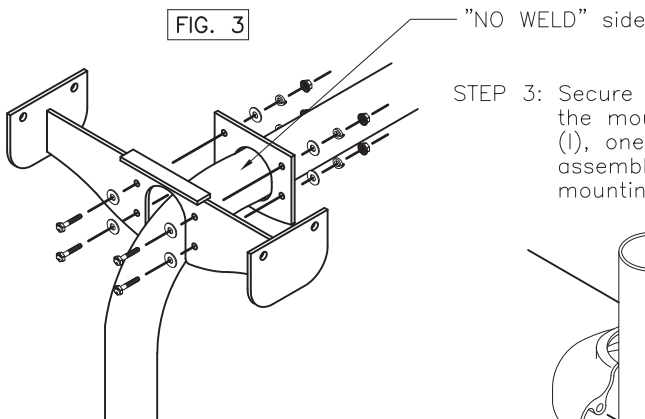

STEP 3: Secure the Spyder leg seat assembly (C2) to the outside of the the mounting bracket on the Spyder leg (C) using one (F), one (I), one (J) and two (H) per (F), see FIG. 3. Be sure seat assembly is assembled to leg with "NO WELD" side against leg mounting plate.

FIG. 5

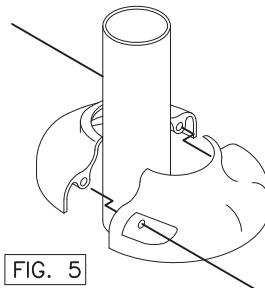

STEP 4: Place the seat (B-) on the Spyder leg seat assembly (C2) so that the seat's mounting brackets are outside the seat assembly's mounting brackets, see FIG. 4. Secure using one (F), (I), (J) and two (H) per (F). Level all seats and top, and tighten with proper wrenches.

FIG. 4

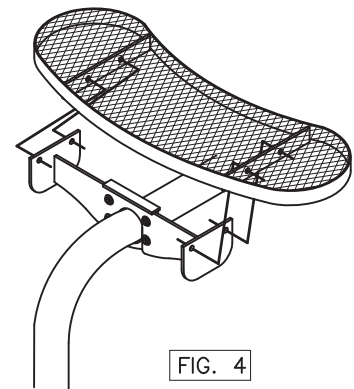

installation: WARNING: The proper installation for Wabash Valley products may depend upon many factors unique to the site, location, or use of a particular product. Consult with your contractor or other professional to determine your specific installation requirements.

product dimensions:

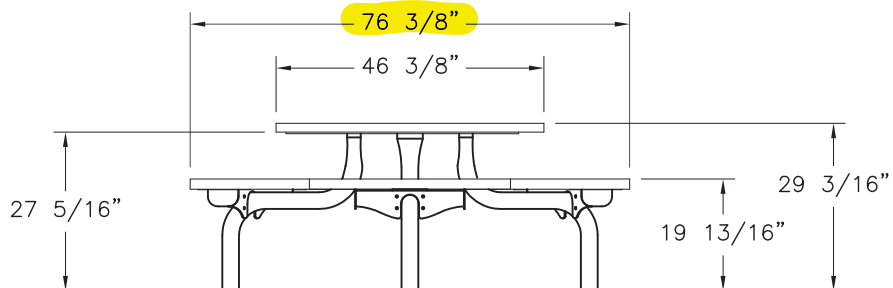
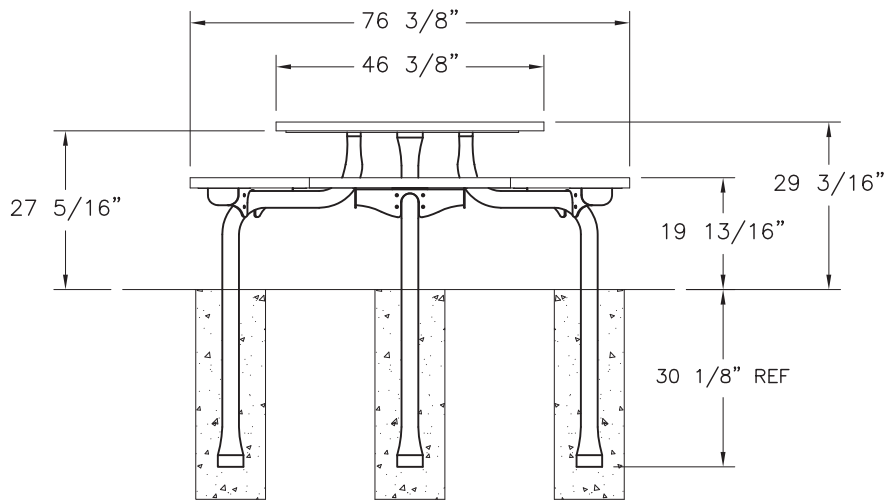
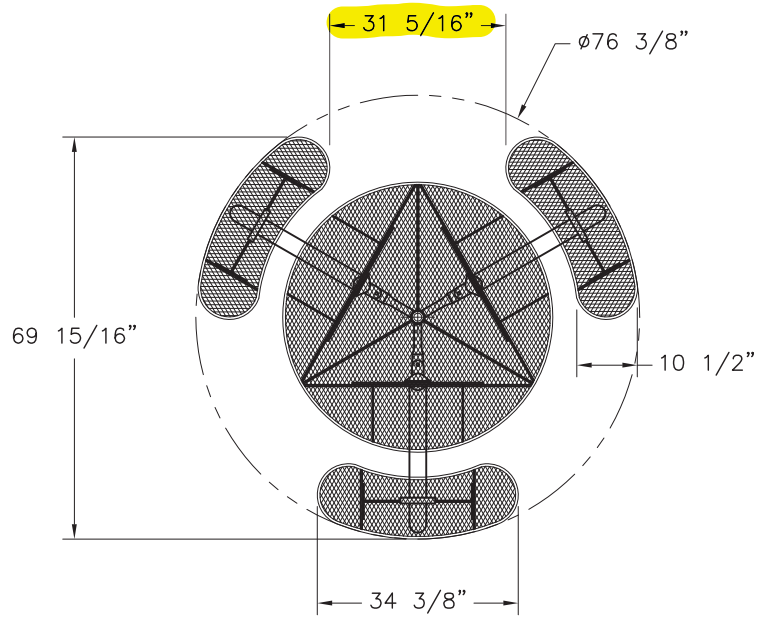



EINSTEIN PARK RENOVATION

OSLAD GRANT SUBMITTAL REVISED CONCEPT

- Rebuild storm sewer
- 33 + 2 HC parking spaces rebuild, with 5' strip permeable pavers
- Relocated ball field
 - 60' Bases
 - 240' Outfield
 - Accessible, covered player benches
- Workout cluster
- Knock down bollards
- Bench, typ.
- New paths throughout (6'-8' wide)



- New sign location
- (2) 1/2 Court Basketball courts
- Berm
- Clear and re-fence power service
- New science playground, Einstein themed, 7,000 SF
- Regrade and add bioswale
- Plaza with seating
- Drinking fountain
- Refurbish shelter
- Knock down bollards
- Picnic lawn
- Regrade and add bioswale
- Catch basin and drainage, 120' 6" pipe
- Regrade and add bioswale

EINSTEIN PARK REDEVELOPMENT

DES PLAINES, ILLINOIS

Owner
MT. PROSPECT PARK DISTRICT
 1000 W. Central Road
 Mount Prospect, IL 60056
 (847) 255-5390

Landscape Architect
RATIO Architects, Inc.
 30 West Monroe
 Suite 500
 Chicago, IL 60603
 (312) 465-5390

Civil Engineer
K Plus Engineering
 15 Spinning Wheel Road
 Suite 320
 Hinsdale, IL 60521
 (630) 570-5545

Construction Drawing
 03/09/2017

SHEET ISSUE

REISSUE

NO. DESCRIPTION DATE

NO. DESCRIPTION DATE

NO. DESCRIPTION DATE

NO. DESCRIPTION DATE

NO. DESCRIPTION DATE

NO. DESCRIPTION DATE

NO. DESCRIPTION DATE

NO. DESCRIPTION DATE

NO. DESCRIPTION DATE

NO. DESCRIPTION DATE

NO. DESCRIPTION DATE

NO. DESCRIPTION DATE

NO. DESCRIPTION DATE

NO. DESCRIPTION DATE

NO. DESCRIPTION DATE

NO. DESCRIPTION DATE

NO. DESCRIPTION DATE

NO. DESCRIPTION DATE

NO. DESCRIPTION DATE

NO. DESCRIPTION DATE

NO. DESCRIPTION DATE

NO. DESCRIPTION DATE

NO. DESCRIPTION DATE

NO. DESCRIPTION DATE

NO. DESCRIPTION DATE

NO. DESCRIPTION DATE

NO. DESCRIPTION DATE

NO. DESCRIPTION DATE

NO. DESCRIPTION DATE

NO. DESCRIPTION DATE

NO. DESCRIPTION DATE

NO. DESCRIPTION DATE

NO. DESCRIPTION DATE

NO. DESCRIPTION DATE

NO. DESCRIPTION DATE

NO. DESCRIPTION DATE

NO. DESCRIPTION DATE

NO. DESCRIPTION DATE

NO. DESCRIPTION DATE

NO. DESCRIPTION DATE

NO. DESCRIPTION DATE

NO. DESCRIPTION DATE

NO. DESCRIPTION DATE

NO. DESCRIPTION DATE

NO. DESCRIPTION DATE

NO. DESCRIPTION DATE

NO. DESCRIPTION DATE

NO. DESCRIPTION DATE

NO. DESCRIPTION DATE

NO. DESCRIPTION DATE

NO. DESCRIPTION DATE

NO. DESCRIPTION DATE

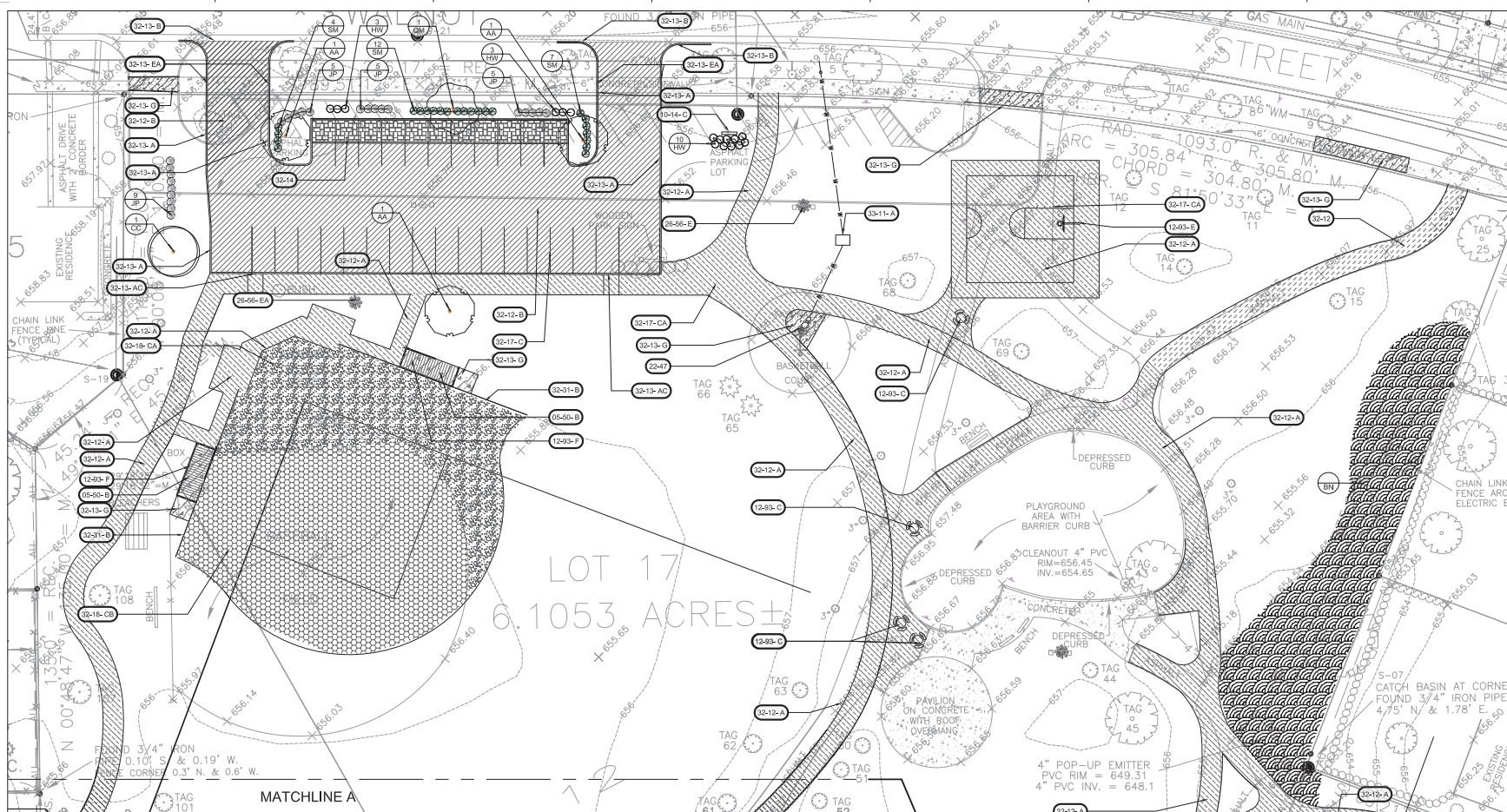

PLANTING NOTES

1. REFER TO GENERAL LANDSCAPE ARCHITECTURAL NOTES, SHEET G-001, PRIOR TO COMMENCING THE PLANTING SCOPE OF WORK.
2. MATCH LAYOUT OF PLANTING SHOWN GRAPHICALLY IN PLAN UNLESS OTHERWISE NOTED/DIMENSIONED OTHERWISE.
3. EXISTING AND PROPOSED UTILITIES SHOWN ARE FOR REFERENCE ONLY. REFER TO THE SITE SURVEY FOR EXISTING UTILITIES AND VERIFY IN FIELD.
4. INSTALL SPECIFIED GENERAL TOPSOIL, LAWN SEED, AND SLANIKET AT ALL AREAS DISTURBED BY CONSTRUCTION ACTIVITIES AND NOT OTHERWISE IDENTIFIED ON PLANS.
5. SEE SHEET 705 FOR TREE PLANTING DETAIL.

SITE FEATURES NOTES

1. REFER TO GENERAL LANDSCAPE ARCHITECTURAL NOTES, SHEET G-001, PRIOR TO COMMENCING THE PLANTING SCOPE OF WORK.
2. SEE SCHEDULE ON SHEET L-202
3. EXISTING AND PROPOSED UTILITIES SHOWN ARE FOR REFERENCE ONLY. REFER TO THE SITE SURVEY FOR EXISTING UTILITIES AND VERIFY IN FIELD.

TREES	BOTANICAL NAME / COMMON NAME	CONT	QTY
AA	Acer x freemirum 'Jefferson' / Autumn Blaze Maple	3" Cal.	3
CC	Celtis occidentalis 'Chicagoland' / Common Hackberry	3" Cal.	1
HW	Hydrangea quercifolia 'Pee Wee' / Oakleaf Hydrangea	24"	16
JP	Juniperus chinensis 'Kallays Compact' / Kallay Compact Pfitzer Juniper	18"	24
DM	Quercus macrocarpa / Burr Oak	3" Cal.	1
SM	Scirpus alba / Meadowweet	18"	23
LOW GROUND COVERS	BOTANICAL NAME / COMMON NAME	CONT	QTY
BN	Blossvale Mix Number 1 / Blossvale Mix	Seed	15,962 sf

SITE FEATURES PLAN
 1"=20'-0"

SITE FEATURES and PLANTING PLAN

SHEET NUMBER
L-201

C:\Users\jason.lee\AppData\Local\Temp\AutoCAD\2017\171717.dwg (Last Saved: 3/9/2017 10:52:28 AM)
 AutoCAD 2017
 User: jason.lee
 Date: 3/9/2017 10:52:28 AM

EINSTEIN PARK REDEVELOPMENT

DES PLAINES, ILLINOIS

Owner
MT. PROSPECT PARK DISTRICT
 1000 W. Central Road
 Mount Prospect, IL 60056
 (847) 255-5390

Landscape Architect
RATIO Architects, Inc.
 30 West Monroe
 Suite 500
 Chicago, IL 60603
 (312) 465-2399

Civil Engineer
K Plus Engineering
 15 Spinning Wheel Road
 Suite 320
 Hinsdale, IL 60521
 (630) 570-5545

Construction Drawing
 03/09/2017

SHEET ISSUE

REISSUE

NO. DESCRIPTION DATE

1

2

3

4

5

6

7

8

9

10

11

12

13

14

15

16

17

18

19

20

21

22

23

24

25

26

27

28

29

30

31

32

33

34

35

36

37

38

39

40

41

42

43

44

45

46

47

48

49

50

51

52

53

54

55

56

57

58

59

60

61

62

63

64

65

66

67

68

69

70

71

72

73

74

75

76

77

78

79

80

81

82

83

84

85

86

87

88

89

90

91

92

93

94

95

96

97

98

99

100

101

102

103

104

105

106

107

108

109

110

111

112

113

114

115

116

117

118

119

120

121

122

123

124

125

126

127

128

129

130

131

132

133

134

135

136

137

138

139

140

141

142

143

144

145

146

147

148

149

150

151

152

153

154

155

156

157

158

159

160

161

162

163

164

165

166

167

168

169

170

171

172

173

174

175

176

177

178

179

180

181

182

183

184

185

186

187

188

189

190

191

192

193

194

195

196

197

198

199

200

201

202

203

204

205

206

207

208

209

210

211

212

213

214

215

216

217

218

219

220

221

222

223

224

225

226

227

228

229

230

231

232

233

234

235

236

237

238

239

240

241

242

243

244

245

246

247

248

249

250

251

252

253

254

255

256

257

258

259

260

261

262

263

264

265

266

267

268

269

270

271

272

273

274

275

276

277

278

279

280

281

282

283

284

285

286</

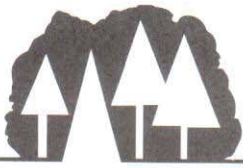

Mt. Prospect Park District

Serving Portions of Mt. Prospect • Des Plaines • Arlington Heights • Elk Grove Village

www.mppd.org

ADMINISTRATIVE OFFICES

(847)255-5380

Fax (847)255-1438

1000 W. Central Road

Mt. Prospect, IL 60056

CENTRAL COMMUNITY CENTER

(847)255-5380

Fax (847)392-5726

1000 W. Central Road

Mt. Prospect, IL 60056

RECPEX

(847)640-1000

Fax (847)364-2824

420 W. Dempster Street

Mt. Prospect, IL 60056

LIONS RECREATION CENTER

(847)632-9333

Fax (847)632-9325

411 S. Maple Street

Mt. Prospect, IL 60056

FRIENDSHIP PARK CONSERVATORY

(847)298-3500

Fax (847)296-2053

395 Algonquin Road

Des Plaines, IL 60018

MT. PROSPECT GOLF CLUB

(847)259-4200

Fax (847)632-9334

600 See-Gwun

Mt. Prospect, IL 60056

GOLF MAINTENANCE

(847)632-9330

Fax (847)342-9113

600 See-Gwun

Mt. Prospect, IL 60056

MAINTENANCE FACILITY

(847)956-6773

Fax (847)956-6911

1645 Carboy

Mt. Prospect, IL 60056

March 9, 2017

Tracy Crawford
Executive Director
Northwest Special Recreation Association
3000 Central Road – Suite 205
Rolling Meadows, IL 60008

Re: ADA Improvements – Lions Memorial Bandshell Paving Project **(Revised)**

Ms. Crawford,

The Mt. Prospect Park District hereby notifies and requests approval of the NWSRA Board of Directors for the proposed expenditures of funds from the Park District's Special Recreation levy to pay for the following improvements:

Reimbursement for ADA related improvements to include new ADA accessible routes of travel for our public event structure at Lions Memorial Park. The proposed improvements will provide compliant paths of travel for public assemblies and entertainment events at our Lions Memorial Bandshell located at 411 S Maple Street in Mount Prospect.

The total estimated base bid construction costs are \$74,082.50.

The total identified ADA related costs associated with this product are **\$19,298.00**.

Please see the attached supporting documents from K-Plus Engineering for itemized details and costs for the proposed accessibility upgrades.

The Mt. Prospect Park District respectfully requests that you review this proposal and present it with your approving recommendation to the NWSRA Board of Directors.

Sincerely,

Jim Jarog
Director of Parks & Planning
Mt. Prospect Park District

CC: Greg Kuhs
Executive Director
Mt. Prospect Park District



Direct Dial: 312.207.1600
E-Mail: mlattner@kplus.com
K-Plus Project: 27015

March 10, 2017

Jim Jarog
Director of Parks and Planning
1000 W Central Road
Mount Prospect, IL 60056

Re: ADA Cost for MPPD Lions Park Bandshell Brick Paver Maintenance Project

Dear Mr. Jarog:

The Lions Park Bandshell Brick Paver Maintenance Project scope of work includes the removal and replacement of path pavement, and new ADA compliant sidewalk. The improvements aid in the site complying with the current American with disability Act (ADA). List below are the improvements at the site that are related to ADA compliance.

- Brick Paver Removal and New Brick Pavers and Replacement of Subbase
 - This project provides a smooth surface free of any trip hazards or of any settled areas where water can pond and cause slick conditions. Replacing of the subbase will also allow the contractor to regrade the walk area to have less than 2% slope. Only 5 ft. of the original paver area was considered in the cost estimate based on minimum 5 ft. width requirement for an area to be considered accessible.
- Engineering Fees
 - A portion of the engineering fees are for the design and construction services for the ADA compliance of the improvements. The total engineering fees for the project is \$6,690.00. Base on the percent (23.9%) of the project construction cost for the improvements at the site that are related to ADA compliance the engineering fees for the ADA potion is \$1598.00.

Based on the engineer's estimated unit price, an ADA cost estimate for these improvements has been developed. Attached is the spreadsheets showing the quantities associated with ADA compliance for the project. The cost for the ADA related items is \$17,700.00 for base bid and \$1598.00 for engineering fees. The grand total ADA cost for the Lions Park Bandshell Brick Paver Maintenance Project is \$19,298.00

If you have any questions regarding this letter, please feel free to contact me at 312.207.1600.

Sincerely,
K-PLUS ENGINEERING

A handwritten signature in black ink that reads 'Mark Lattner'.

Mark Lattner, P.E.



K-PLUS ENGINEERING

Date Prepared: 3/9/2017

K-plus#: 27015

Prepared By: MM

Reviewed By: ML

MPPD: LIONS PARK MEMORIAL BANDSHELL BRICK PAVER MAINTENANCE PROJECT

ENGINEER'S ESTIMATE						ADA Project Portion	
ITEM NUMBER	PAY ITEM	UNIT	TOTAL QUANTITY	UNIT COST	TOTAL COST	ADA QUANTITY	ADA COST
1	CONSTRUCTION FENCE	FOOT	350	\$3.00	\$1,050.00	0	\$0.00
2	SEEDING, SPECIAL	SQ YD	2,025	\$3.50	\$7,087.50	0	\$0.00
3	BRICK PAVERS	SQ FT	5,485	\$4.00	\$21,940.00	1,770	\$7,080.00
4	BRICK REMOVAL	SQ FT	5,485	\$2.00	\$10,970.00	0	\$0.00
5	AGGREGATE BASE COURSE, CA-6	SQ FT	5,485	\$6.00	\$32,910.00	1,770	\$10,620.00
6	VILLAGE PERMIT	EACH	1	\$125.00	\$125.00	0	\$0.00
Construction Cost Subtotal					\$74,082.50		\$17,700.00
Engineering Fees				Engineering Fees Subtotal	\$6,690.00		\$1,598.00
TOTAL PROJECT COST					\$80,772.50		\$19,298.00

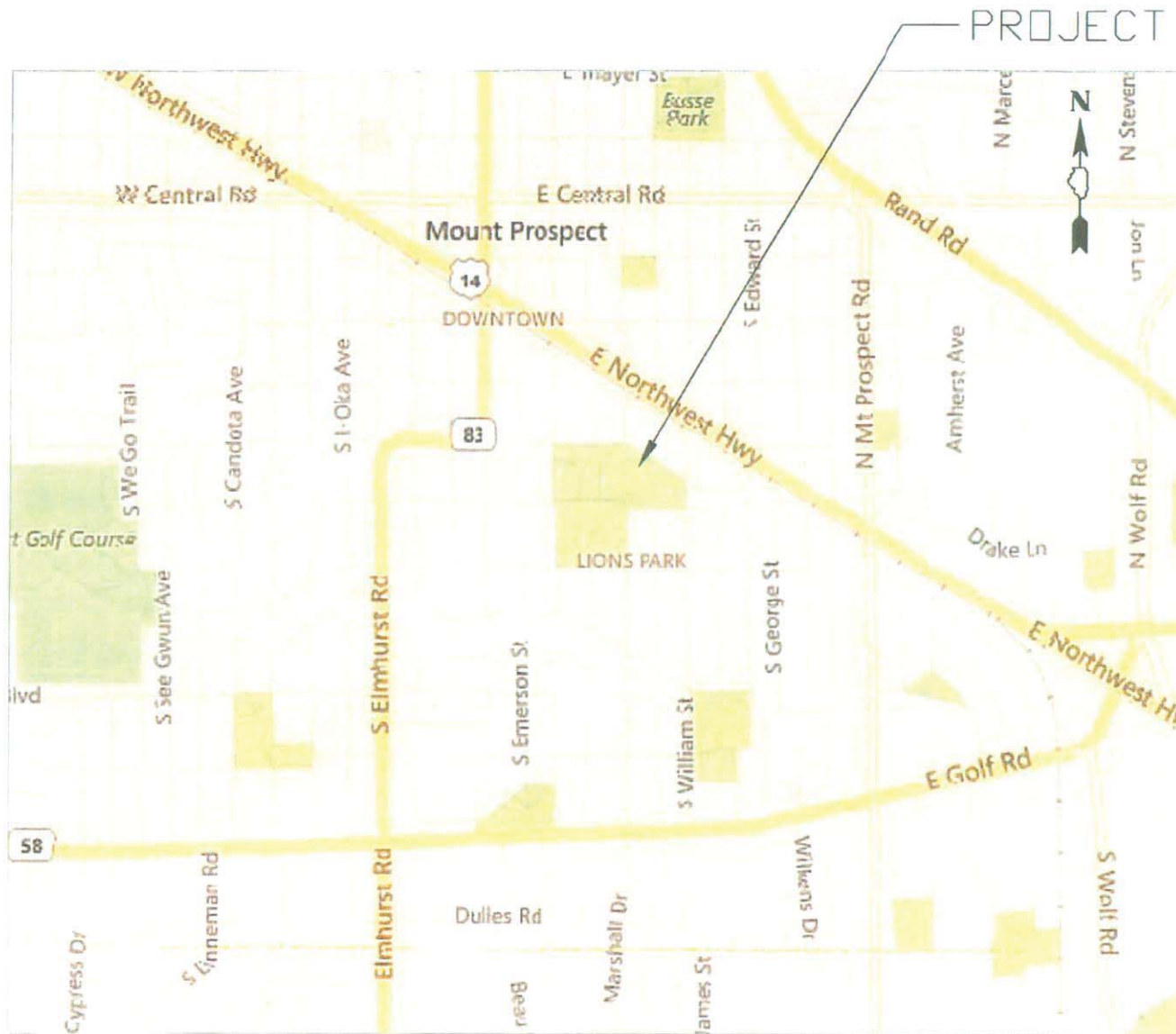

PROJECT LOCATION

Mt. Prospect Park District

LIONS PARK

DATE: 03/08/2017 SHEET: 1 of 8 K-PLUS: 27015

K-PLUS ENGINEERING

 www.kplus.com
312.207.1600

REMOVAL PLAN

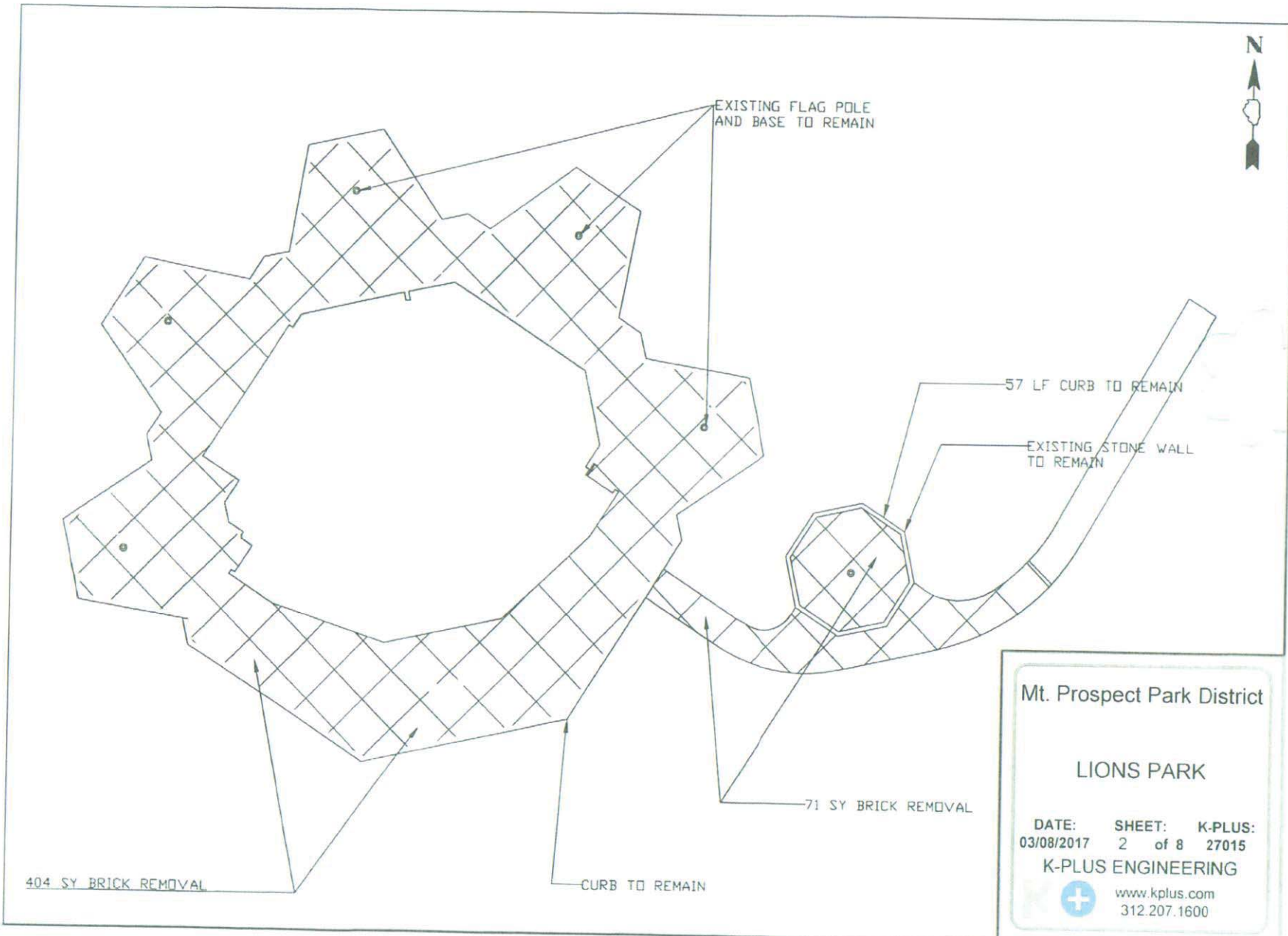

Mt. Prospect Park District

LIONS PARK

DATE: 03/08/2017 SHEET: 2 of 8 K-PLUS: 27015

K-PLUS ENGINEERING

 www.kplus.com
312.207.1600

F:\CUSTOMERS\Mt. PROSPECT PARK DISTRICT\PROJECTS\27015 - LION'S BANDSHELL\DWG\EXHIBITS.DWG

PROPOSED PLAN

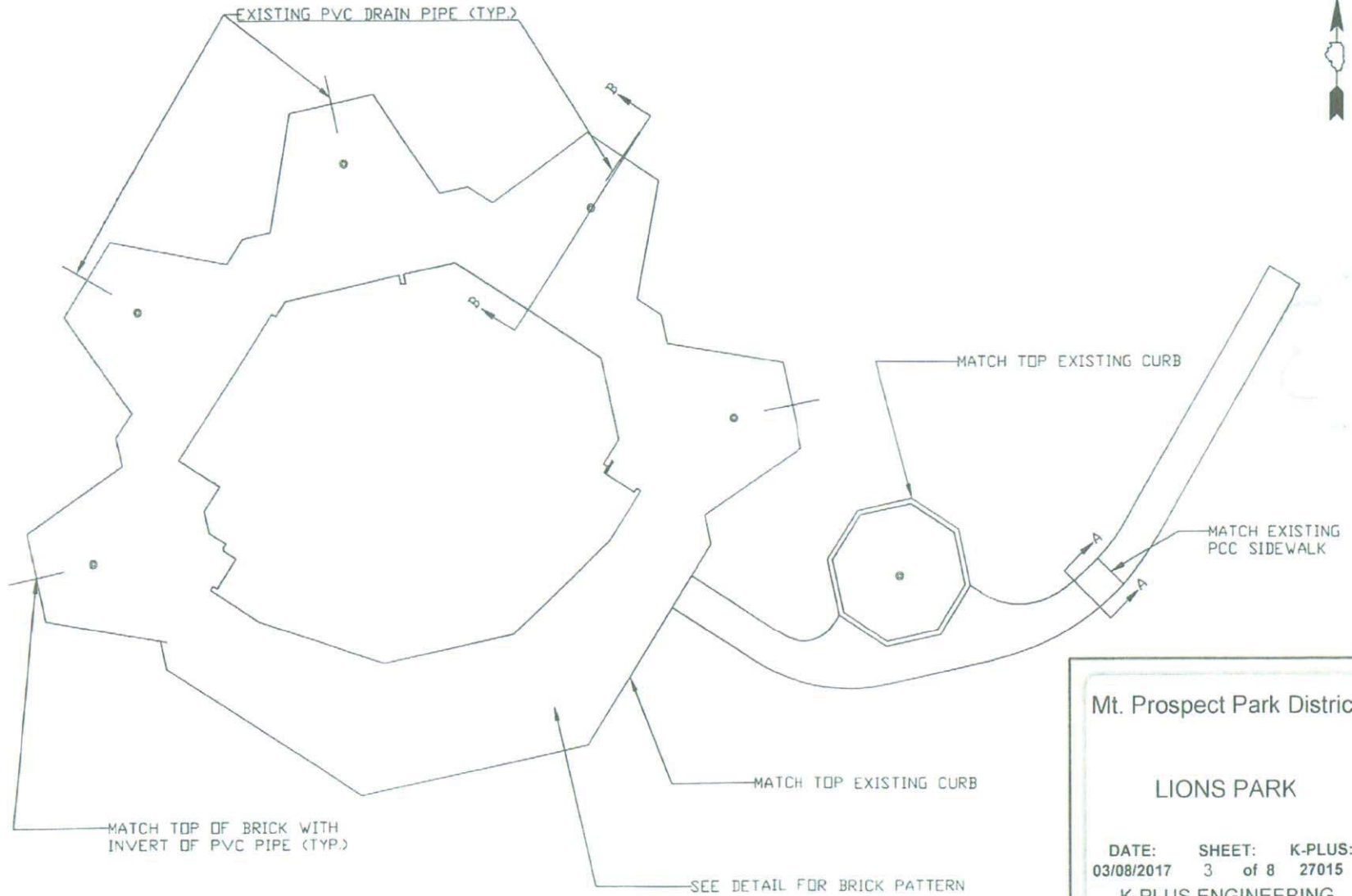

Mt. Prospect Park District

LIONS PARK

DATE: 03/08/2017 SHEET: 3 of 8 K-PLUS: 27015

K-PLUS ENGINEERING



www.kplus.com
312.207.1600

CONSTRUCTION DETAILS

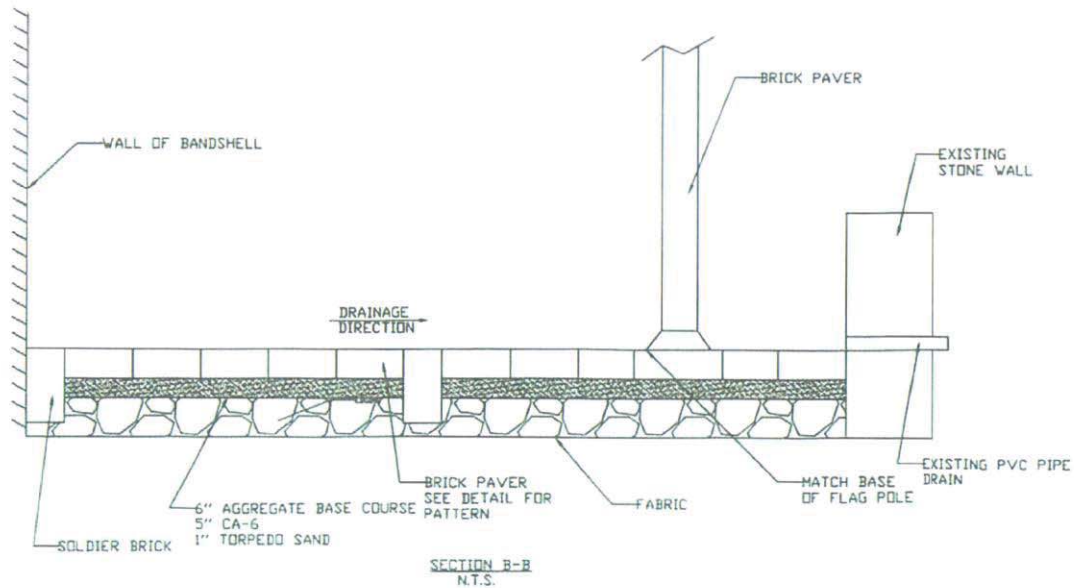
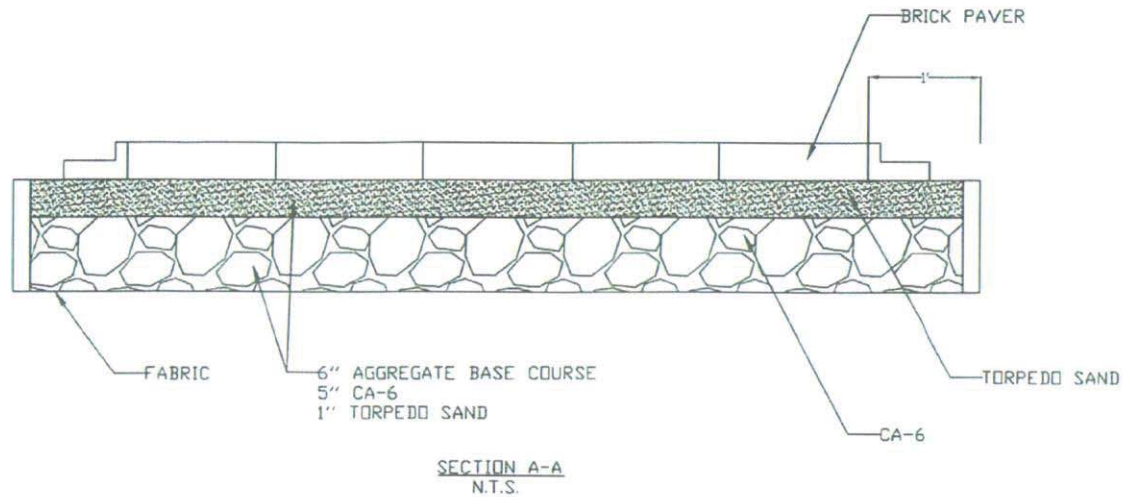

Mt. Prospect Park District

LIONS PARK

DATE: 03/08/2017 SHEET: 4 of 8 K-PLUS: 27015

K-PLUS ENGINEERING



www.kplus.com
312.207.1600

F:\CUSTOMERS\Mt. PROSPECT PARK DISTRICT\PROJECTS\27015 - LION'S BANDSHELL.DWG\EXHIBITS.DWG

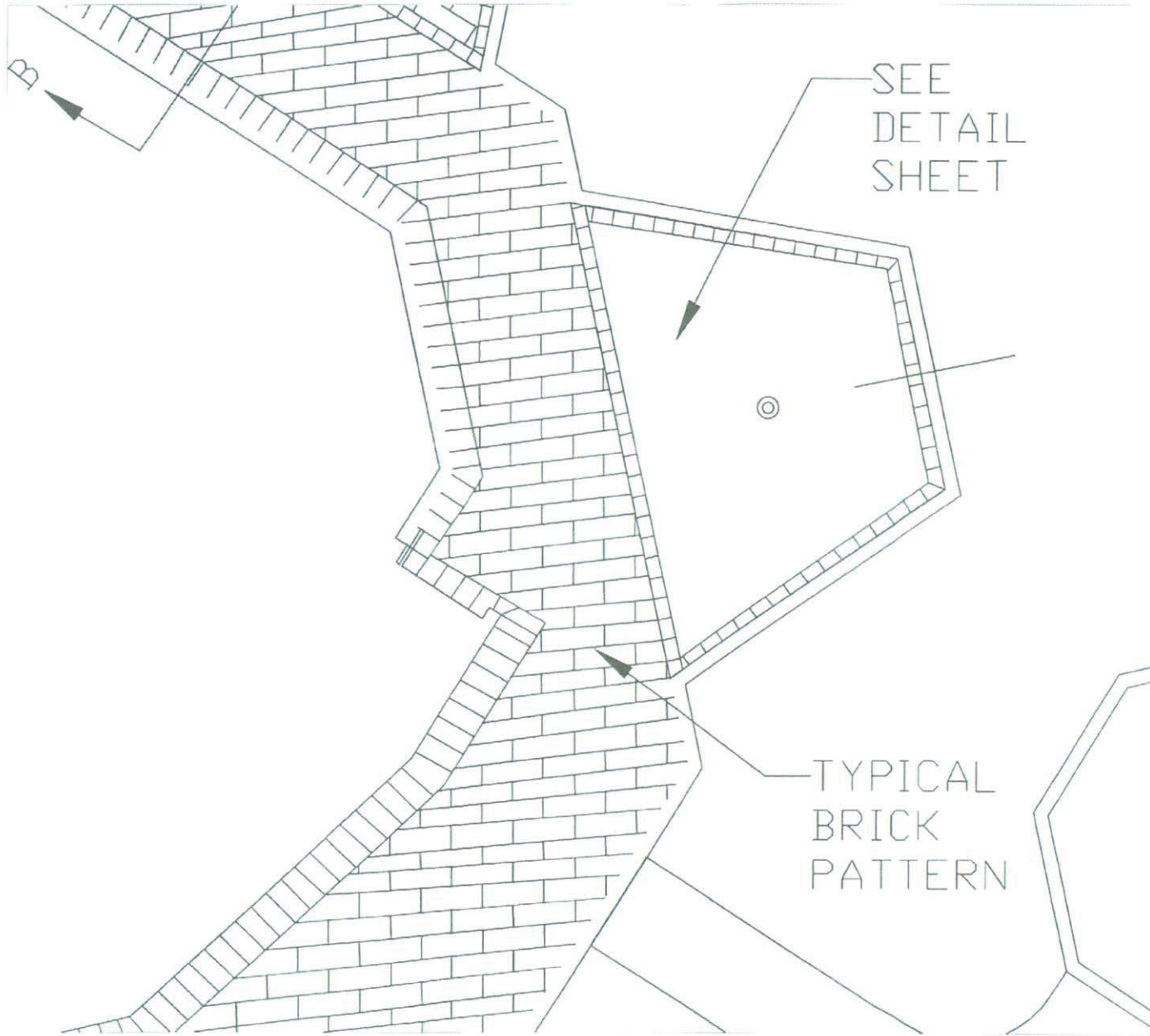

BRICK PATTERN

Mt. Prospect Park District

LIONS PARK

DATE: 03/08/2017 SHEET: 5 of 8 K-PLUS: 27015

K-PLUS ENGINEERING

 www.kplus.com
312.207.1600

EDGES TO
REMAIN
THE SAME

NEW
BRICK
PATTERN

BRICK PATTERN IN FLAG AREA

Mt. Prospect Park District

LIONS PARK

DATE: 03/08/2017 SHEET: 6 of 8 K-PLUS: 27015

K-PLUS ENGINEERING



www.kplus.com
312.207.1600

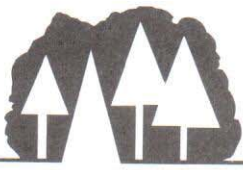

Mt. Prospect Park District

Serving Portions of Mt. Prospect • Des Plaines • Arlington Heights • Elk Grove Village

www.mppd.org

ADMINISTRATIVE OFFICES

(847)255-5380

Fax (847)255-1438

1000 W. Central Road

Mt. Prospect, IL 60056

CENTRAL COMMUNITY CENTER

(847)255-5380

Fax (847)392-5726

1000 W. Central Road

Mt. Prospect, IL 60056

RECPLX

(847)640-1000

Fax (847)364-2824

420 W. Dempster Street

Mt. Prospect, IL 60056

LIONS RECREATION CENTER

(847)632-9333

Fax (847)632-9325

411 S. Maple Street

Mt. Prospect, IL 60056

FRIENDSHIP PARK CONSERVATORY

(847)298-3500

Fax (847)296-2053

395 Algonquin Road

Des Plaines, IL 60018

MT. PROSPECT GOLF CLUB

(847)259-4200

Fax (847)632-9334

600 See-Gwun

Mt. Prospect, IL 60056

GOLF MAINTENANCE

(847)632-9330

Fax (847)342-9113

600 See-Gwun

Mt. Prospect, IL 60056

MAINTENANCE FACILITY

(847)956-6773

Fax (847)956-6911

1645 Carboy

Mt. Prospect, IL 60056

March 10, 2017

Tracy Crawford

Executive Director

Northwest Special Recreation Association

3000 Central Road – Suite 205

Rolling Meadows, IL 60008

Re: ADA Improvements – Friendship Park Conservatory ADA Accessible Entryways

Ms. Crawford,

The Mt. Prospect Park District hereby notifies and requests approval of the NWSRA Board of Directors for the proposed expenditures of funds from the Park District's Special Recreation levy to pay for the following improvements:

Reimbursement for ADA related improvements to include new ADA accessible routes of travel and entry to our Friendship Park Conservatory. The proposed improvements will provide compliant paths of travel and ADA accessible entry door assemblies and operators for access to our Friendship Conservatory facility and courtyard areas.

The total construction and Engineering cost for this project is \$61,130.26.

The total identified **ADA** related costs associated with this product are **\$61,130.26**.

Please see the attached supporting documents from Groundwork Architects for itemized details and costs for the proposed accessibility upgrades.

The Mt. Prospect Park District respectfully requests that you review this proposal and present it with your approving recommendation to the NWSRA Board of Directors.

Sincerely,

Jim Jarog

Director of Parks & Planning

Mt. Prospect Park District

CC: Greg Kuhs
Executive Director
Mt. Prospect Park District

MEMORANDUM

To: Jim Jarog - Mt. Prospect Park District
From: David Wytmar, AIA, LEED AP
Date: March 10, 2017
RE: Budget Estimate
Recommended Accessibility Improvements
Friendship Park Conservatory, Mt. Prospect Park District, Des Plaines, IL
Job #: AB01

Pursuant to your direction, Groundwork has reviewed various doors for conformance to building and accessibility codes at the existing Friendship Park Conservatory.

Main Entry Vestibule

There are two sets of double swing doors at the vestibule to the main entry of the facility. These existing doors are taller than standard doors, and due to their size and age, do not meet the door opening force requirements of current ADA standards. Additionally, the size of the vestibule is narrow and the two sets of doors in series do not meet the door clearance requirements, compromising maneuverability at these doors.

Recommendation: Replace the swinging doors with automatically operated sliding doors that are shorter, and have a transom above. Because the sliding doors will have sensors that automatically open the door as a person approaches, the accessibility is improved beyond minimum code requirements, and provides a true barrier-free accessible route.

Doors to Interior Courtyard

There is a single set of double swing doors at the vestibule to the main entry of the facility. These existing doors are taller than standard doors, and due to their size and age, do not meet the door opening force requirements of current ADA standards.

Recommendation: Remove and replace the existing full height swinging doors with a new set of shorter doors with a button activated, power-assisted opener. Due to its location and surrounding uses, a sliding door is not appropriate in this application, and the power assisted door facilitates accessibility for all users beyond code minimums.

Additionally, per your direction, Groundwork has prepared a budget estimate for providing the recommended accessibility improvements at Friendship Park Conservatory. This budget estimate is based on initial contractor estimates and appropriate management fees. The budget estimate is provided solely for general information purposes, and actual project costs will be available at the completion of the project.

end

GROUNDWORK, LTD.
ARCHITECTS / PLANNERS / ENGINEERS
351 WEST DUNDEE ROAD, SUITE A
BUFFALO GROVE, ILLINOIS 60089
847-541-4151 - FAX 847-541-4066
www.groundworkitd.com
gworkitd@sbcglobal.net



Accessibility Improvements

Friendship Park Conservatory - Mt. Prospect Park District

Budget Estimate

Description	Base Cost	Costs Attributable to Accessibility Improvements
<u>Sliding Doors at Main Entry Vestibule</u>		
Budget cost of sliding doors, operators (based on Stanley estimate of 3/10/17).	\$17,650.00	\$17,650.00
Budget cost of storefront modifications, including new transoms above doors (based on Dymond Glazing estimate of 3/10/17).	\$6,845.00	\$6,845.00
Budget cost of concrete modifications, including new concrete at threshold, new stoop, and frost walls.	\$2,000.00	\$2,000.00
Flooring modifications at vestibule where new door tracks and thresholds are provided.	\$2,500.00	\$2,500.00
Electrical connections to door operators (provided by Mt. Prospect Park District).	No Charge	No Charge
<u>Power Assisted Doors at Courtyard</u>		
Budget cost of removal of existing doors, and providing new doors and transom (based on Dymond Glazing estimate of 3/10/17).	\$10,324.00	\$10,324.00
Budget cost of power assisted door mechanism and controls (based on Stanley estimate of 3/10/17).	\$2,365.00	\$2,365.00
Electrical connections to door operators (provided by Mt. Prospect Park District).	No Charge	No Charge
Construction Sub-Total:		\$41,684.00
<u>Project Management Costs</u>		
Contingency	10% \$4,168.40	\$4,168.40
General Contractor Fee, OH &P	15% \$6,877.86	\$6,877.86
<u>Professional Services</u>		
Review of accessibility elements related to proposed work, and preparation of Contract Documents, Bid Assistance and Construction Administration. (Groundwork Agreement of 2/7/17)	\$8,400.00	\$8,400.00
Total Cost for Accessibility Improvements:		\$61,130.26

Note: Amounts shown are an initial budget estimate based on preliminary contractor estimates of work, and are provided as a general reference only. Actual project costs will be provided will be furnished at completion.

ACCESSIBILITY IMPROVEMENT FRIENDSHIP PARK CONSERVATORY

MT. PROSPECT PARK DISTRICT
MARCH 10, 2017

DOORS TO INTERIOR COURTYARD

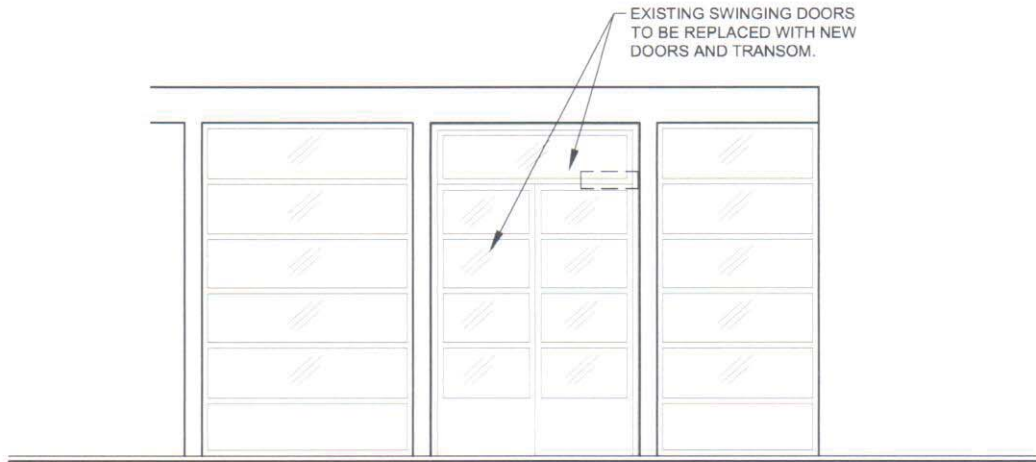

ELEVATION

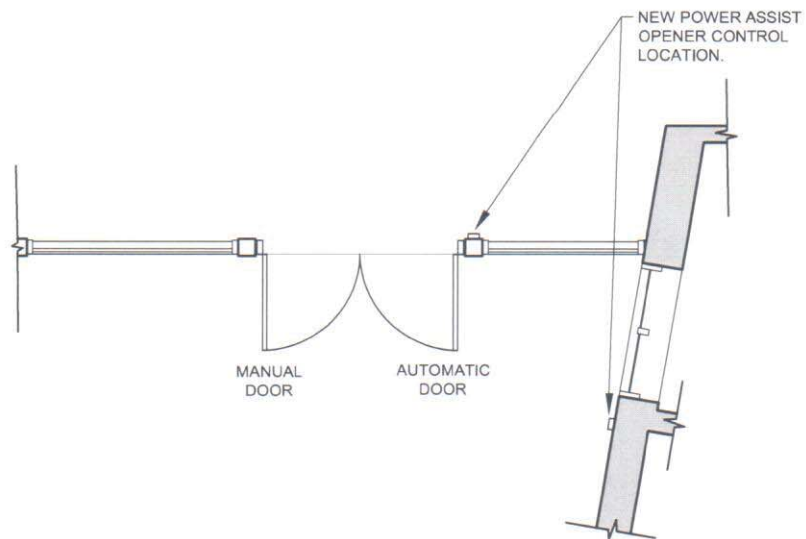

PLAN

ACCESSIBILITY IMPROVEMENT FRIENDSHIP PARK CONSERVATORY

MT. PROSPECT PARK DISTRICT
MARCH 10, 2017

MAIN ENTRY

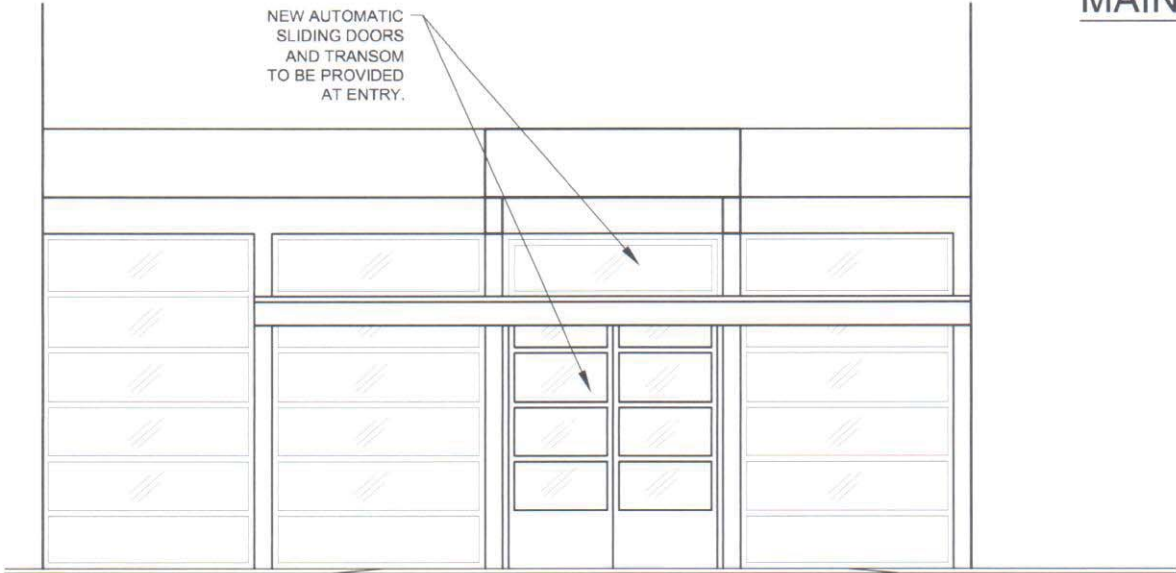

ELEVATION

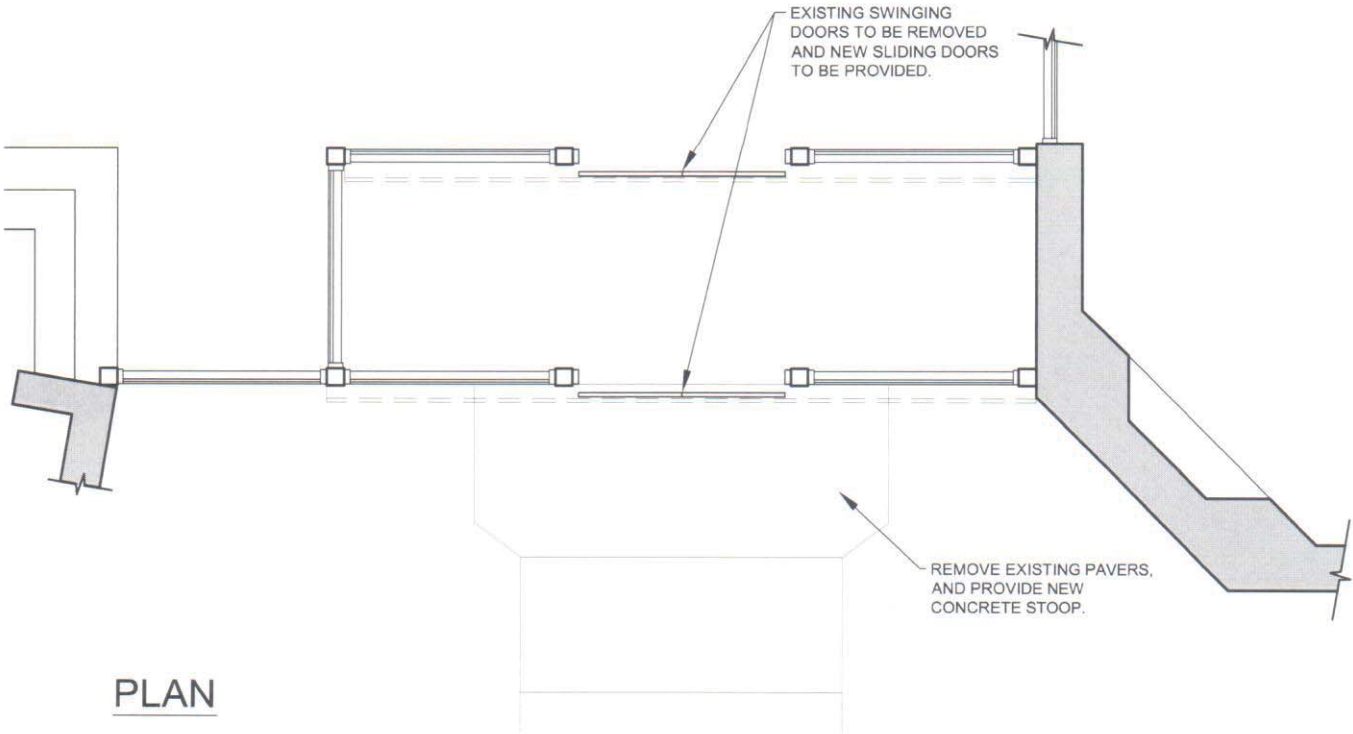

PLAN